



Electrolux

EMPower 2 Drawer Refrigerated Chef Base 48"

ITEM #

MODEL #

NAME #

SIS #

AIA #



169207 (COMPCHEF48)

2 Drawer Refrigerated Chef
Base 48"

Short Form Specification

Item No.

Unit to be Electrolux Two (2) Drawer Refrigerated Chef Base with built-in compressor unit. Unit able to operate with temperature range from 32° F to 41° F (+0°C to +5°C). Digital thermostat and display are protected by the Stainless Steel front panel. Stainless Steel front panel with incorporated Stainless Steel wire grate is easy to remove for access to the thermostat and to allow for easy cleaning. Used as base below any top unit installed on feet. Freestanding installation: does not allow flush connection between base and Electrolux top units nor between any side units. Delivered on casters.



APPROVAL:

Main Features

- Digital thermostat and display are protected by the Stainless Steel front panel.
- Heavy duty Stainless Steel tubular drawer handles.
- Two (2) Drawer Refrigerated/Freezer Base with built-in compressor unit.
- Unit able to operate as refrigerator with temperature range from 32° F to 41° F (+0° C to +5° C).
- Stainless Steel front panel with incorporated Stainless Steel wire grate is easy to remove (protected by key lock) for access to the thermostat and to allow for easy cleaning.
- Delivered with stainless steel top with rear splash and sides to install top units with feet (doesn't allow modular installation).
- To be installed not closer than 2" (5 cm) from any wall or hot cooking appliances.
- The refrigerated air is discharged at the rear of the unit.
- Automatic defrost every 6 hours, the unit will turn off so the evaporator coil can defrost.

Construction

- Entirely constructed in stainless steel.
- Storage capacity is 6,5 Cu-ft (184lt).
- Unit to be mounted on casters and may be installed on feet (optional accessory).



Electrolux

EMPower
2 Drawer Refrigerated Chef Base 48"

Electrolux Professional, Inc.

www.electroluxusa.com/professional

10200 David Taylor Drive, Charlotte, NC 28262 • Telephone Number: 866-449-4200 • Fax Number: 704-547-7401



Electrolux

EMPower 2 Drawer Refrigerated Chef Base 48"

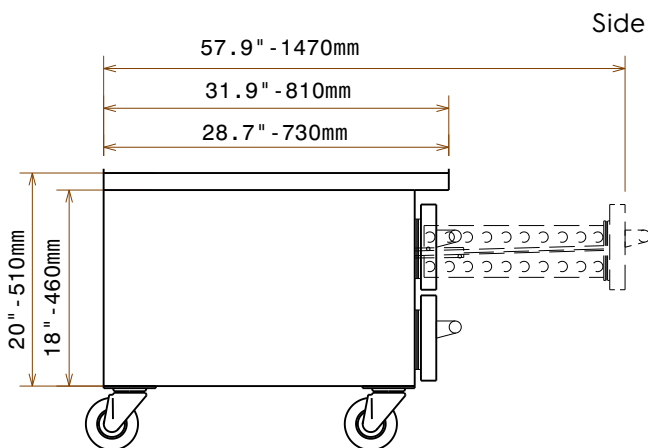
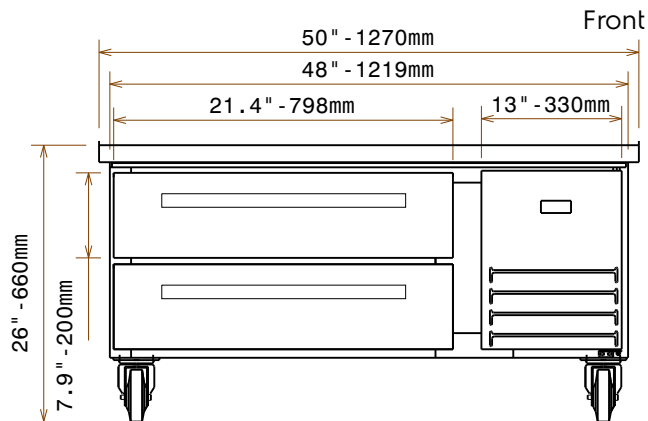

EI = Electrical connection

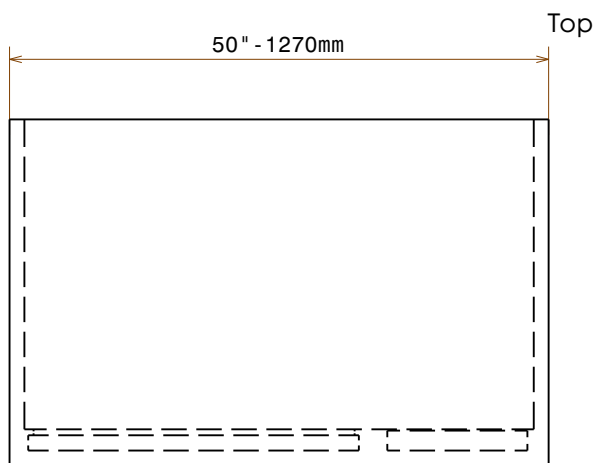

Electric

Supply voltage:

169207 (COMPCHEF48) 115 V/1 ph/60 Hz

Rated amps:

5.8 A

Total Watts:

0.6 kW

Plug type:

USA NEMA 5-15P

Key Information:

External dimensions, Width: 50" (1270 mm)

External dimensions, Depth: 31 7/8" (810 mm)

External dimensions, Height: 26" (660 mm)

Net weight: 234 lbs (106 kg)

Shipping width: 33 1/16" (840 mm)

Shipping depth: 51 3/16" (1300 mm)

Shipping height: 27 3/4" (705 mm)

Shipping weight: 260 lbs (118 kg)

Shipping volume: 27.18 ft³ (0.77 m³)

Refrigerant weight: 0.198 lbs (90 g)

Refrigeration Data

Compressor power:

Refrigerant type:

R290

Refrigeration power:

0 W



Electrolux

EMPower
2 Drawer Refrigerated Chef Base
48"

EMPower
2 Drawer Refrigerated Chef Base 48"

The company reserves the right to make modifications to the products
without prior notice. All information correct at time of printing.

2019.01.30