



KNOCK DOWN PROOFER



Knock Down Proofer Cabinet, Roll-In, Two-Section, Capacity (2) Double Side Load, (3) Single End Load Rack or (4) Single Side Loaf Racks, (2) Doors with Digital Touchscreen Control, Single Water Line, Auto Fill Humidity, Insulated Panels, Stainless Steel Construction, Expandable, Shipped Knocked Down, ETL, NSF



PROJECT _____
ITEM NO. _____
NOTES _____

MODEL NUMBER: **KDP21, KDP22, KDP23**



FEATURES

- ☐ Digital Touchscreen Control with Programmable Recipes
- ☐ Even Airflow Heating System Maintains the Right Combination of Heat and Humidity for Optimal Proofing
- ☐ Proofs from Room Temperature up to 110°F (43°C)
- ☐ Relative Humidity up to 95%
- ☐ Automatic Water Fill System (no water pans required)

CONSTRUCTION

- ☐ Stainless Steel Construction
- ☐ Single Water Line Connection
- ☐ Ships Knock Down

CLEARANCES

Minimum Clearance from Combustible Materials:

- ☐ 4" (102mm) Sides & Back
- ☐ 24" (609mm) Top

OPTIONS & ACCESSORIES

- ☐ Water Filter (50-1530) (recommended)
- ☐ Pass-Through Configuration (Suffix PT) (please note single control panel only on front, and door hinged same side)
- ☐ Factory Installation & Startup
- ☐ Factory Startup (Installation not Included)
- ☐ Stainless Steel Floor with Drain*

WARRANTY

- ☐ One Year Labor & Two Year Parts

*CONTACT FACTORY TO VERIFY IF FLOOR IS REQUIRED FOR USE WITH UNIT

*racks not included



Model	Crated Weight	# of Humidifiers	Overall Dimensions		
			W	D	H
KDP21		1	74 1/2" (1892)	47 3/8" (1203)	101" (2565)
KDP22		2	74 1/2" (1892)	87 3/8" (1203)	101" (2565)
KDP23		3	74 1/2" (1892)	127 3/8" (3235)	101" (2565)





PROJECT

ITEM NO.

NOTES

MODEL NUMBER:

KDP21, KDP22, KDP23

DRAWINGS

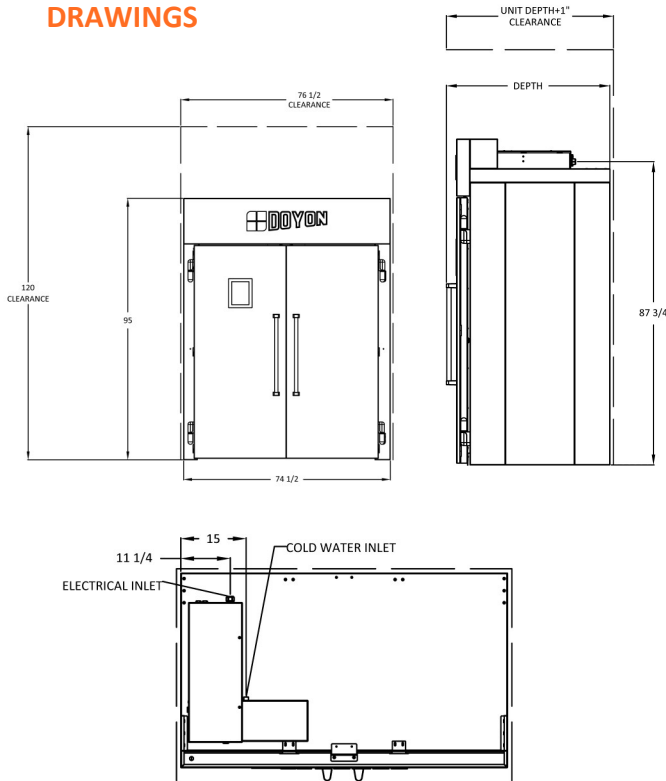

KDP(R) SERIES INTERNAL DIMENSIONS

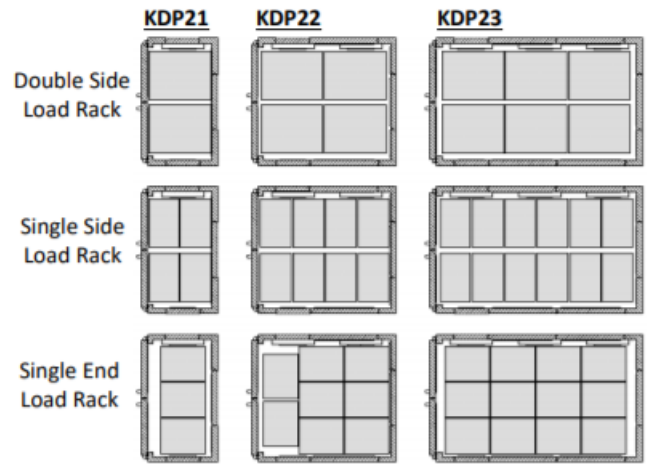
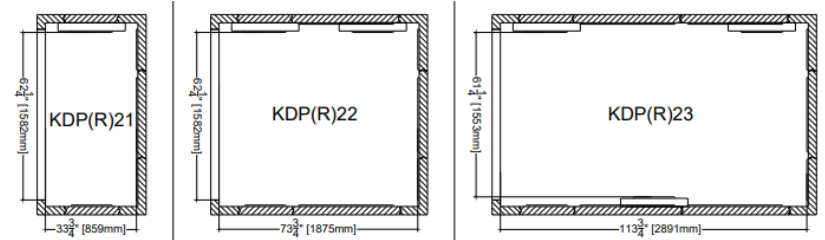

INSTALLATION NOTES & REQUIREMENTS

WATER LINE: 1/4" TUBE Cold Water Line Connection Required with 15-25 PSI.**UTILITIES:** Do not route utilities (wiring, plumbing, etc.) in or under the non-combustible floor beneath the proofer.**FLOOR:** Unit should be installed on level surface within 1/8" per foot for proper installation. Slope should not exceed 3/4" in all directions under the unit. Unit must be installed on a non-combustible material floor with a cleanable surface.**DRAIN:** Drain not included.**CLEARANCES:** 10' ceiling height required for proper airflow and service access. 1" clearance between proofer and oven recommended to ensure proper proofer operation.

Model	Water Inlet	Electrical System*				
		Volts	Phases	Amps	kW	Hertz
KDP21	1/4" (6) TUBE	208	1	24	5	60
	15-25 PSI*	240	1	21	5	60
KDP22	1/4" (6) TUBE	208	1	48	10	60
	15-25 PSI*	240	1	42	10	60
KDP23	1/4" (6) TUBE	208/240	1	72/63	15	60
	15-25 PSI*	208/240	3	42/36	15	60

*PRESSURE REGULATOR NOT INCLUDED *GROUND WIRE NOT INCLUDED

SPECIFICATIONS SUBJECT TO CHANGE WITHOUT NOTICE

KCL & REVIT DRAWINGS UPON REQUEST

REVISION B | 5/20/2022

Follow Us



Doyon

5600 13th Street, Menominee, MI 49858

906.863.4401 | 800.338.9886 | www.doyon.qc.ca

