

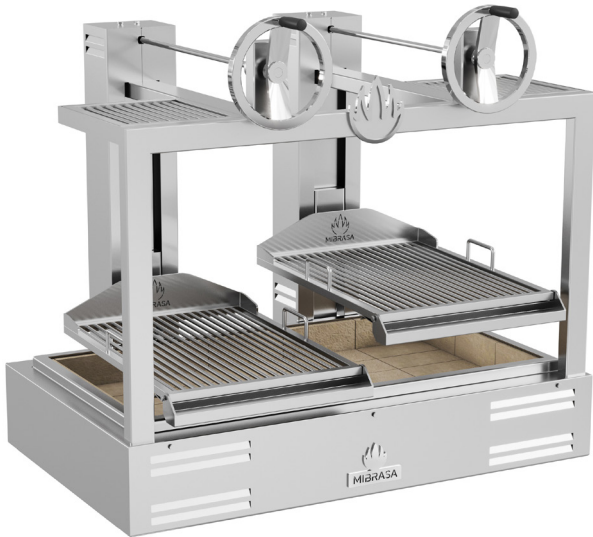

Project: _____ Item# _____

Parrilla GMB 130



FEATURES

Precision and strength is key to the PARRILLA by MIBRASA®. Effortlessly regulate the height of your grill surface thanks to the carefully engineered sprocket and chain system, keeping maintenance down to a minimum.

The system lets us sear, cook and rest our ingredients, to get the optimal result every time.

ERGONOMICALLY DESIGNED WITH MAXIMUM QUALITY AND SECURITY

With a sloping grill, the grease runs down the weld-free grill bars to prevent grease build-up. Grease drips down to the collector with an easy to remove mechanism ready to clean.

The base is lined with refractory bricks to ensure maximum heat efficiency and resistance to pure fire. And the built-in cooling system in outer case guarantees a maximum level of security.

Built using quality steels providing strength and durability; ergonomically designed for practicality and ease of use, each feature plays a crucial part in delivering the ultimate grilling machine for every chef.

TECHNICAL INFORMATION

| | | |
|-------------------------------------|--|--|
| Fire up time ¹ | 30 min-average | |
| Cooking temperature | 482 °F | 250 °C |
| Total cooking surface area | 2 x (25" x 19.5") = 6.8 ft ² | 2 x (685 x 500mm) = 0.64 m ² |
| Grill height range | 13.78" | 350 mm |
| Initial charcoal load ¹ | 26 lb | 12 kg |
| Charcoal load duration ² | 7 h | |
| Equivalent power* | 6.4 hp | 4.8 kW |
| Exhaust rate | 315 gal/s | 4300 m ³ /h |
| Installation height* | 27.56" | 700 mm |
| Net weight ³ | 772 lb | 350 kg |
| Crated weight* ³ | 1014 lb | 460 kg |
| Crated size (WxDxH) | 44" x 60" x 54" | 1120 x 1510 x 1380 mm |

*Approximate data

1. Consult instruction manual
2. Will vary depending on quality of charcoal
3. Weight with accessories included

INCLUDED ACCESSORIES

- 2 rod grills [CPV130]
- 2 Mibrasa tongs [TG]
- Ash shovel [PALA]
- 2 Grill brushes [CEP]
- Ember poker [PK]

OPTIONAL ACCESSORIES

- V-shape grill [GV130]
- Swivel hook [GGCV]
- Extra rod grill [CPV130]
- Thermal protector [EPGMB130]
- Burning pit lid [TAPA50]
- Espeto skewer kit [KITESPGB130]
- Vertical cooking rack [CPH-130]
- GN support kit [SGN130]

Specifications and design are subject to change without notice.

QUALITY GUARANTEE





Parrilla GMB 130

FRONT VIEW

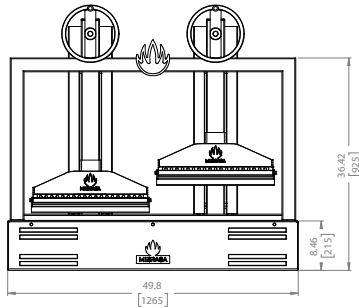

SIDE VIEW

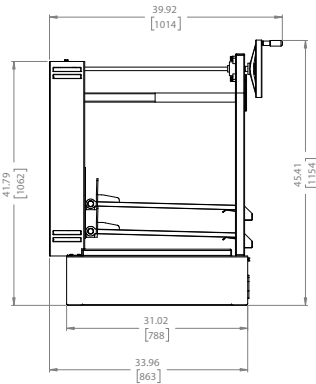

TOP VIEW

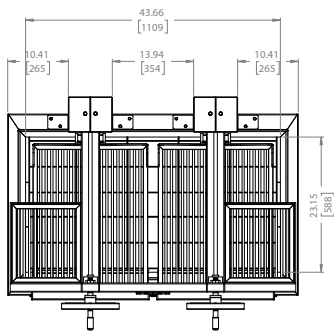

GRILL TYPES

Rod bar grill

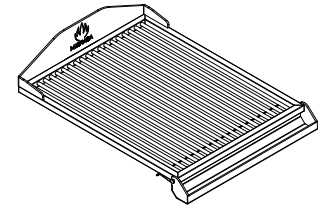

V-shape grill

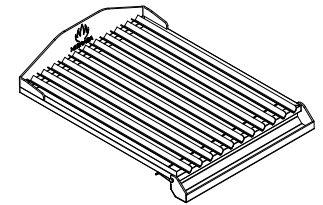

GRILL DIMENSIONS

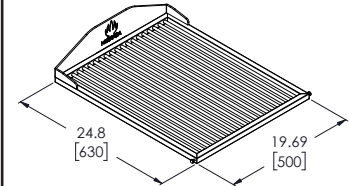

HEATING RACK DIMENSIONS

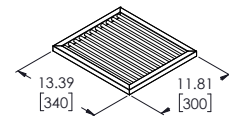

Dimensions in inches and [mm]

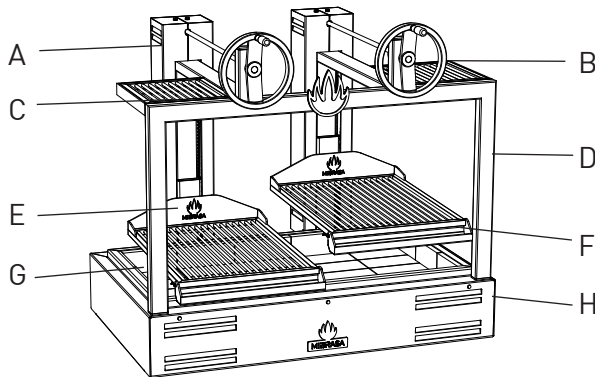

| | |
|---|--------------------------|
| A | Reverse elevating system |
| B | Elevating wheel |
| C | Heating rack |
| D | Structure |
| E | Grill |
| F | Grease collector |
| G | Refractory bricks |
| H | Main body |

usa@mibrasa.com

Safety standards and installation guidelines

- Combustible floor protection dimensions: a. 30 in [762 mm] to each side of the Parrilla
b. 36 in [914 mm] in front of the Parrilla
- Clearances to combustable construction/other appliances: a. Unit to backwall = 7 in [180 mm]
b. Unit to sidewalls = 28 in [720 mm]
- The workspace for the chef should be 27.56 in [700 mm] from the front of the Parrilla.
- A lifting device should be used whenever possible to lift the Parrilla and place on the countertop/stand.

For further information, please consult the instruction manual.

Specifications and design are subject to change without notice.



Parrilla GMB 130

OPTIONAL COMPLETE STAND



TECHNICAL INFORMATION

| | | |
|-----------------------------|-------------------|-----------------------|
| Ref. | GMB130 + MCGMB130 | |
| Net weight ³ | 981 lb | 445 kg |
| Crated weight* ³ | 1268 lb | 575 kg |
| Crated size (WxDxH) | 44" x 60" x 85" | 1120 x 1510 x 2150 mm |

| | | |
|-----------------------------|-----------------|----------------------|
| Ref. | MCGMB130 | |
| Net weight ³ | 209 lb | 95 kg |
| Crated weight* ³ | 243 lb | 110 kg |
| Crated size (WxDxH) | 44" x 60" x 28" | 1120 x 1510 x 700 mm |
| No. drawers | 3 | |
| No. GN rack slots | 5 | |

OPTIONAL ACCESSORIES

- S/S Casters [WINOXG]

FRONT VIEW

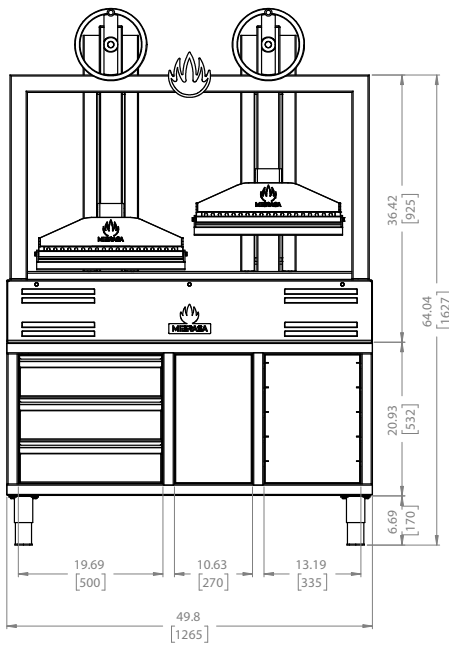

SIDE VIEW

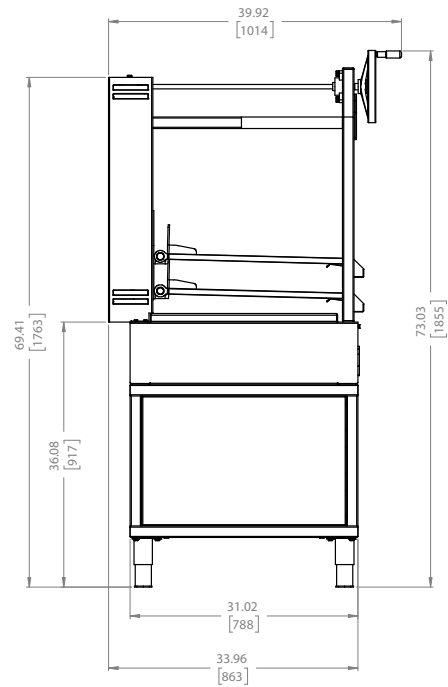

Dimensions in inches and [mm]

MIBRASA® USA Corp.
 8950 SW 74th Ct., Suite 1406
 Miami, Florida 33156 - U.S.A.
 Ph: (408) 348 7607 - usa@mibrasa.com
www.mibrasa.com



Parrilla GMB 130

OPTIONAL STANDARD STAND



TECHNICAL INFORMATION

| | | |
|-----------------------------|-----------------|-----------------------|
| Ref. | GMB130 + MGB130 | |
| Net weight ³ | 849 lb | 385 kg |
| Crated weight* ³ | 1135 lb | 515 kg |
| Crated size (WxDxH) | 44" x 60" x 85" | 1120 x 1510 x 2150 mm |

| | | |
|-----------------------------|-----------------|----------------------|
| Ref. | MGB130 | |
| Net weight ³ | 77.2 lb | 35 kg |
| Crated weight* ³ | 110.2 lb | 50 kg |
| Crated size (WxDxH) | 44" x 60" x 28" | 1120 x 1510 x 700 mm |

OPTIONAL ACCESSORIES

- S/S Casters [WINOXG]
- GN Tray rack [SGN]

FRONT VIEW

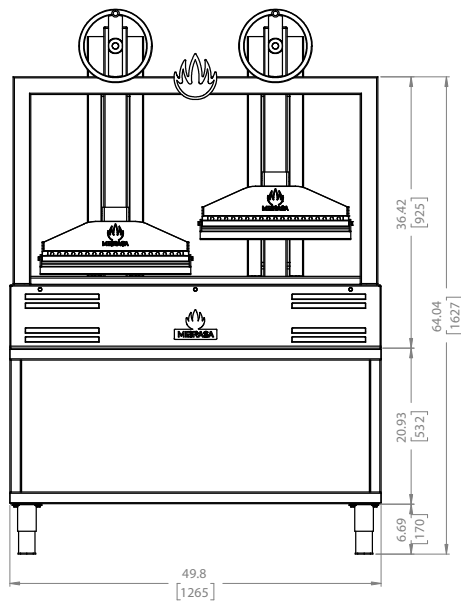

SIDE VIEW

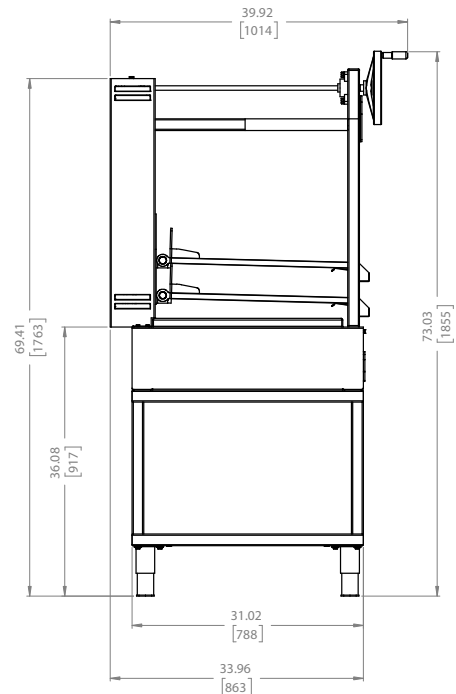

Dimensions in inches and [mm]