

Durable Design

- Black interior
- Black trim
- Base w/package ledge
- Glass ends
- Solid back panel
- Hinged glass front doors
- Tray support, non-lighted shelves
- Holds (12) 13" x 18" trays
(Trays not included)

Energy Efficiency

- LED 6000K lighting
- 6' power cord - 45CT



Non-Refrigerated Self Service Pastry Merchandiser

KSSD-45CT / KSSD-45BS



KSSD-45BS



KSSD-45CT

MODEL NUMBER	POWER	NET WEIGHT	SHIPPING WEIGHT	OVERALL DIMENSION	SHIPPING DIMENSION
KSSD-45CT	120W	168 lbs	199 lbs	44.76 x 22.75 x 39.76 in	47.5 x 25.5 x 46.25 in
KSSD-45BS	—	58 lbs	98 lbs	44.76 x 35.12 x 26.18 in	47.5 x 37.87 x 32.67 in

Warranty: 12 months parts and labor.



Intertek



Intertek



Nema 5-15P

Project Name:	
Location:	
Item:	Qty:
Model:	



3560 NW 56th St. Fort Lauderdale, FL 33309
Telephone: 786.600.4687 / Toll Free: 844.218.8477
Fax: 786.661.4100

5659 Royalmount Ave.
Montreal, QC, Canada H4P 2P9
Telephone: 514.737.9701 / Toll Free: 888.275.4538
Fax: 514.342.3854 / Toll Free: 877.453.8832
sales@mvpgroupcorp.com / mvpgroupcorp.com



**Non-Refrigerated Self Service
Pastry Merchandiser**
KSSD-45CT / KSSD-45BS

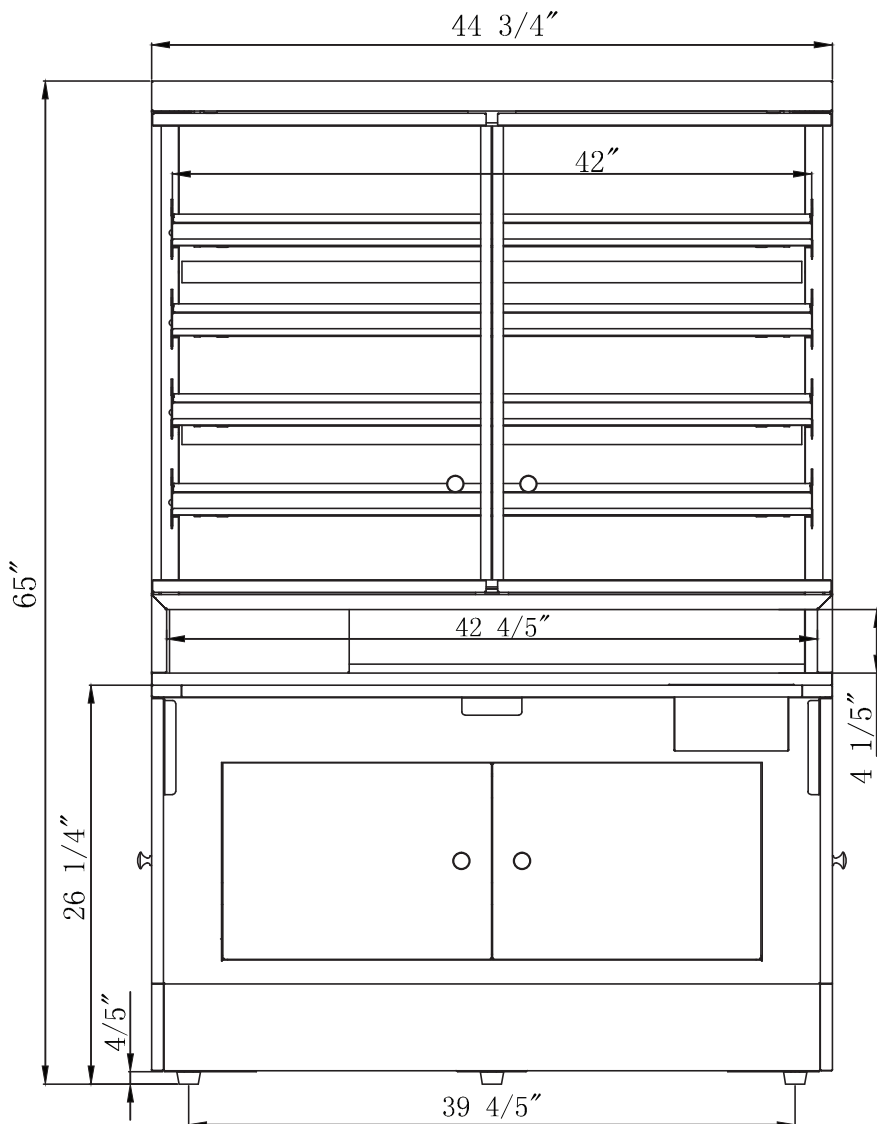

KSSD-45CT

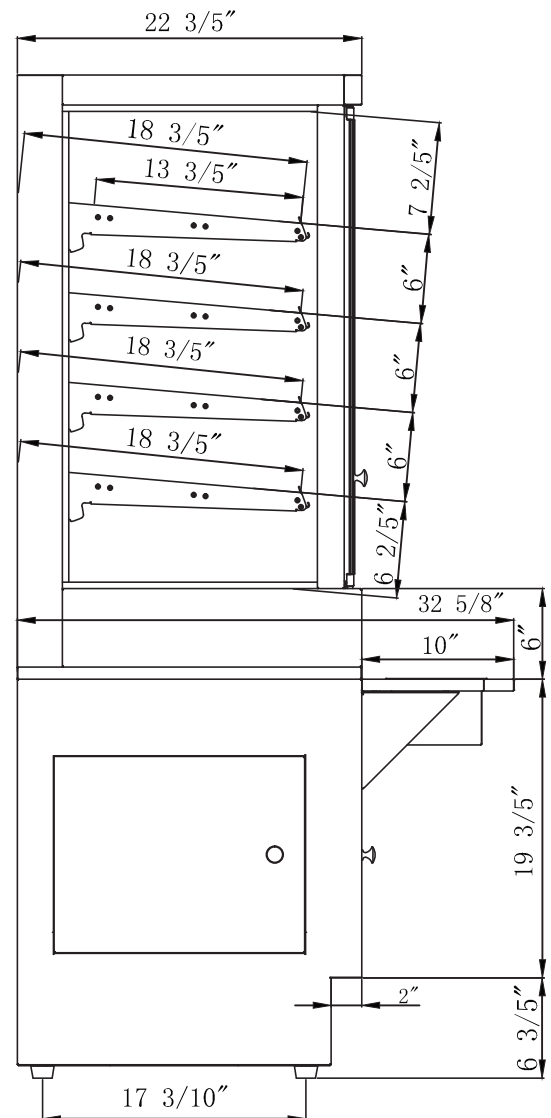

KSSD-45BS

KOOL-IT is a registered trademark of MVP Group.
Specifications subject to change without notice.



3560 NW 56th St. Fort Lauderdale, FL 33309
Telephone: 786.600.4687 / Toll Free: 844.218.8477
Fax: 786.661.4100

5659 Royalmount Ave.
Montreal, QC, Canada H4P 2P9
Telephone: 514.737.9701 / Toll Free: 888.275.4538
Fax: 514.342.3854 / Toll Free: 877.453.8832
sales@mvpgroupcorp.com / mvpgroupcorp.com