

# BASE UNDERCOUNTER REFRIGERATOR

## Model: RA118N-U

Natural Refrigerant R-290 Model

### 118" Base Undercounter Refrigerator with Solid Doors

Heavy gauge #300 Series stainless steel top, stainless steel front and end panels, galvanized steel rear and grill and aluminum interior.



## Options and Accessories

(upcharge and lead times may apply)

|   |  |
|---|--|
| Stainless steel interior                                  | Door locks                               |
| Stainless steel back                                      | Pan slides                               |
| Additional epoxy coated steel shelf                       | Condensing unit left (standard on right) |
| Stainless steel shelf                                     |  |
| Drawer in lieu of door section above the condensing unit* |  |
| Drawers in lieu of doors (consult factory)**              |  |

Consult factory for other model configurations, options and accessories.

\*Drawer section above condensing unit holds (1) 12 x 20 x 6 pan.

\*\*Two tier (larger section): (2) 12x20x6 pans per drawer

**Continental**  
Refrigerator

Toll-Free: 800-523-7138  
Phone: 215-244-1400  
Fax: 215-244-9579

539 Dunksferry Road  
Bensalem, PA 19020  
www.continentalrefrigerator.com

Project Name:

Model Specified:

Location:

Item No:

Quantity:

AIA #:

SIS #:

## Standard Model Features

### REFRIGERATION SYSTEM

Performance rated refrigeration system

Natural, environmentally safe, high efficiency R-290 refrigerant<sup>1</sup>

Unique forced air design utilizes fans (approx. every 12") across the entire back of unit for even distribution of cold

Automatic, hot gas condensate evaporator

Non-corrosive, plasticized fin evaporator coil

Easily serviceable, slide out condensing unit

Expansion valve system

### CABINET ARCHITECTURE

2" non-CFC polyurethane foam insulation

Smooth, polished chrome door handles

Spring loaded, self closing doors

Magnetic snap in Santoprene™ door gaskets

Heavy duty, epoxy coated steel shelf

Completely enclosed, vented and removable rear and side grills

(8) 1 3/8" diameter plate casters mounted on heavy duty support plates (easily field installed)

### MODEL FEATURES

Electronic control, off cycle defrost

Front breather air divider (field installed)

Refrigerated section with door above the condensing unit

Field rehingeable doors

<sup>1</sup> R-290 refrigerant meets all federal and state regulatory requirements.

**NOTE:** Models come standard with a door over the condensing unit. A drawer over the condensing unit is an option.

APPROVAL:

# Model Specifications

## DIMENSIONAL DATA

|   |  |
|---|--|
| Net Capacity (cubic feet)   | 44 (1246 cu l)                             |
| Width, Overall (inches)   | 118 <sup>3</sup> / <sub>16</sub> (3002 mm) |
| Depth, Overall (inches)<br>(including handles & bumpers)                              | 36 <sup>5</sup> / <sub>16</sub> (922 mm)   |
| Height, Overall (inches)<br>(including 1 <sup>3</sup> / <sub>8</sub> " plate casters) | 31 <sup>3</sup> / <sub>4</sub> (806 mm)    |
| Shelf Area (square feet)  | 18.4 (1.7 sq m)                            |
| Number of Shelves   | 8  |
| Number of Full Doors  | 4  |
| Number of Half Doors  | 1  |
| Interior Depth (inches)   | 30 (762 mm)                                |
| Interior Height (inches)  | 26 (660 mm)                                |
| Interior Height (inches)<br>(above condenser)   | 12 <sup>1</sup> / <sub>2</sub> (318 mm)    |
| Interior Width (inches)   | 114 (2896 mm)                              |

## REFRIGERANT DATA

|                             |                               |
|-----------------------------|-------------------------------|
| Condensing Unit Size (H.P.) | <sup>1</sup> / <sub>4</sub> + |
| Capacity (BTU per hour)*    | 5600                          |

## ELECTRICAL DATA

|  |                     |
|--|---------------------|
| Voltage (International)                        | 115/60/1 (220/50/1) |
| Total Amps (International)                     | 5.4 (3.6)           |
| 10 ft. Cord/Plug [attached]<br>(International) | Yes<br>(No)         |

## SHIPPING DATA

|                          |  |
|--------------------------|--|
| Weight (pounds)          | 705 (320 kg)                             |
| Height - Crated (inches) | 43 <sup>3</sup> / <sub>4</sub> (1111 mm) |
| Width - Crated (inches)  | 120 (3048 mm)                            |
| Depth - Crated (inches)  | 47 (1194 mm)                             |

\* Rating @ +25°F evaporator, 90°F ambient  
Figures in parentheses reflect metric equivalents rounded to the nearest whole unit.



Equipped with one NEMA-5-15P Plug  
(varies by country)

# Model Plan Views

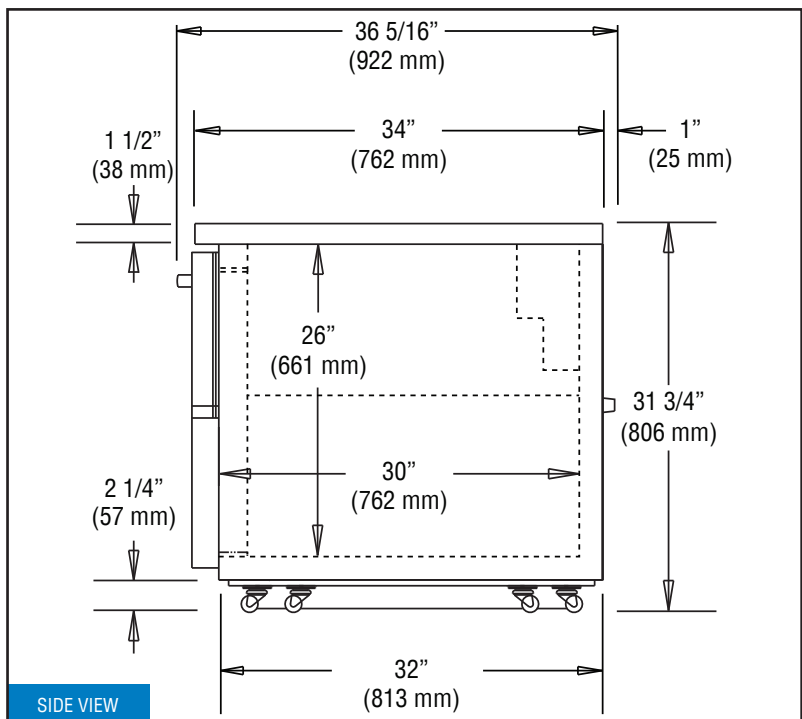
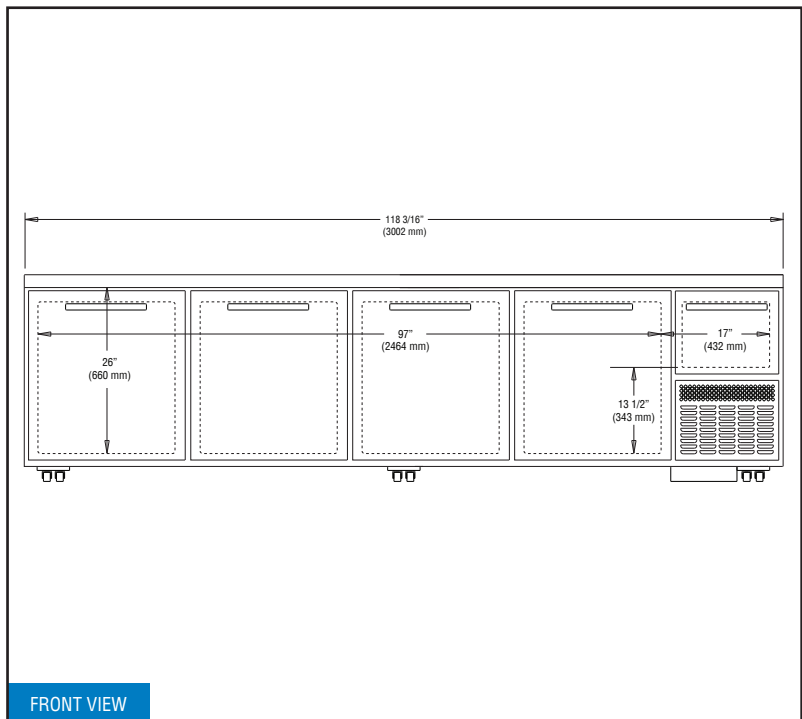

**NOTE:** For proper operation, the area under and in front of the cabinet **must** not be obstructed in any way.



Toll-Free: 800-523-7138  
Phone: 215-244-1400  
Fax: 215-244-9579

539 Dunksferry Road  
Bensalem, PA 19020  
[www.continentalrefrigerator.com](http://www.continentalrefrigerator.com)

Due to our continued efforts in developing innovative products, specifications subject to change without notice.

