

MODULAR ISLAND CORNER UTILITY FOOD COUNTERS



Item # _____ Quantity _____

Project _____

MODELS

- MP90-LI MP90-RI

M-POWER™ Series

- ▶ Durable all-welded stainless steel rigid frame
- ▶ Lightweight, easy mobility with 30" width for doorway passage
- ▶ Heavy duty 14-gauge stainless steel countertop
- ▶ 6" heavy-duty swivel casters, 2 ea. with brake
- ▶ Interchangeable stainless steel or optional laminate exterior panels match or complement any décor
- ▶ Optional fold-down 12" stainless steel 'V' ridge tray slides, removable without tools
- ▶ Optional toe plate(s), front plate hinged for easy access, available in stainless steel or powder coated in a variety of colors
- ▶ Patented *TIGHT LINK™* interlocking mechanism, eliminating vertical and horizontal gaps between counters

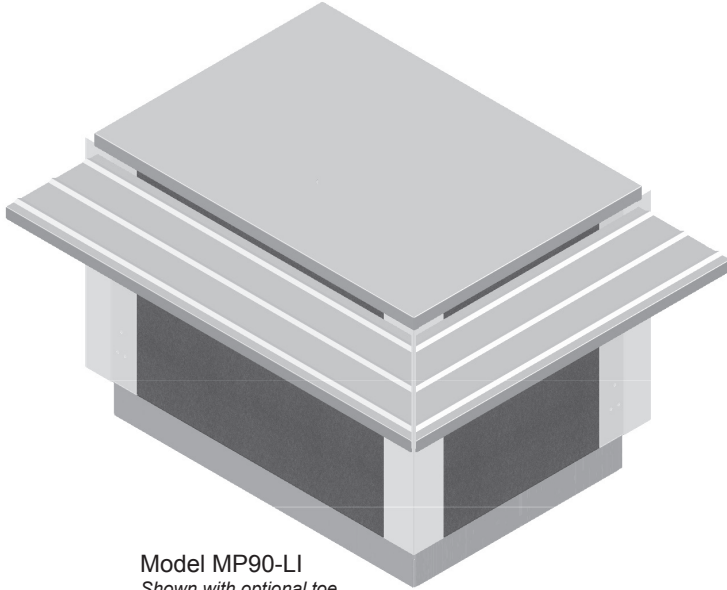

Model MP90-LI
Shown with optional toe plates, tray slides, and laminated panels.



OPTIONS & ACCESSORIES

Counter Height

- 34" high (standard) 32" high

Tray Slides (optional)

- 2" below counter 4" below counter

Exterior Panels

- Stainless steel (standard) Laminated MDO

Electrical (optional)

- 15-15R GFCI duplex outlet wired to 8' cordset with 5-15P plug
 Empty data box

Other Options/Accessories

- Stainless steel toe plate(s)
 Epoxy finish toe plate(s)
 Grommated cord passage hole on top

Optional Laminated Panel Finishes

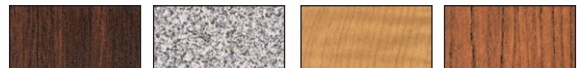

- Walnut Gray Sand Light Maple Victorian Cherry



- Beige Suede Hard Rock Maple Red Maple Black



- Red Green Royal Blue Purple

Other Plastic Laminate Finishes Available

- Specify _____

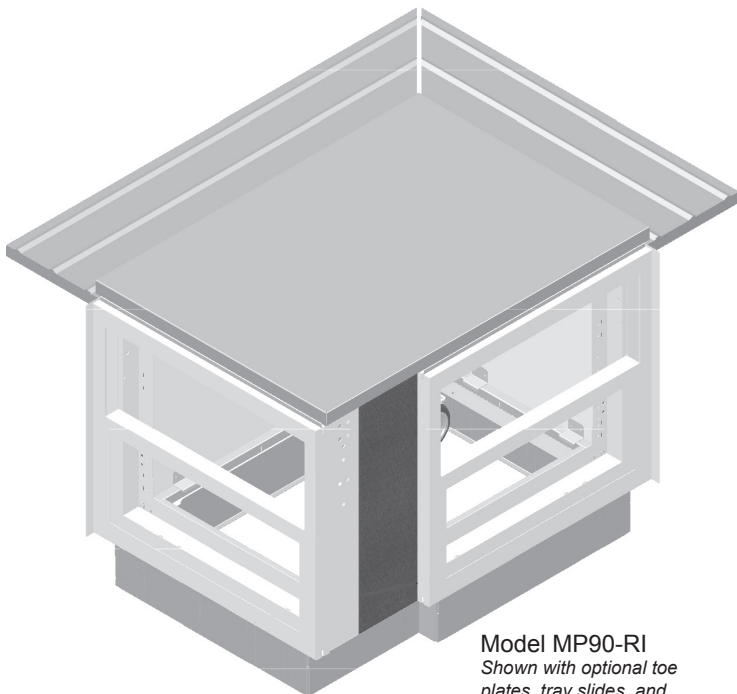

Model MP90-RI
Shown with optional toe plates, tray slides, and laminated panels.

MODULAR ISLAND CORNER UTILITY FOOD COUNTERS

MODELS

MP90-LI

MP90-RI

M-POWER™ Series

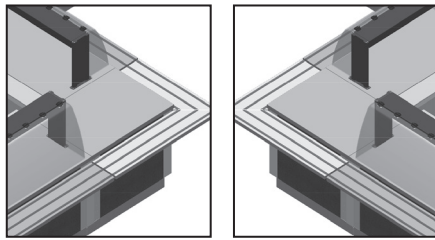

MP90-LI Configuration

MP90-RI Configuration

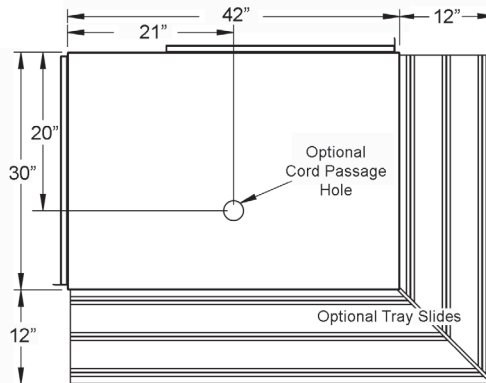

Plan View ▲

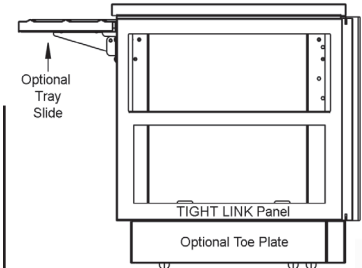

End View ▲

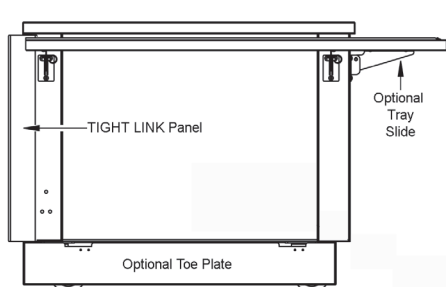

Front View ▲

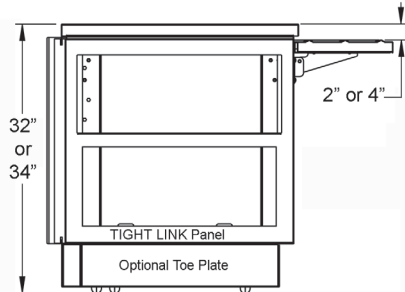

End View ▲

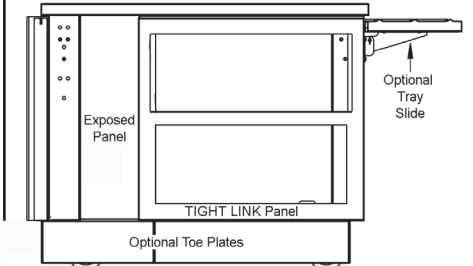

Front View ▲

Model MP90-LI

Model MP90-RI

Available Optional Toe Plate Colors

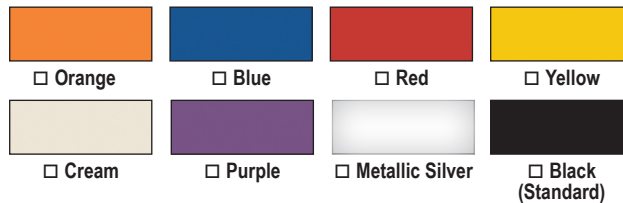

SPECIFICATIONS

General:

Provide Multiteria Model MP90 ____ (-LI, -RI), to be constructed with heavy-duty all-welded stainless steel rigid frame. Countertop to be manufactured with 14-gauge stainless steel with 1½" top turnaround. All welds to be ground and polished to provide #4 finish. Fold-down 12" wide stainless steel tray slides (optional) are mitered at the corner, feature triple 'V' ridge top surface, and are removable without tools.

Body Frame:

Core and shell is 100% stainless steel formed structural box ends, all TIG welded in place, no rivets or fasteners. Body frame is designed to accept TIGHT LINK™ fastening system for multiple counters (2 each panels are included). Unit has four ea. 6" heavy-duty swivel casters, two ea. with brake.

Front & End Panels:

All stainless steel panels are to be 18-gauge. Optional MDO panels are ¾" thick with standard plastic laminate on front and white laminate interior. Panels are removable for service access. Millwork end panels are removable without tools.

TIGHT LINK™ System

Patented system features slide-in panels that link adjacent counters together their entire depth and height to eliminate top, front and rear horizontal and vertical gaps between equipment. Linking panels are open to allow mechanical connections to run through adjoining counters without having to cut access holes, reducing the number of building mechanicals required to connect equipment.

Limited Warranty:

Core and shell has a lifetime warranty against weld or structural support failure.

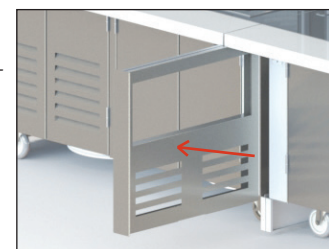

MULTITERIA • 4900 W. ELECTRIC AVENUE • WEST MILWAUKEE, WI 53219

OFFICE: 414.902.6400 • FAX: 414.902.6446 • INFO@MULTITERIAUSA.COM • WWW.MULTITERIAUSA.COM