

Flat Top Enclosed Cabinets

- 18 gauge stainless steel
- Machine mold with manual welding
- Full range adjustable middle shelf
- Cabinets are available with hinged or sliding doors
- 1-1/2" adjustable bullet foot

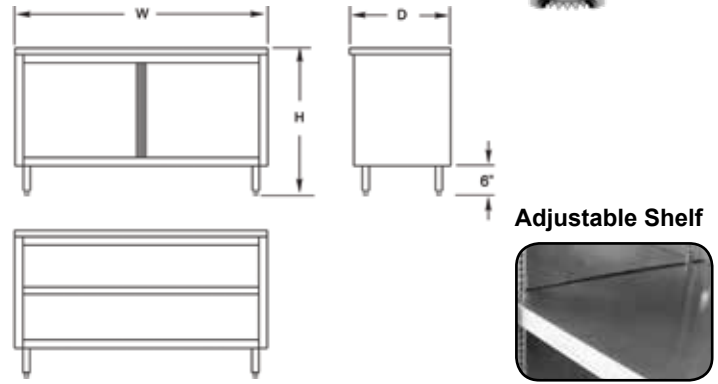

NO DOOR - Flat Top Cabinets



Item No.	D x W x H (in)	Load Cap. (lb)	G. W. (lb)	Bulk Qty.
CTN-2436	24 x 36 x 35	400	99	3
CTN-2448	24 x 48 x 35	420	124	3
CTN-2460	24 x 60 x 35	450	149	3
CTN-2472	24 x 72 x 35	480	198	3
CTN-3036	30 x 36 x 35	500	106	3
CTN-3048	30 x 48 x 35	520	131	3
CTN-3060	30 x 60 x 35	550	156	3
CTN-3072	30 x 72 x 35	580	212	3

• Marked items qualifies for **Bulk Quantities!**

HINGED DOORS - Flat Top Cabinets



Item No.	D x W x H (in)	Load Cap. (lb)	G. W. (lb)	Bulk Qty.
CTD-2436H	24 x 36 x 35	400	115	3
CTD-2448H	24 x 48 x 35	420	140	3
CTD-2460H	24 x 60 x 35	450	165	3
CTD-2472H	24 x 72 x 35	480	230	3
CTD-3036H	30 x 36 x 35	500	122	3
CTD-3048H	30 x 48 x 35	520	147	3
CTD-3060H	30 x 60 x 35	550	172	3
CTD-3072H	30 x 72 x 35	580	244	3

• Marked items qualifies for **Bulk Quantities!**

SLIDING DOORS - Flat Top Cabinets



Item No.	D x W x H (in)	Load Cap. (lb)	G. W. (lb)	Bulk Qty.
CTD-2436S	24 x 36 x 35	400	115	3
CTD-2448S	24 x 48 x 35	420	140	3
CTD-2460S	24 x 60 x 35	450	165	3
CTD-2472S	24 x 72 x 35	480	230	3
CTD-3036S	30 x 36 x 35	500	122	3
CTD-3048S	30 x 48 x 35	520	147	3
CTD-3060S	30 x 60 x 35	550	172	3
CTD-3072S	30 x 72 x 35	580	244	3

• Marked items qualifies for **Bulk Quantities!**