

## 4" Rear Upturn Enclosed Cabinets

- 18 gauge stainless steel
- Machine mold with manual welding
- Full range adjustable middle shelf
- Cabinets are available with hinged or sliding doors
- 1-1/2" adjustable bullet foot
- 4" rear upturn

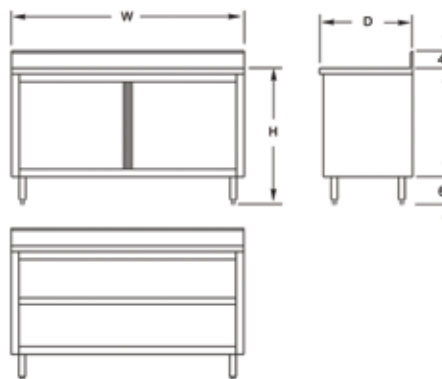

Adjustable Shelf



### NO DOOR - 4" Rear Upturn Cabinets



Item No.	D x W x H (in)	Load Cap. (lb)	G. W. (lb)	Bulk Qty.
CTN-P2436	24 x 36 x 35	400	101	3
CTN-P2448	24 x 48 x 35	420	127	3
CTN-P2460	24 x 60 x 35	450	153	3
CTN-P2472	24 x 72 x 35	480	202	3
CTN-P3036	30 x 36 x 35	500	109	3
CTN-P3048	30 x 48 x 35	520	134	3
CTN-P3060	30 x 60 x 35	550	158	3
CTN-P3072	30 x 72 x 35	580	218	3

• Marked items qualifies for **Bulk Quantities!**

### HINGED DOORS - 4" Rear Upturn Cabinets



Item No.	D x W x H (in)	Load Cap. (lb)	G. W. (lb)	Bulk Qty.
CTD-P2436H	24 x 36 x 35	400	117	3
CTD-P2448H	24 x 48 x 35	420	143	3
CTD-P2460H	24 x 60 x 35	450	171	3
CTD-P2472H	24 x 72 x 35	480	234	3
CTD-P3036H	30 x 36 x 35	500	125	3
CTD-P3048H	30 x 48 x 35	520	150	3
CTD-P3060H	30 x 60 x 35	550	176	3
CTD-P3072H	30 x 72 x 35	580	250	3

• Marked items qualifies for **Bulk Quantities!**

### SLIDING DOORS - 4" Rear Upturn Cabinets



Item No.	D x W x H (in)	Load Cap. (lb)	G. W. (lb)	Bulk Qty.
CTD-P2436S	24 x 36 x 35	400	117	3
CTD-P2448S	24 x 48 x 35	420	143	3
CTD-P2460S	24 x 60 x 35	450	171	3
CTD-P2472S	24 x 72 x 35	480	234	3
CTD-P3036S	30 x 36 x 35	500	125	3
CTD-P3048S	30 x 48 x 35	520	150	3
CTD-P3060S	30 x 60 x 35	550	176	3
CTD-P3072S	30 x 72 x 35	580	250	3

• Marked items qualifies for **Bulk Quantities!**