



Project Name: \_\_\_\_\_

Item #: \_\_\_\_\_

Model #: \_\_\_\_\_

# WSMS HAND SINK INSTALLATION GUIDE

For Design and Installation Assistance  
Call: 800-221-5644  
[info@imcteddy.com](mailto:info@imcteddy.com)

50 Ranick Drive East • Amityville, NY 11701  
(P) 800-221-5644 • (F) 631-789-8881

[www.imcteddy.com](http://www.imcteddy.com)

# INTRODUCTION

Installing the IMC Teddy Hand Sink is a straightforward procedure that can be accomplished with normal construction materials and techniques. Installation procedures may vary due to field conditions and state regulations. Please note that the following instructions are recommendations only. The installer is responsible for proper setting and making sure the appropriate codes are followed. Please contact the IMC Teddy Engineering Department (800-221-5644) prior to considering retrofit installations.

Please read the attached information carefully, as much of the information provided is reflecting proven installation techniques used in previous installations.

## Parts Included

- WSMS Hand Sink
- "Z clip" Mounting Bracket
- Mounting Brackets (2)
- Faucet (Sold Separately)

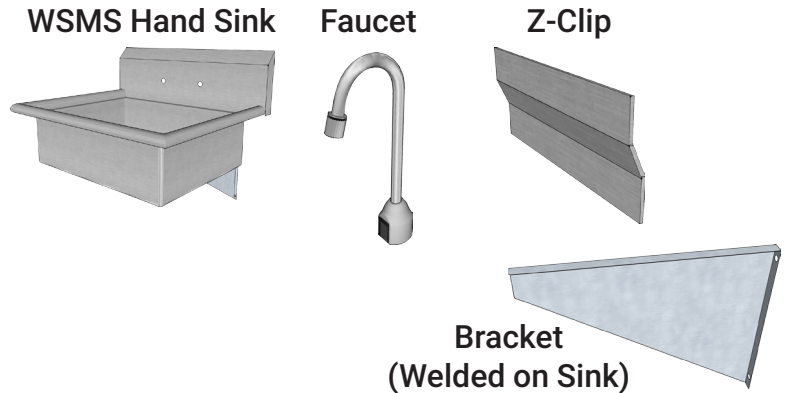

## Step 1:

Position z-bracket onto wall at the appropriate height above the floor and mark holes for drilling. (Make sure bracket is level.) Once holes are drilled screw bracket to wall. (Hardware not included.)

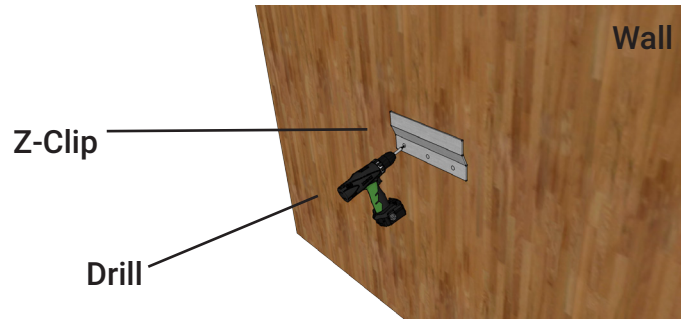

## Step 2:

Install included parts, in this case the faucet.

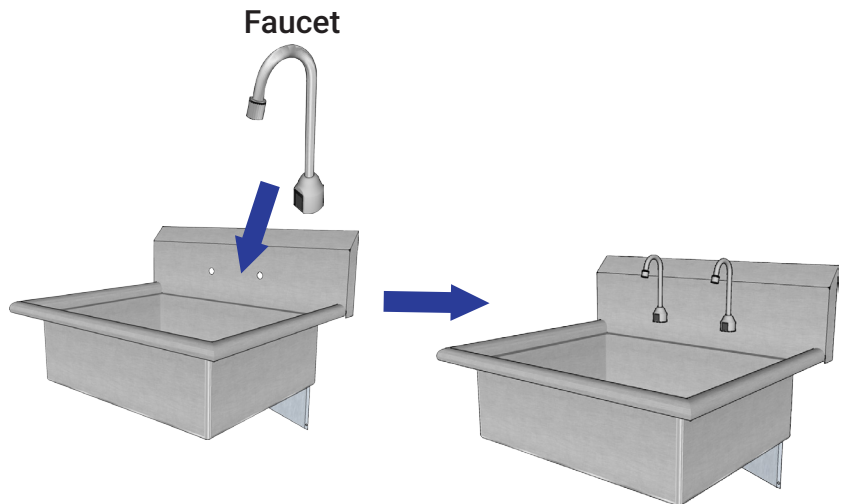

(Model shown is WSMS Hand Sink)

### Step 3:

Place sink on z-bracket. Place brackets underneath edge of sink and against the wall to drill screws in.

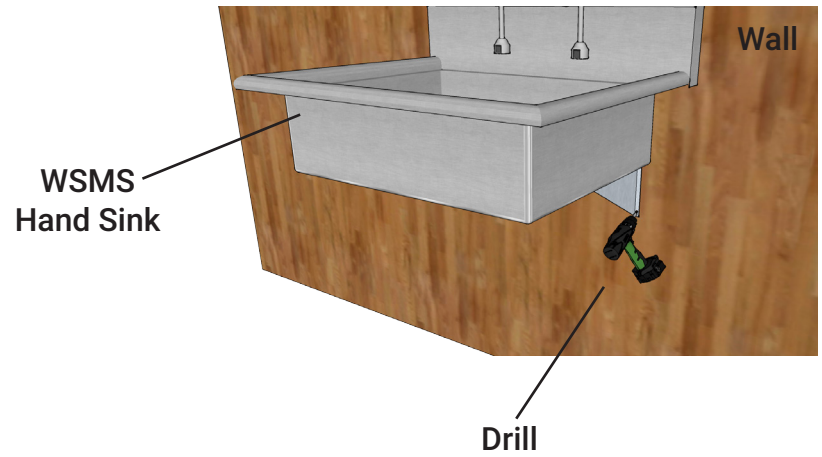

### Step 4:

Make all necessary plumbing connections to faucet and waste drain.

