



KITCHEN BRAINS

Driven by **(FAST)** Networked by **SCK**

OPERATING GUIDE

(FASTRON.)[®] MERIDIAN Series Cooking Timers

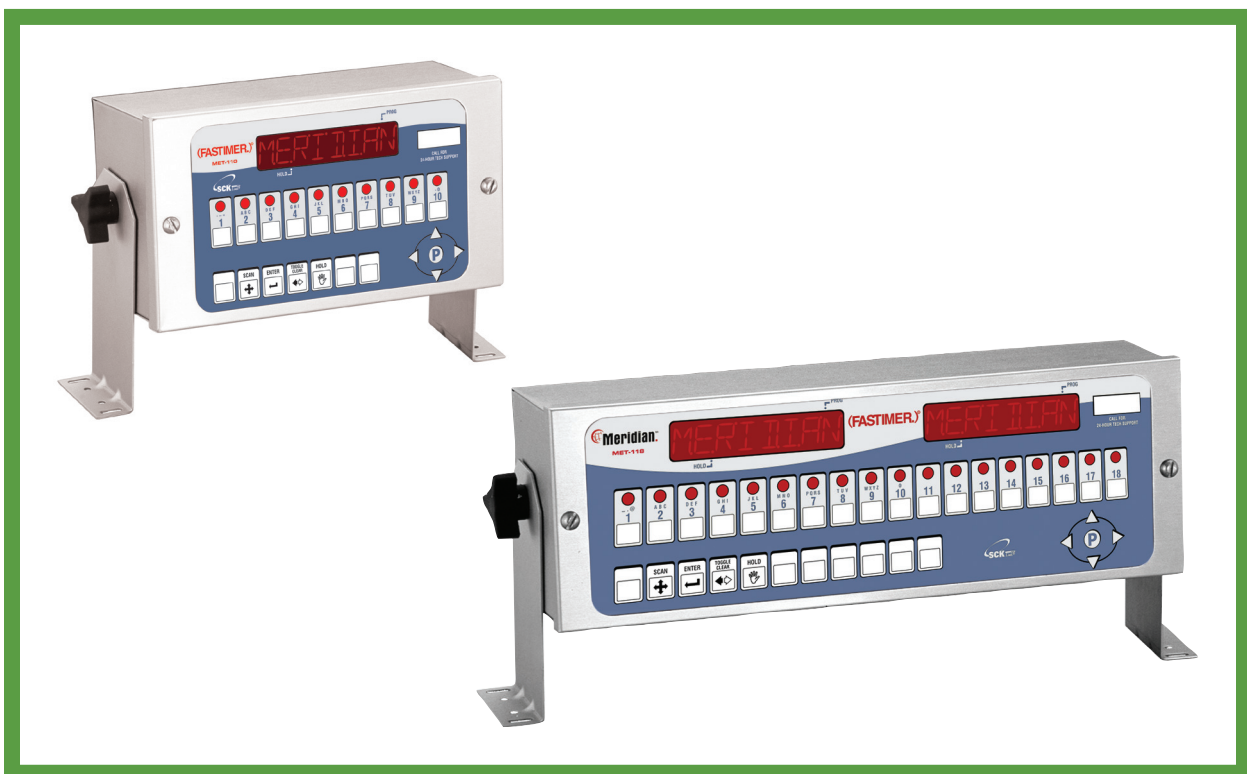

Operating a (FASTRON.)[®] MERIDIAN Series Cooking Timer with:

- MET-110 (10 Product Keys)
- MET-118 (18 Product Keys)

\$5.00 USD

Save the instructions
for future reference.
www.KitchenBrains.com

24/7 Toll-Free Technical Support
1-800-243-9271
(from the U.S., Canada and the Caribbean)

NOTICES

Before you start, please read entire manual.



Kitchen Brains is not liable for any use of product not in accordance with Kitchen Brains' installation and operation instructions.

Before using this equipment, or for any questions on the operations of the appliance, consult and follow all instructions and safety warnings found in the appliance operator's manual supplied from the manufacturer of the appliance.

TIMER OPERATING ENVIRONMENT

The solid state components in this timer are designed to operate reliably in a temperature range up to 158°F/70°C. Before installing this timer, it should be verified that the ambient temperature at the mounting location does not exceed 158°F/70°C.

CLEANING THE TIMER

Using a clean damp cloth, wipe down your controller daily using a commercial quality foodservice-approved detergent.

Do not allow oil to build up on any part of the controller.



NEVER use chemical or abrasive cleaners on your controller. The controller's overlay may be damaged.

TOOLS REQUIRED

- Straight Screwdriver
- Power Drill
- #29 High-Speed Drill Bit
- 10/32 Tap
- Center Punch
- Hammer

INSTALLATION

1. Turn appliance power OFF.
2. Choose your mounting location.
3. Attach 2 mounting brackets to the controller using the 2 wing nuts provided. Be sure to put 1 star washer on each side of the mounting bracket.
4. Hold the computer against your mounting surface.
5. Mark 4 mounting holes.
6. Drill and tap the mounting holes.
7. Secure the timer to the mounting surface using the 4 screws provided.

OPERATING THE (FASTIMER.)® MERIDIAN TIMER

PROGRAMMING CODES

Product Programming 1 7 2 4

System Programming 3 2 2 8

TIMER FEATURES

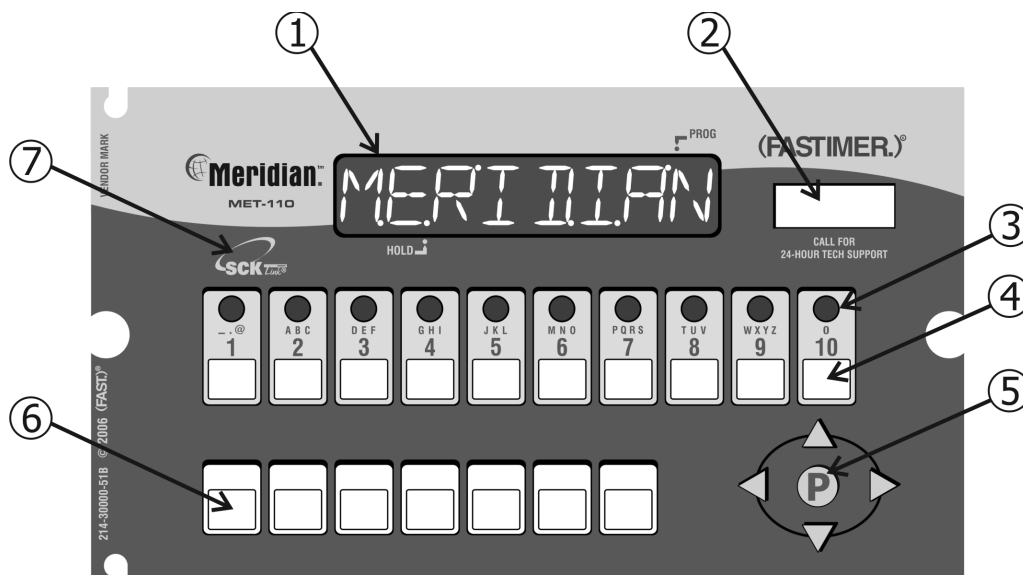

- 1 **LARGE LED DISPLAY:** 8-character, 14-segment. Displays programming and cook cycle information.
- 2 **SERVICE WINDOW:** Locate the timer's serial number and tech support phone number easily.
- 3 **INDICATOR LIGHTS:** Lit when there's an active cook cycle and in programming mode.
- 4 **PRODUCT KEYS:** Press to start a cook cycle. Also used in programming.
REPLACEABLE MENU STRIP: Make menu changes quickly and easily.
- 5 **PROGRAMMING CENTER: (FAST.Nav)™:** Easy mobile phone-like programming with predictive text. Access programming mode and change cooking parameters.
- 6 **FEATURE KEYS:** Used to access programming functions and controller features; keys will vary by model.
- 7 **SCK® LINK:** Signifies that your control is communications-capable.

OPERATING THE (FASTIMER.)® MERIDIAN TIMER (CONTINUED)

FEATURES EXPLAINED

Programmable Action Alarms

Up to three action alarms can be programmed for each product key. An action alarm alerts the operator to perform some action at a pre-programmed time.

Programmable Hold Time Linking

Each product key can be linked to an independent hold timer, or multiple product keys can be linked to a single hold timer.

Programmable Hold Times

Product key hold times can be programmed to track product quality through a specified holding period. The timer will sound an alarm when the product's hold time has expired alerting the operator to discard the product.

Automatic Least Hold Display

Product with the least amount of hold time remaining will be shown in the display. Pressing and holding the HOLD key allows you to view each active product's remaining hold time.

OPERATING THE TIMER

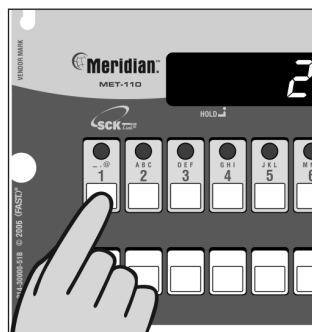

Start a Cook Cycle

Press any product key to start a cook cycle. If the key is programmed, the correct cooking time will be displayed and will immediately start to count down in minutes and seconds. DONE will display when the cook cycle has ended.

The pressure solenoid will also close if programmed to do so, or a basket lift will lower if so equipped.

If DONE is displayed immediately and the unit starts to signal, the product key being pressed is not programmed.

Stop a Cook Cycle

Press and hold an active product key for 3 seconds. Timing will stop.

Respond to a DONE Alarm

Cancel the signal by pressing the same product key used to start the cook cycle.

Action Alarms

If the controller is programmed for action alarms, they will signal at a preset time during the cooking cycle. The signal, a dual-rhythm beeping, will last 5 seconds and then self-cancel. The display will flash the action alarm time and the controller will start counting toward 0:00.



OPERATING THE (FASTIMER.)® MERIDIAN TIMER (CONTINUED)

OPERATING THE TIMER (CONTINUED)



Holding Timers

When there are active hold times, the HOLD indicator light will be lit.

To **View All Active Hold Times**, press and hold the HOLD key. Upon expiration, the timer will display HOLD and pulse with an audible tone. Acknowledge by pressing the HOLD key.

To **Cancel a Hold**, press the TOGGLE/CLEAR key followed by the HOLD key then the key you want to cancel.

DISPLAY DESCRIPTIONS



Timer is in Operating Mode.



Timer is in Operating Mode and a cook cycle is in progress.



Timer is in Operating Mode and a cook cycle has been completed.



Timer is waiting for a pass code to be entered.



Timer is in Product Key Programming Standby mode.



Cook time is being programmed.



An Action Alarm #1 is being programmed. Up to three action alarms are allowed.



The timer is in Product Key Hold Timer Programming Standby Mode.

PROGRAMMING THE (FASTIMER.)® MERIDIAN TIMER (STORE EMPLOYEE)

PRODUCT KEY PROGRAMMING

18 button controllers have two displays that show a full line of information; for example:

TIME **2:00**

10 button controllers have a single, dual-purpose display that will alternate information; for example:

TIME then **2:00**

RECIPE 1724 STORE EMPLOYEE

ENTER PROGRAMMING MODE.

Press and hold the P key for 3 seconds.

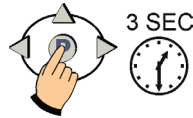

PROGRAM

Press the P key.

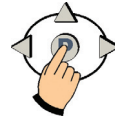

CODE

Type in 1 7 2 4 using the product keys. Press the P key.

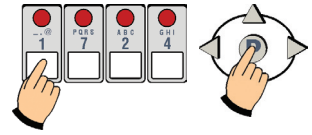

RECIPE

Press the P key. All product key LEDs will light up.

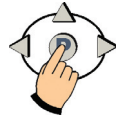

PRODUCT

PROGRAM A PRODUCT

KEY. Press the product key you want to program. Press the P key.

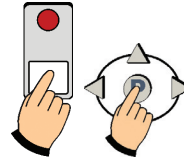

Some controllers may have different options listed.

Depending on model, you can either press the P key to change all programmable settings or you can scroll using the arrow keys to any of the specific options.

ALL

Press the P key.



NAME

XXXXXXXXXX

SET PRODUCT DISPLAY

NAME. NAME will be displayed then the actual product name. Use the up and down arrow keys to scroll through the library. Press the P key to lock in your choice.

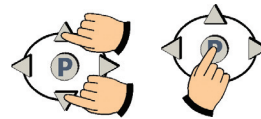

TIME 1

XX:XX

SET COOK TIME. Actual set time will be displayed. To change, press toggle clear to change the time to zero. Type in a new time using the product keys. Press the P key.

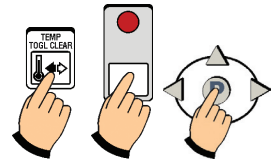

Some models have up to 3 action alarms.

ALTIME1
XX:XX

SET ACTION ALARM. Actual alarm time 1 will be displayed. To change, press toggle clear to change the time to zero. Type in a new time using the product keys. Press the P key.

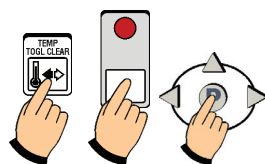

ALNAME1
XXXXXXXXXX

SET ACTION ALARM

NAME. ALMNAME1 will be displayed, then the actual action alarm name. Use the up and down arrow keys to scroll through the library. Press the P key to either go to next action alarm name, or continue through programming.

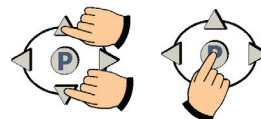

ALMNCNL1
AUTO
MANUAL

SET ALARM CANCEL. Use the left and right arrow keys to change from AUTO or MANUAL cancel. Then press the P key.

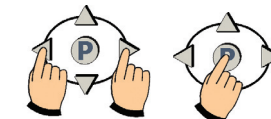

PROGRAMMING THE (FASTIMER.)[®] MERIDIAN TIMER (STORE EMPLOYEE) CONTINUED

PRODUCT KEY PROGRAMMING (CONTINUED)

ALRTONE1
XXXXX

SET ALARM TONE.
Use the left or right arrow keys to choose NONE, SHORT, MEDIUM, LONG, DOUBLE or LONG SHT as the alarm tone. Then press the P key.

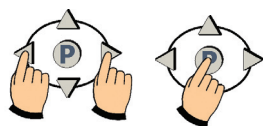

HOLDTIME
XX:XX

SET HOLD TIME. Actual hold time will be displayed. To change, press toggle clear to change the time to zero. Type in a new time using the product keys. Press the P key.

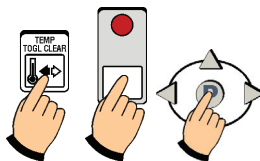

ALL

EXIT PROGRAMMING MODE. Press the up arrow key.



EXIT

Press the P key.

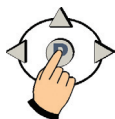

PRODUCT

Either press another product key to program and repeat the programming instructions, or exit by pressing the up arrow key.

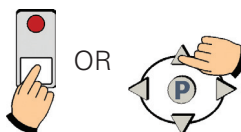

EXIT

Press the P key.



RECIPE

Press the up arrow key.



EXIT

Press the P key.



PROGRAMMING THE (FASTIMER.)® MERIDIAN TIMER (STORE MANAGER)

SYSTEM PROGRAMMING

SYSTEM 3228 STORE MANAGER

ENTER SYSTEM PROGRAMMING MODE.

Press and hold the P key for 3 seconds.

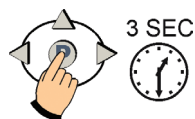

PROGRAM

Press the P key.



CODE

Type in 3 2 2 8 using the product keys. Press the P key.

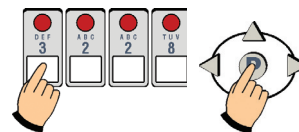

SYSTEM

Press the P key.



TONEVOL

SET TONE VOLUME. Use the left and/or right arrow keys to choose 1, 2, 3, 4 or NONE. Press the P key.

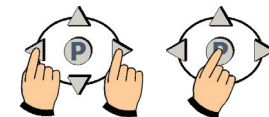

i Not all models have this feature.

COOKUNIT

MM:SS
HH:MM

SET TIME UNIT. Use the left and/or right arrow keys to choose Minutes/Seconds or Hours/Minutes. Press the P key.

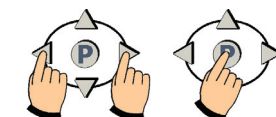

HOLDUNIT

MM:SS
HH:MM

SET HOLD UNIT. Use the left and/or right arrow keys to choose Minutes/Seconds or Hours/Minutes. Press the P key.

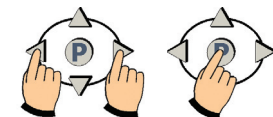

SYSTEM

EXIT SYSTEM PROGRAMMING MODE.

Press the up arrow key.



EXIT

Press the P key.



PROGRAMMING THE (FASTIMER.)[®] MERIDIAN TIMER (STORE MANAGER) CONTINUED

PROGRAMMING CUSTOM PRODUCT AND ACTION ALARM NAMES TO THE LIBRARY

SYSTEM 3228 STORE MANAGER

ENTER LIBRARY PROGRAMMING MODE.

Press and hold the P key for 3 seconds.

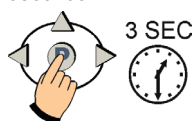

PROGRAM

Press the P key.



CODE

Type in 3 2 2 8 using the product keys. Press the P key.

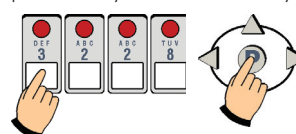

SYSTEM

Press the down arrow key to select either PRODLIBR OR ALRMLIBR.



PRODLIBR ALRMLIBR

Choose either PRODLIBR (Product Library) or ALRMLIBR (Action Alarm Library) by pressing the P key.



-

A flashing dash will be displayed. Press the SCAN key and use the product keys to spell a new word. Press the right arrow key to advance to the next character position.

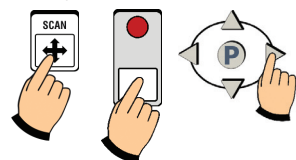

AB

Continue spelling the word. When done, press the P key.



ADD

TO SAVE WORD, press P again. Skip to Exit Library Programming.



ADD

CANCEL MODIFY

TO CANCEL OR MODIFY WORD, press the left or right arrow keys to select CANCEL or MODIFY.



IF YOU CHOOSE CANCEL:

CANCEL

Press the P key to EXIT and cancel the word.



PRODLIBR ALRMLIBR

EXIT LIBRARY PROGRAMMING. Press the up or down arrow keys until display reads EXIT.



EXIT

Press the P key.



IF YOU CHOOSE MODIFY:

MODIFY

Press the SCAN key to go back and modify the word.



EXIT

You have now EXITED System Programming Mode and can operate the controller.

HELPFUL INFO

TROUBLESHOOTING

PROBLEM	CAUSE	SOLUTION
No Power	Circuit breaker OFF	Check and reset.
	Appliance not plugged in	Plug in cord.
	Defective 24VAC transformer	Replace timer.
No Sound	Inoperable speaker	Replace timer.
Button Problem	Frozen key	Unplug timer. Hold down the TOGGLE/CLEAR key as you plug timer back in.
	Inoperable key	Replace timer.

PARTS & ACCESSORIES

DESCRIPTION	FAST PART NUMBER
Sheet Metal Bezel (Black)	214-50291
Sheet Metal Bezel (Stainless Steel)	214-50593
Slotted Round Head Screw, Black, 1/4-20 x 3/4"	150-10202
Slotted Round Head Screw, Stainless Steel, 1/4-20 x 3/4"	150-10188R
Tinnerman Spring Nut 1/4-20	150-11025

INDEX

Cleaning the Timer	2
Timer Operating Environment	2
Display Descriptions	5
Features	3
Features Explained	4
Installation	3
Notices	2
Operating the Timer	4
Action Alarms	4
Done Alarm	4
Holding Timers	5
View All Active Hold Times	5
Start a Cook Cycle	4
Stop a Cook Cycle	4
Programming Codes	3
Programming: (LIBRARY)	
Enter Library Programming	9
Exit Library Programming	9
Programming: (PRODUCT) Store Employee	6
Action Alarm	6
Action Alarm Name	6
Alarm Cancel	6
Alarm Tone	7
Cook Time	6
Enter Programming Mode	6
Exit Programming Mode	7
Hold Time	7
Product Display Name	6
Product Key	6
Programming: (SYSTEM) Store Manager	
Cook Unit	8
Enter System Programming	8
Exit System Programming	8
Hold Unit	8
Tone Volume	8
Support	
Customer Service and Technical Assistance	12
Free Program for Service Exchanges	12
Parts & Accessories	10
Troubleshooting	10
Warranty	12

Want to learn more about Kitchen Brains™ products?

Visit our website:
www.KitchenBrains.com



SCK Link® is a registered trademark of Technology Licensing Corporation and use is subject to the appropriate license agreement.



229-51325



KITCHEN BRAINS

Driven by **(FAST)** Networked by **SCK**

Food Automation - Service Techniques, Inc.

905 Honeyspot Road, Stratford, CT 06615-7147 USA

Phone: +1-203-377-4414

Sales: **1-800-FASTRON**

Fax: +1-203-377-8187

International Callers: +1-203-378-6860

www.KitchenBrains.com

Toll-free technical support 24/7 from the U.S.,

Canada, and Caribbean: **1-800-243-9271**

International offices are located in the United Kingdom, China and Singapore:

Europe, Middle East, Africa, South Asia
31 Saffron Court Southfields Business Park
Basilidon, Essex SS15 6SS ENGLAND
Phone: +44 0 1268544000

Asia Pacific
1803, 18F, No 922 Hengshan Rd
Shanghai 200030, CHINA
Phone: +8613916 854 613

15-101, Block 290G, Bukit Batok St. 24
SINGAPORE 65629
Phone: +65 98315927

WARRANTY

Kitchen Brains warrants all new timers, computers, and controllers for 1 year from the date of purchase including computers, controllers, and timers. Kitchen Brains warrants all other items for a period of 90 days unless otherwise stated at the time of purchase.

PATENTS

The products manufactured by Kitchen Brains are protected under one or more of the following U.S. Patents:

5,331,575	5,539,671	5,711,606	5,723,846
5,726,424	5,875,430	6,142,666	6,339,930
6,401,467	6,581,391	7,015,433	7,650,833
7,877,291	8,060,408		

Plus foreign patents and patents pending. Plus licensed patent 5,973,297

Customer Service and Technical Assistance

Our customer service department is available for orders and questions Monday through Friday between the hours of 8 AM and 5 PM EST. Call us toll-free at **1-800-FASTRON (800-327-8766)** if you're in the US, Canada or the Caribbean, or at **203-377-6860** if you're outside of these areas.

Toll-free technical assistance is available 24 hours a day, 365 days a year by calling **1-800-243-9271** (from the U.S., Canada and the Caribbean) when help is needed immediately.

You can also send an instant email message to a Kitchen Brains™ technician, Monday through Friday, 8am-5pm EST, by going to **www.KitchenBrains.com**, selecting the 'Support' link at the top of the page, and clicking on 'Contact Tech Support.'

Free Program for Service Exchanges

Kitchen Brains provides an Exchange Program, at no extra cost, if a unit should fail. In the event of failure, you have the option of (1) receiving a replacement product from our factory, freight prepaid; (2) exchanging the failed product for a replacement product at one of our authorized local service centers; or (3) selecting on-site repair or replacement of the failed unit by one of our authorized local service centers.

To take advantage of this program, simply call our toll-free customer service number, **1-800-243-9271**. If you elect to receive an exchange unit from the factory, a replacement unit will be sent immediately. Upon receipt of the replacement unit, simply return the failed unit to the factory, freight prepaid, using the same carton and packing material in which the replacement unit was shipped. The unit will be replaced free of charge, if still under warranty, and if the product shows no evidence of abuse or alteration. If the unit is not under warranty, you will pay repair charges and shipping costs to and from the factory.

Any minor adjustment or calibration and any labor costs for the replacement of probes will be made at your expense.

The Kitchen Brains™ Exchange Program is available to any Domestic Customer whose account is current, and applies to all Kitchen Brains™ Timers, Computers and Controllers.