



SPEC SHEET

KoolMore 39 in. Commercial 2-Glass Door Merchandiser Refrigerator, 21.9 cu. ft. in White

Model: KM-MDR-2GD-39

FEATURES

- Spacious Storage Capacity: 21.9 cu. ft. with eight adjustable plastic-coated steel shelves (99 lbs each).
- Double Tempered Glass Doors: Dual-pane LOW-E glass for insulation, visibility, and energy efficiency.
- Precise Digital Temperature Control: Digital thermostat, 34°F to 50°F range.
- Energy-Efficient and Eco-Friendly: 0.32 HP compressor, 971 KWH/year, bottom-mounted for efficiency.
- Bright LED Lighting: 13.8W middle beam LED for enhanced visibility.
- Durable Construction: Painted steel exterior and interior for durability and easy maintenance.
- Convenient Design: Four casters for mobility, adjustable legs, 24-inch depth for tight spaces.
- Secure Storage: Built-in safety lock for inventory protection.
- Wide Ambient Temperature Tolerance: Operates up to 100°F, ideal for commercial settings.
- ETL Certified & Warranty: Meets ETL standards, 1-year parts and labor warranty.



CLOSE UP IMAGES



TECHNICAL SPECS

Dimensions

Length	39.37
Height	77.56
Width	23.86
Interior Depth	18.9
Interior Width	35.83
Interior Height	50.59
Shelfwidth	17.17
Shelfdepth	16.61
Depth Excluding Handles	22.99
Depth Including Handles	24.65
Depth Less Door	20.75
Depth With Door Open 90 Degrees	40.63
Power Cord Length	66
Minimum Back Air Clearance In	20 in.
Minimum Side Air Clearance In	20 in.

Capacity

Gross Cubic Feet	21.9
Net Cubic Feet	21.19
Individual Shelf Capacity	99 lbs.

Features & Materials

Door Style	Swing
Number Of Doors	2
Number Of Shelves	8
Defrost Type	No Frost
Refrigerant Type	R-290
Temperature Control Type	
Temperature Range	34-50 F
Ambient Temperature Range	100 F
Casters	4
Interior Material	Prepainted Steel
Exterior Material	Prepainted Steel
Shelf Material Type	Coated Steel
Noise	60

Electric & Certifications

Amps	4
Phase	1
Voltage	115
Wattage	460
Hertz	60
Plug Type	NEMA 5-15P
Certifications	ETL Listed for Safety and NSF Certified for Sanitation

Plan View

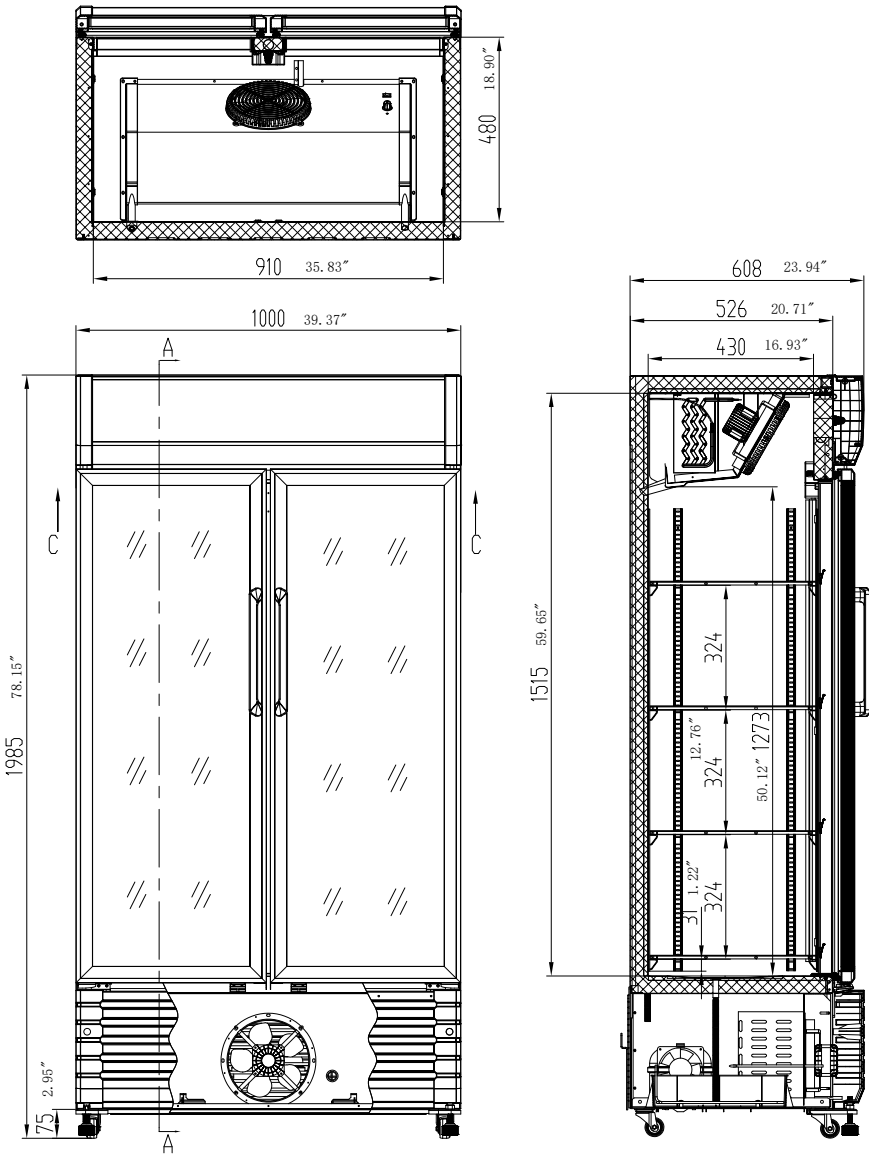

CERTIFICATIONS

Two ETL certification logos from Intertek. The first is labeled 'ETL LISTED US' and the second is labeled 'ETL CERTIFICATION LISTED'.



706 Eastern Parkway STE 1G, Brooklyn NY 11213
 718-576-6342
 info@koolmore.com