



# SPEC SHEET

## KoolMore 71 in. Two Door Commercial Pizza Prep Refrigerator in Stainless-Steel

Model: KM-RPPS-2DSS

### FEATURES

- Stainless-Steel Construction
- Temperature Range:33°F-40°F
- Auto/Cycle Defrost
- Side-Mounted Compressor
- ETL Certification
- Built-In Full-Length Cutting Board
- Expanded Cold Storage Space
- Protective Rail Lid Food Cover



### CLOSE UP IMAGES



# TECHNICAL SPECS

## Dimensions

Length	70.86
Width	31.49
Height	39.45
INTERIOR DEPTH	27.16
INTERIOR WIDTH	48.58
INTERIOR HEIGHT	22.91
DEPTH EXCLUDING HANDLES	31.49
DEPTH INCLUDING HANDLES	31.49
DEPTH WITH DOOR OPEN 90 DEGREES	55.56
DEPTH LESS DOOR	31.49
HEIGHT TO TOP OF DOOR HINGE IN	33
POWER CORD LENGTH	98
MINIMUM BACK AIR CLEARANCE IN	2 in.
MINIMUM SIDE AIR CLEARANCE IN	2 in.
Weight Lbs	431

## Capacity

GROSS CUBIC FEET	19.32
NET CUBIC FEET	16.85

## Features & Materials

COOLING UNIT TYPE	Automatic
NUMBER OF SHELVES	2
TEMPERATURE RANGE	33 - 40 F
AMBIENT TEMPERATURE RANGE	90 F
TEMPERATURE CONTROL TYPE	External Digital
SHELF MATERIAL TYPE	Wire
SHELVES ADJUSTABLE	Yes
EXTERIOR MATERIAL	Stainless-Steel 430
INTERIOR MATERIAL	Stainless-Steel 430
COLOR DOOR HANDLES	Black
COLOR FINISH	Stainless-Steel
COUNTER DEPTH	No
DEFROST TYPE	Automatic
NUMBER OF DOORS	2
DOOR STYLE	Swing
HINGE LOCATION	Front
REFRIGERANT TYPE	R-290

## Electric & Certification

HERTZ	60
VOLTAGE	120
PHASE	1
AMPS	5.5
WATTAGE	389
PLUG TYPE	NEMA 5-15P
CERTIFICATIONS	ETL Listed for Safety and Sanitation

# Plan View

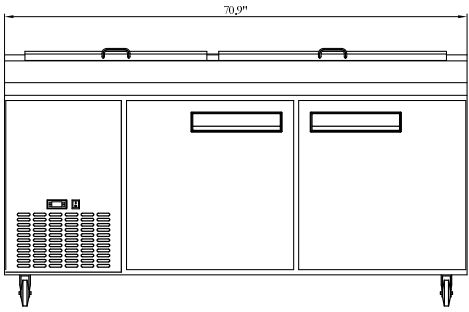

ELEVATION

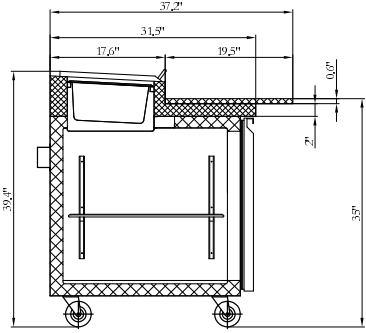

SECTION VIEW

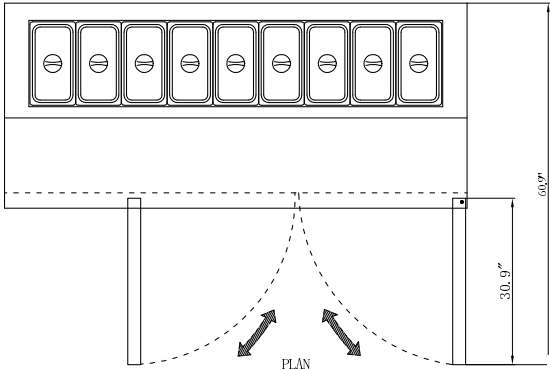

PLAN

**CERTIFICATIONS**



706 Eastern Parkway STE 1G, Brooklyn NY 11213  
 718-576-6342  
 info@koolmore.com