

### General Information

Project Name: \_\_\_\_\_

Consultant: \_\_\_\_\_

Item #: \_\_\_\_\_

Model #: \_\_\_\_\_

Quantity: \_\_\_\_\_



Shown w/o  
Tray Rail



Model #MNC  
Nylon Cylinder



Model #MSC  
Perforated S/S  
Cylinder

### Specifications

**Body:** Constructed of 16GA type 304 stainless steel. The top is sloped for easy access to contents in cylinders. The top has pressed holes to receive cylinders. All holes have a  $\frac{3}{16}$ " lip turned down for added strength and durability. All pressed units have a 1" diameter 16GA type 304 stainless steel push handle w/ bumpers. Unit has a 18GA S/S fixed intermediate shelf for extra storage space. Back of the unit is open for easy access to supplies.

**Casters:** The dispenser is mounted on (4) 5" diameter casters, (2) swivel, and (2) with brakes.

**Perforated Cylinders:** Nylon Cylinders included. Optional S/S cylinders are available. Cylinders easily drop in and are included w/ unit.

### Product Guide

IMC Silverware Dispensers are the perfect way to offer high-volume storage for your silverware and utensils.

They are also useful for protecting your silverware from abuse and misplacement. Ideal for cafeterias, buffets or large dining areas.

The attractive stainless steel design outlasts basic plastic dispensers and acts as a superior alternative.

### Options



SD16H-70 1122

## DRAWINGS

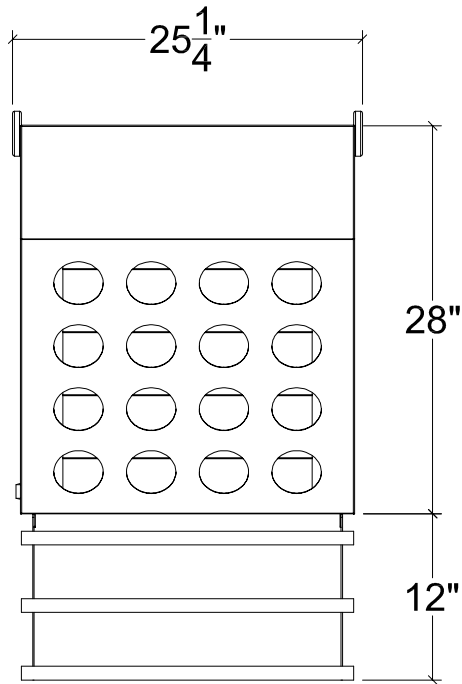

PLAN

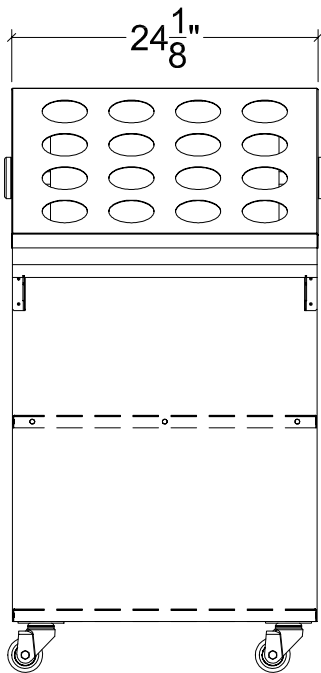

ELEVATION

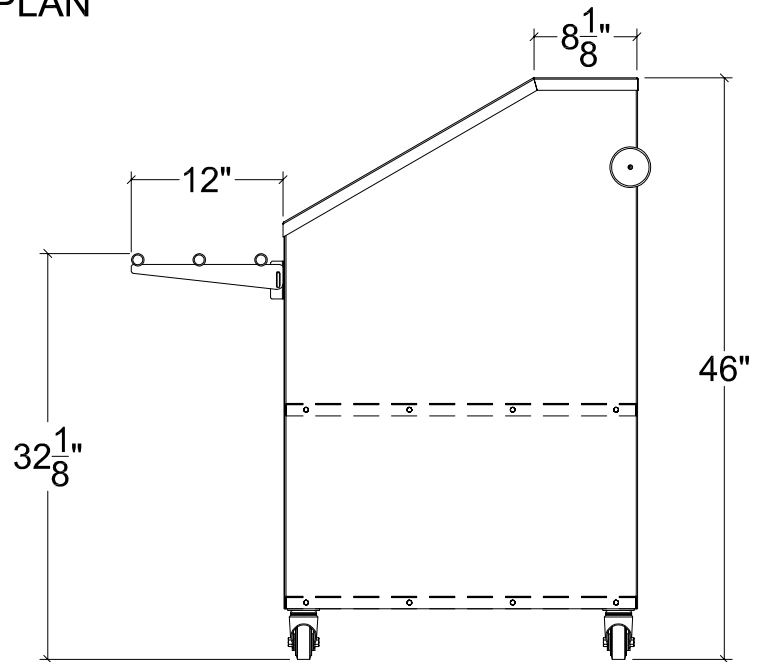

SECTION

## SILVERWARE DISPENSERS

Model	Size (W x L x H)
□ SD16H	24 $\frac{1}{8}$ " x 28" x 46"

Specifications subject to change without notice.

SD16H-70 1122