

Transmission, reproduction, utilization and communication of these technical data are not permitted unless expressly authorized by MIWE. Any noncompliance will result in obligation to pay damages. All rights reserved in the event of a patent grant or registration as a utility model.

MIWE gusto Type GU 3.0403 DUO

with steam hood, steam condenser and underframe

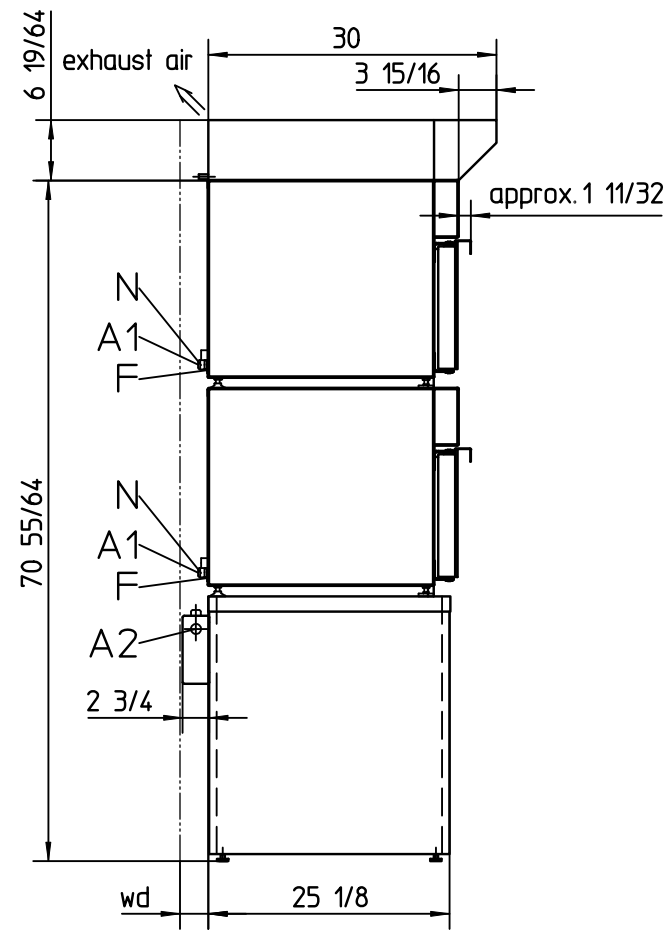
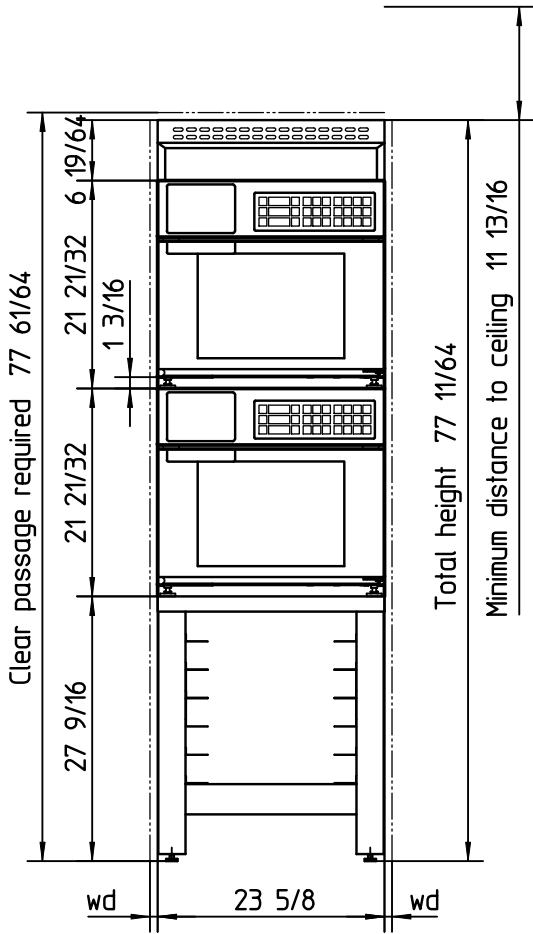

wd: Necessary minimum distance to wall:
 to the side 25/32
 to the rear side 2 23/64 (with F: 4 23/32)

* The customer should not install any covering in this area!

Note:
 The door hinge (on the left or the right side) is to be carried out according to the order!

- A1 Water discharge 3/4-hose
 -for model with CC with drain to on-site pipe -not to siphon
- A2 Water discharge 1 7/64
- N Power supply 3,4 kW (2x20A) **
- F Fixed water supply R3/4" (optional)
- W Water supply R3/4"

** Protection by fuses with 208V; 3/-/PE; 60Hz

Water discharge provided by customer:
 minimum nominal diameter 1 31/32!

Total weight without baking trays: approx. 206kg

Attention!
 The use of air-cooled steam condenser in small rooms may lead to a significant increase in room temperature.

We reserve the right to change any technical specifications!

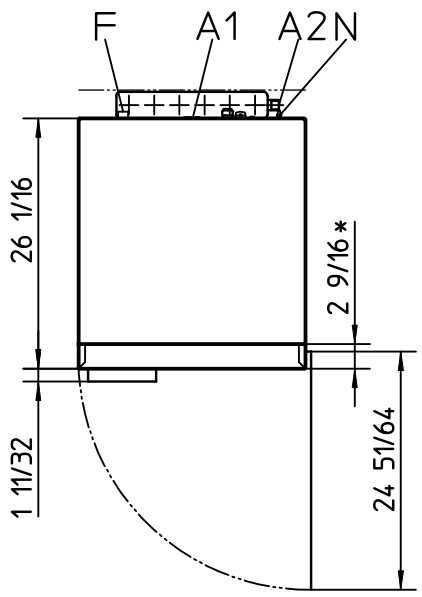

Datum	09.03.16	Name	Rumpel	Maßstab	1:20
Bearbeiter	15.01.19	Schn. Mi.	Schn. Mi.	Freig-Stat	
Geprüft	15.01.19	Schn. Mi.	Schn. Mi.		
Freigegeben					