

ITEM #: _____ QUANTITY: _____
MODEL #: _____
PROJECT NAME: _____



EUROBAR HAND SINK

MODEL NUMBER

EBCDS | EuroBar 12" Hand Sink

DIMENSIONS (L X W X H)

12" x 24" x 36"

FEATURES

- Standard left and right splash guards
- Tilting paper towel holder
- Cabinet body with door for storage
- Faucet and soap dispenser shipped loose for field installation
- Side panels are notched and floor is open at the back for easy utility routing
- Quality construction: 304 Stainless steel with 14ga Top/18ga Cabinet body and 6" stainless steel legs
- Made in the USA; NSF Approved

ACCESSORIES (OPTIONAL)

- Main Work Station
- Craft Dump Sink
- Under bar Liquor Display
- Blender Station with Dump Sink
- POS Station
- Trash Bin Cabinet
- Soda Gun Filler Section
- Spice Caddy

DIMENSIONAL INFORMATION

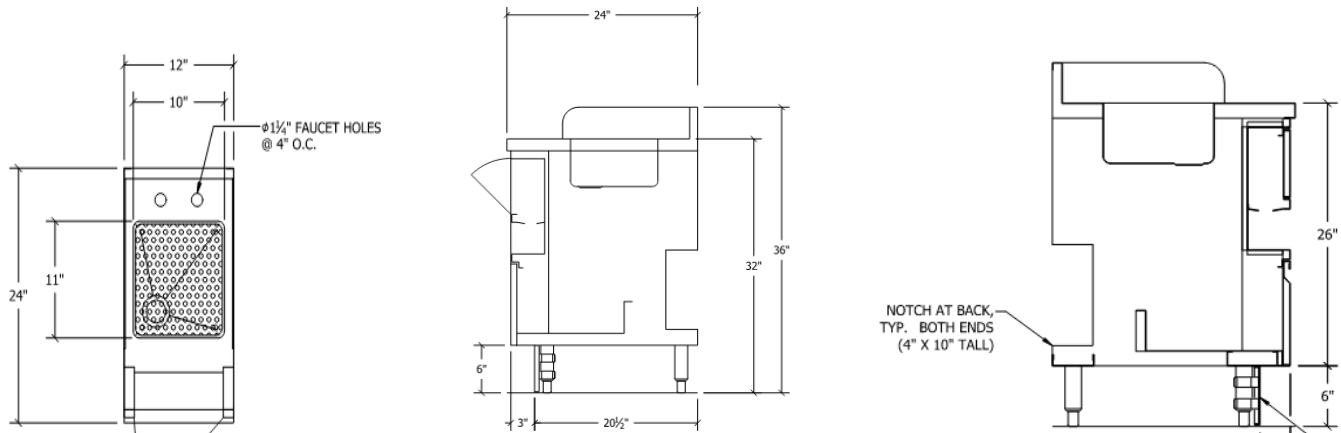

BUILD YOUR EUROBAR

Customize your EuroBar with a variety of modules and accessories at eurobarstation.com/resources



EUROBAR HAND SINK SPECIFICATION SHEET