



# G319 HC SS VERTICAL COOLER

ESTABLISHING A **NEW STANDARD** IN THE FOODSERVICE INDUSTRY.

Energy efficient, eco-friendly HC refrigerant with low charge, spark-free components, and the lowest utility costs in its category.



\*optional insight lock

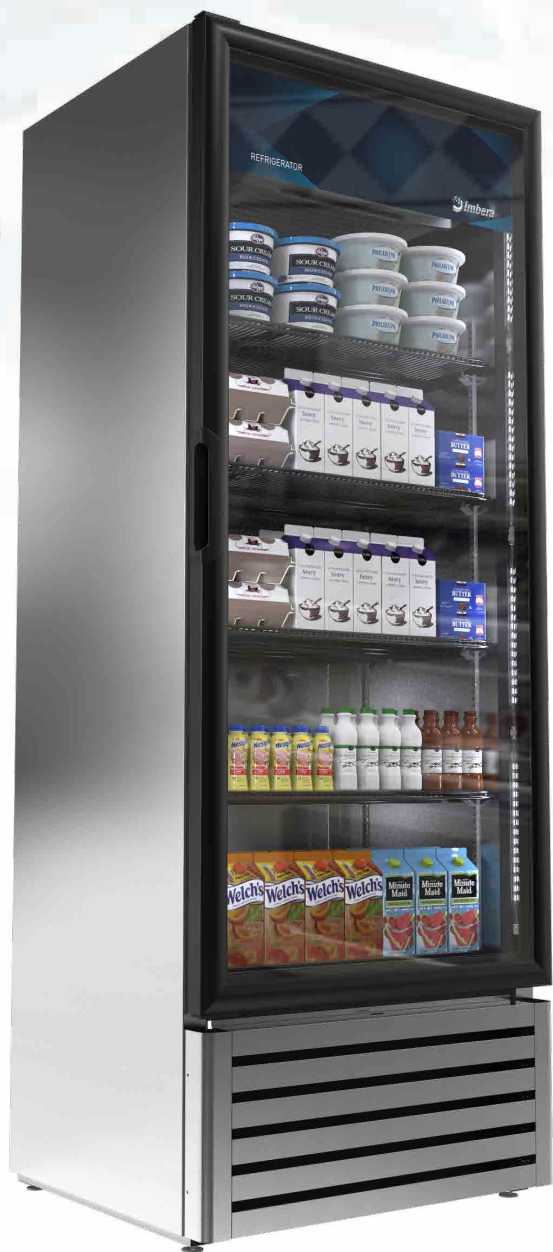

## KEY FEATURES



• **Eco-Friendly Refrigerant**  
Environmentally friendly hydrocarbon refrigerant has low Global Warming Potential (GWP). Meets all USA & California refrigerant & energy standards.



• **Electronic Temperature Controller**  
Patented ETC1H electronic controller assures optimal refrigeration performance through precision temperature control, and intelligent control for defrost cycle, compressor & other component functions.



• **High Power Reliable Refrigeration System**  
Fast pull down, optimal internal air circulation and reliable refrigeration, maintaining colder temperatures for food preservation.



• **Newly Designed Condenser**  
New condenser featuring a joints reduction down to zero increasing long term refrigeration reliability and safeguarding against any system leaks.



• **Standard LED Lighting System**  
Ultra bright low energy interior LED illumination system provides optimal merchandise display visibility. Low profile, door mounted, clip-in LED design.



• **Spark-Free Refrigeration Components**  
All Reach-In models will have spark free refrigeration components for optimal safety, per UL requirements.



ESTABLISHING A **NEW STANDARD** IN THE FOODSERVICE INDUSTRY.

### PRODUCT VIEWS

#### TOP VIEW

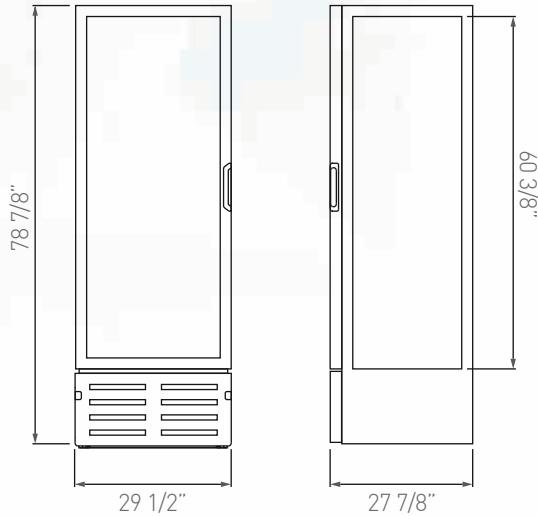
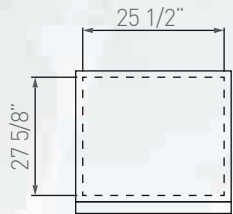

### ADDITIONAL FEATURES



> Health Lock - INSIGHT Bluetooth & WiFi enabled lock option for unattended food locations. (See INSIGHT spec sheet for details)



> Manual Lock - External lock available



> Gravity kit - Display technology beverage Visi-Slide



> Casters and legs available



> Price Kit - Available for shelf display

#### Customer service and warranty

Three year limited warranty, includes parts and labor.

An additional two year warranty is issued on the compressor (USA & Canada only).

Operators must follow installation and operational guidelines per Imbera Users Manual.

Each cooler must be connected directly to a single power supply, otherwise warranty will be voided.

Customer service: 866.548.5770

### TECHNICAL SPECIFICATIONS

#### Exterior Dimensions

H: 78 7/8" 201 cm  
W: 29 1/2" 75 cm  
D: 27 7/8" 71 cm

#### Interior Dimensions

H: 60 3/8" 154 cm  
W: 25 1/2" 65 cm  
D: 27 5/8" 55 cm

#### Usable Interior Capacity

H: 52 7/8" 134 cm  
W: 24 3/8" 62 cm  
D: 19 1/8" 48 cm

#### Usable Volume

19.2 ft<sup>3</sup>  
543.7 lts

Doors	Door construction	Shelves	Shelves Size	
1	Plastic frame	5	W: 24 3/4"	63 cm
			D: 19 5/8"	50 cm

**External Material** 430 Stainless Steel

**Internal Material** 201 Stainless Steel

### REFRIGERATION PERFORMANCE DATA

#### Refrigerant

R290 2.3 Oz (0.065 kg)

#### Energy Consumption

1.820 kWh/24h

#### Compressor Power

1/3 HP

#### Condenser

Finless (low maintenance)

#### Thermostat setting default

**Cut-Out**  
32°F [0°C]

**Cut-In**  
44.6°F [7°C]

### ELECTRICAL DATA

#### Power supply

115V/60 Hz

#### AMPS

7.0 A

#### Lighting

257.6 Lux Output  
9 modules  
8 LED per module

#### Plug Type

NEMA 5-15P

#### Controller

ETC1H

#### Cord length

118" [3000 mm]

### LOGISTIC DATA

#### Trailer Loads

53': 60

#### Unit weight with packaging

240.5 lb 109.1 kg

#### without packaging

223.7 lb 101.5 kg

#### Dimensions w/packaging

H: 82 1/4" 209 cm

W: 32 1/8" 82 cm

D: 32 5/8" 83 cm

\*Energy consumption based on ANSI/ASHRAE Standard 72-2005

\*BMAD System (Low maintenance high performance)

\*Dimensions rounded up to the nearest inch or centimeter

\*Specifications subject to change without notice

\*H: Height, W: Width, D: Depth

07/09/2021