

# Specification

## HPC7101-S9DF9(TD)

### Insulated Heater Proofer Pass-Through



- ◆ Designed for proofing and heating.
- ◆ Four doors design reduce the loss of Heat and energy saving in cost.
- ◆ All digital display and controls.
- ◆ Machined Zinc Alloy handle
- ◆ Adjustable thermostat for a variety of warming temperatures.
- ◆ Holding temperature up to 185 F.
- ◆ Water pan provides moisture for proofing.
- ◆ Humidity up to 95%(under 90F)
- ◆ Universal rack system can hold both full size Sheet pans (18"x26") as well as hotel steam pans.
- ◆ High quality 5" casters, two with safety-lock
- ◆ Aluminum cabinet.
- ◆ Stainless steel solid door

Note: Dimensions and Specification are Subject to change without notice.



**Intertek**  
CONFORMS TO NSF/ANSI 4

This full-size Heater Proofer cabinet can hold up to 15 18" x 26" full size pans, as well as a variety of others. Offering the ability to proof a variety of baked goods, allowing dough to rise before baking. All digital temperature controls with easy set up. Enables a variety of temperatures, including warming. Designed with enduring quality in mind.

# Dimensions and Specifications

## HPC7101-S9DF9(TD) Pass-Through



Front View

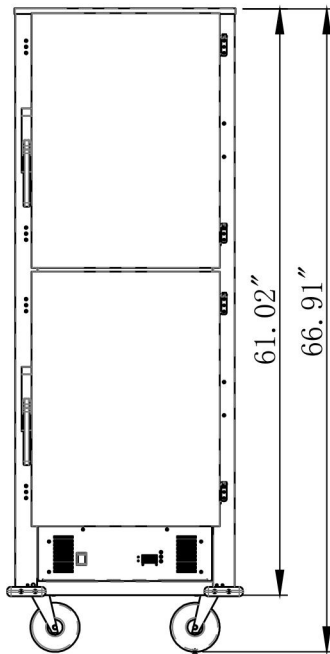

Side View

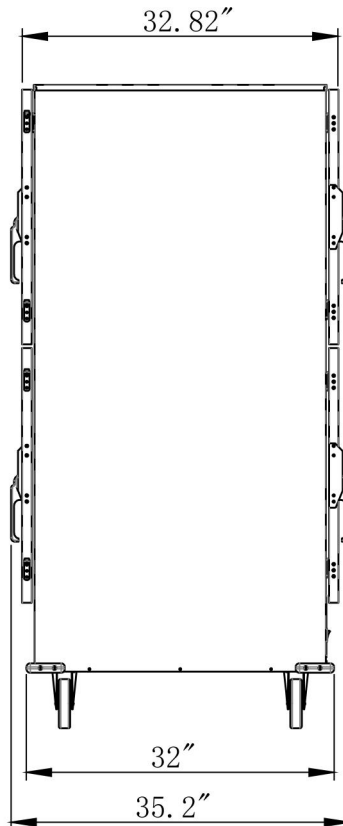

Top View

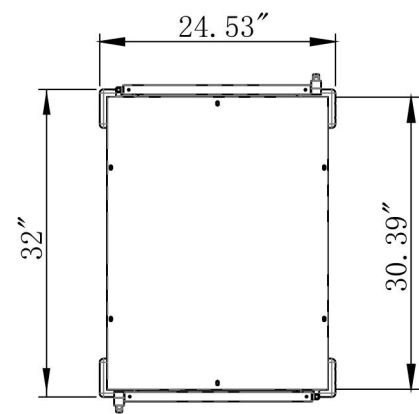

Pan Capacity	<p>Universal Rack System                      15 story, 18"x16", 12"x20", 16"x20"                      13"x18", 14"x18"</p> <p>Holds up to 18" Pizza Box 2.5" 2-1/2" high                      Accommodates hotel pans</p>
Electrical	120 Volts
Power	1500 Watts
Net weight	230 lbs.
Gross shipping weight	261 lbs.
Class	100
Dimensions	24.53"W X 35.2" D X 66.91" H
Package	25" W X 36" D X 68" H
Warranty	1Year Manufactures limited Warranty