



Features

- Rim ring for wok ranges
- Hand crafted
- 3 openings for oxygen
- 4 mounting holes
- All welded seam for max durability



Description **Steel Rim**

Wok range rim made from steel, making it extremely durable even after hard commercial usage. This wok range rim is perfect to replace the worn out wok ring for restaurant, kitchen, hotel and buffet. Comes with mounting screws to securely mount it to the wok well edge making it easy to exchange the worn out wok ring. This rim has 3 openings, which provides oxygen to ignite the fire giving the wok the perfect fire level to cook.

Plan View **WR-CIRxxA**

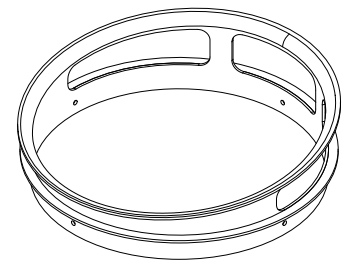
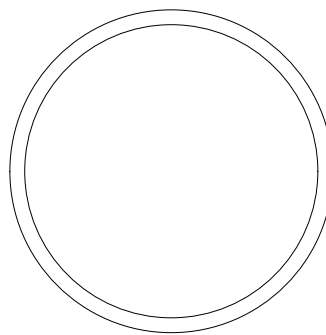
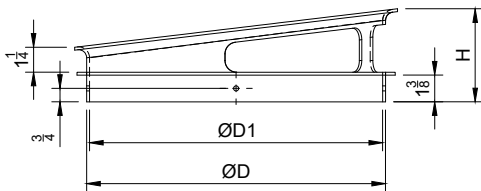

Order No.	ØD (in/mm)	ØD1 (in/mm)	H (in/mm)	G. W. (lb)
WR-CIR13A	13-1/4 (337)	12-1/8 (308)	4-3/8 (110)	8
WR-CIR14A	14-1/4 (363)	13-1/8 (333)	4-1/2 (113)	9
WR-CIR16A	16-1/4 (414)	15-1/8 (384)	4-3/4 (119)	10
WR-CIR18A	18-1/4 (464)	17-1/8 (434)	5 (127)	11
WR-CIR20A	20-1/4 (514)	19-1/8 (486)	5-1/4 (131)	12
WR-CIR22A	22-1/4 (565)	22-1/8 (537)	5-1/2 (137)	13