

Energy efficient, eco-friendly hydrocarbon refrigerant with low charge, spark-free components, providing the greatest reliability. Designed with detailed quality to meet all food safety requirements of the foodservice industry



## KEY FEATURES



### **Electronic Temperature Control**

Ensures optimal equipment performance by maintaining products at the ideal temperature for consumption.



### **Eco Friendly Refrigerant**

Environmentally friendly hydrocarbon refrigerant has low Global Warming Potential (GWP). Meets all USA refrigerant and energy standards



### **Electronic Fan Motors**

These motors provide improved performance by using only a fraction of the energy required by shaded pole motors.

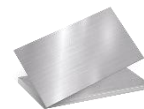

### **Stainless Steel Material**

High quality material for food preservation, complying with safety and hygiene standards.

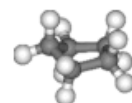

### **Cyclopentane Insulation Foam**

It is ecofriendly as it does not contain CFC (Chlorofluorocarbons) or HFC (hydrochlorofluorocarbons) and is a highly efficient insulator.



### **Pans**

Includes twelve (12) 1/6" size pans (4" deep)

## TECHNICAL SPECIFICATIONS

Exterior Dimensions	Interior Dimensions	
H: 41 3/4" 106 cm	H: 25 7/8" 66 cm	
W: 48 1/8" 122 cm	W: 43 1/2" 110 cm	
D: 30 7/8" 78 cm	D: 20 7/8" 53 cm	

Doors	2
Door construction	Solid stainless
Shelves	2
Shelves Size	9 3/4" 24.8 cm 20 3/4" 50.2 cm
External Material	Stainless Steel
Internal Material	Stainless Steel

## REFRIGERATION PERFORMANCE DATA

Refrigerant	R290 3.4 Oz (0.070 kg)	
Energy Consumption	2.803 kW/24h	
Compressor Power	1/4 HP	
Condenser	Dynamic	
Thermostat setting default	32.9°F (0.5°C)	41°F (5°C)

## ELECTRICAL DATA

Power supply	115V / 60 Hz	
AMPS	3 A	
Cord length	118.11" (300 cm)	
Lighting	NA	
Plug type	NEMA 5-15P	
Controller	CIR EVO 2V0	

## LOGISTIC DATA

Trailer Loads	53": 58		
Unit weight	Gross		Net
	151.25 kg	333.45 lb	132.15 kg 291.34 lb
Dimensions w/packaging	H: 46" 3/4	118.9 cm	
	W: 52 7/8"	134.6 cm	
	D: 33 7/8"	86.2 cm	

## PRODUCT VIEWS

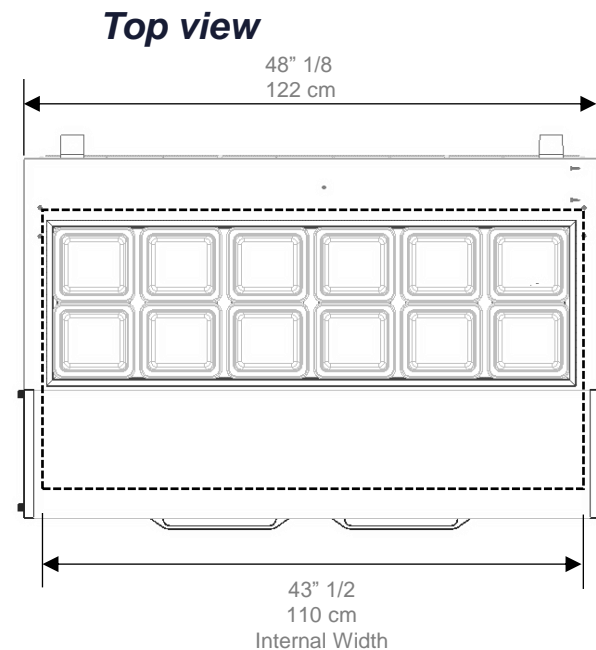

**Front view**

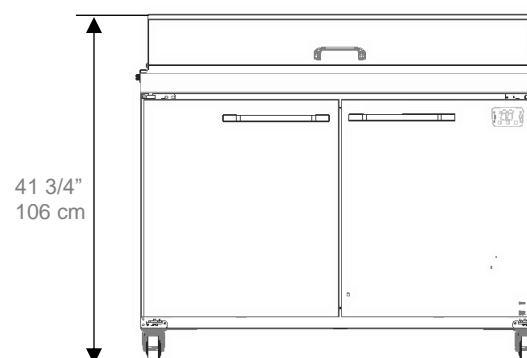

**Side view**

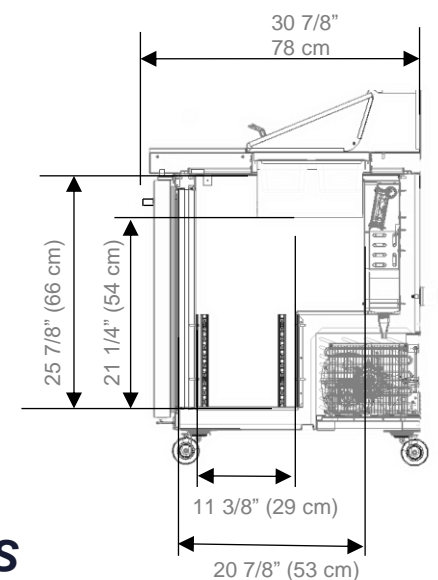

## ADDITIONAL FEATURES



**1/6" size pans (6" deep)  
(Optional)**

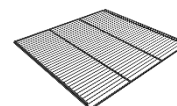

**Black Shelves**



**Pre - installed Casters**

\*Energy consumption based on ANSI/ASHRAE Standard 72-2005

\*BMAD System (Low maintenance high performance)

\*Dimensions rounded up to the nearest inch or centimeter

\*Specifications subject to change without notice

\*H:Height, W:Width, D:Depth

### Customer Service and warranty

Five years limited warranty, includes parts and labor.

An additional two warranty is issued on the compressor (USA & Canada only).

Operators must follow installation and operational guidelines per Imbera Users Manual.

Each cooler must be connected directly to a single power supply, otherwise warranty will be voided.

Customer service: 866.548.5770