

Elevated
space
for
better
taste

EuroBar[®]

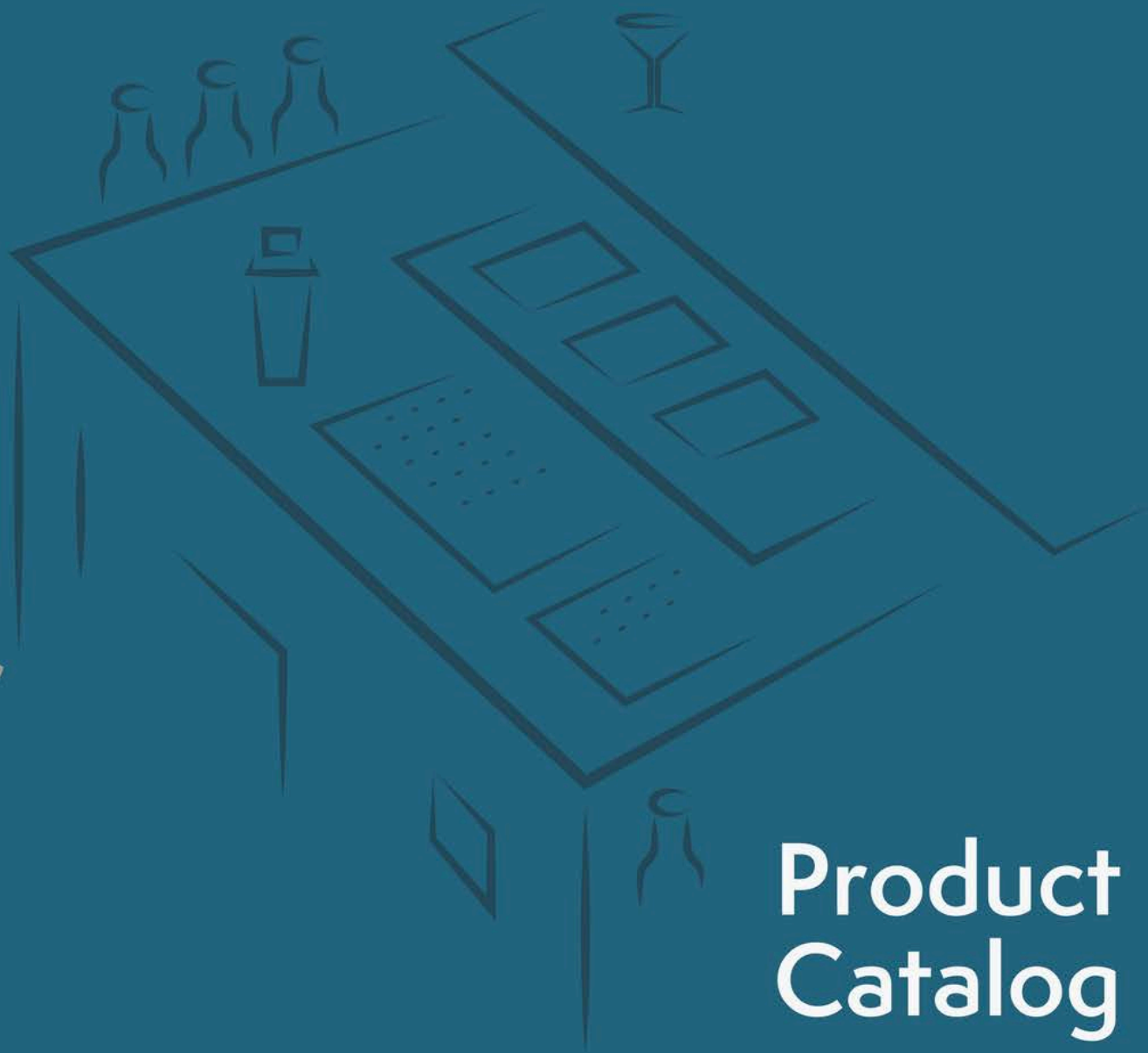

Product
Catalog



EUROBAR STORY

The EuroBar® design was inspired by European tradition and built with American bartenders in mind. It all started with a drawing on a napkin, where Livio Lauro sketched out his ideal bar.

MEET OUR FOUNDER

Livio Lauro

**Director of Mixology | Author | Entrepreneur | Certified Mixologist |
Past President – USBG**

After working as a bartender in both Italy and the United States, Lauro became the Director of Mixology at Southern Glazer's Wine and Spirits in 2001. Livio helped revive the United States Bartenders' Guild and served as the founding president of the Guild's Master Accreditation program, a premier certification for bartenders in the United States.

- Founder and host of Master Your Glass, a weekly show on YouTube
- Author of three books on drinks and hospitality
- Beverage Hospitality Professor at UNLV
- Involved in the opening of over 1000 new bars
- Trained / Mentored over 10,000 professional bartenders
- 2020 initial design of the EuroBar began





OUR PHILOSOPHY

At EuroBar, our vision is to redefine the International hospitality scene by combining the elegance of European bars with the efficiency of American design. EuroBar isn't just about quality; it's about bringing a unique style that elevates the guest experience.

HOSPITALITY PHILOSOPHY

Built for the world's most refined hospitality environments—allowing guest engagement, and the seamless flow of service.

MINDFUL DESIGN

Visually sophisticated bar equipment, balancing performance with elegance. Designed by a bartender, for bartenders. Customization available to tailor to resort bar design.

EQUIPMENT FOR ALL GUEST EXPERIENCES

From world-class dining, intimate cocktail lounges, cafe's to poolside refreshments, EuroBar bar stations—Alto, Classico, Sportivo, Cafe and Svelto - tailored to every venue and guest experience across the Wynn Resort portfolio.



OUR PHILOSOPHY

At EuroBar, our vision is to redefine the International hospitality scene by combining the elegance of European bars with the efficiency of American design. EuroBar isn't just about quality; it's about bringing a unique style that elevates the guest experience.

Built for the world's most refined hospitality environments—allowing guest engagement, and the seamless flow of service.

EQUIPMENT FOR ALL GUEST EXPERIENCES

From world-class dining, intimate cocktail lounges, cafe's to poolside patio bars, EuroBar bar stations—Alto, Classico, Sportivo, Cafe and Svelto - tailored to every venue and guest experience.

EuroBar[®]



WHY EUROBAR?



CUSTOMIZEABLE LAYOUT

Our modular stations allow operators to personalize their bar with as many modules as needed, in various sizes and sequences to suit their unique operations.



QUALITY CONSTRUCTION

All underbar items are made with 304-grade stainless steel. Our equipment is easy to wipe clean, sanitize and resists rust and corrosion. Proudly made with 14-gauge top / 18-gauge base.



DESIGNED FOR EFFECTIVENESS

All EuroBar stations provide bartenders with ample storage for ingredients and small wares thanks to their cabinet bases. This extra storage enables them to create a broader range of beverages while eliminating unsightly objects in the view of bar patrons.



DESIGNED BY AN EXPERT BARTENDER

All EuroBar equipment is designed by internationally acclaimed bartender Livio Lauro who has trained thousands of bartenders. Livio has spent over three decades working alongside the foremost global hospitality groups helping them put together successful bars and profitable cocktail programs.



SEAMLESS DESIGN

Our units offer a unique look with no units sticking up too high or out in comparison to the ones next to them. Your bar will look clean and slick with all the cabinets and stations aligning seamlessly.



TALLER UNITS

Easy to work on: Our taller units reduce the need for the Bartender to hunch down

EuroBar[®]

ABOUT EUROBAR

EuroBar is a cutting-edge bar equipment company with three unique bar stations that have been designed by renowned cocktail expert Livio Lauro. All the EuroBar stations represent the perfect blend of a European simplicity and American effectiveness.

What makes a bar European designed?

Traditional European designed bars include cabinet base throughout, consistent height and depth to create clean lines, and a clever way to organize smallwares.



OUR THREE BAR STATIONS SAMPLE LAYOUTS



EuroBar | *Classico*™



EuroBar | *Sportivo*™



EuroBar | *Alto*™

CLASSICO MAIN WORKSTATION:

Features:

- Integrated basin for six iced condiment trays
- Rinser and drainboard
- Rectangular dipper well
- Trash chute with internal trash can (sold separately)
- Eight bottle quick-grab drawer
- Cabinet base for storage

Construction:

- Consistent height of 32" and depth 24" for seamless integration with other EuroBar units
- Corrosion resistant 304 grade stainless steel throughout
- Durable 14-gauge top / 18-gauge body

Layout:

- Dry waste chute at arm's reach
- Cabinet fits a 28 qt / 7-gallon trash bin
- Ice bin module is set to the side of the prep area preventing any spilling of ingredients or contamination into the ice
- Includes two recessed hand towel and bar rag caddies. The bottle drawer allows the bartender to easily prepare drinks without the speed rack on the main station pressing into knees and legs (or pour spouts rubbing on their pants).

EUROBAR | CLASSICO™



The perfect blend of European design and American efficiency.

EUROBAR | CLASSICO™

SAMPLE LAYOUT



ADDED STORAGE

Cabinet base and drawers on all modules add storage and hide plumbing.



OUTDOOR READY

Corrosion-resistant 304 grade stainless steel throughout



CHEFS COUNTER

Counter for bartenders with added prep area



QUALITY CONSTRUCTION

14-gauge top and 18-gauge base

EuroBar®

SPORTIVO MAIN WORKSTATION:

Features:

- Integrated basin for six condiment trays
- Rectangular Dipper Well
- Insulated Ice Bin with cold plate
- Recessed 12-Bottle Speed Rail
- Eight bottle quick-grab Drawer
- Cabinet base for storage

Construction:

- Consistent height of 32" and depth 24" for seamless integration
- Corrosion resistant 304 grade stainless steel throughout
- Durable 14-gauge top / 18-gauge body
- Available in 48" or 36" modules

Layout:

- Bottle Storage Capacity: 13 bottle speed rail, 8 bottle quick-grab drawer.
- Center Station also provides a drink prep area that can be converted into an insulated drained juice well
- Center 24" ice bin with 90 lbs. of ice
- Center speed rack for optimal space usage and easy product grab with left and right hands

EUROBAR | SPORTIVO™



This Sporty Chic unit mixes speed and elegance.

EUROBAR | SPORTIVO™

SAMPLE LAYOUT



ADDED STORAGE

Cabinet base and drawers on all modules add storage and hide plumbing.



OUTDOOR READY

Corrosion-resistant 304 grade stainless steel throughout



HIGH VOLUME USE

Great for service bars stations and higher volume bars



QUALITY CONSTRUCTION

14-gauge top and 18-gauge base

EuroBar®

ALTO MAIN WORKSTATION:

Features:

- Six integrated iced condiment trays with cover
- Rectangular dipper well
- Recessed glass rinser
- Recessed nook for clean shakers
- Trash chute with internal trash can (sold separately)
- Eight bottle quick-grab drawer
- Utility drawer for bar accessories and other miscellaneous items

Construction:

- The Alto Main Workstation: Height 42" x Length 36" x Depth 24" to create a uniform height with bar and guest
- Corrosion resistant 304 grade stainless steel throughout
- Durable 14-gauge top / 18-gauge body

Layout:

- Ice bin module is set to the side of the prep area resulting in no spilling of ingredients or contamination into the ice

EUROBAR | ALTO™



This station brings the cocktail mixing show to the guests.

EUROBAR | ALTO™

SAMPLE LAYOUT



ADDED STORAGE

Cabinet base and drawers on all modules add storage and hide plumbing.



OUTDOOR READY

Corrosion-resistant 304 grade stainless steel throughout



IMMERSIVE EXPERIENCE

Main station is level with bar to create a unique guest experience



QUALITY CONSTRUCTION

14-gauge top and 18-gauge base

EuroBar®

New
EUROBAR | SVELTO™
MOBILE BAR



FEATURES

EuroBar Svelto is an elevated 60" Mobile Bar that is built for elegance and versatility.

Produced with 304 Stainless steel and a 14-gauge top / 18-gauge body for heavy-duty and indoor-outdoor use. This makes it an ideal choice for rooftops, patios, or anywhere you wish!

Loaded with space for glass racks, disposables, dry goods, sodas, with two drainboards, dump sink, tool caddy, recessed ice scoop, bottle well, ice chest, and a dry dump sink.

EUROBAR | SVELTO™

MOBILE BAR

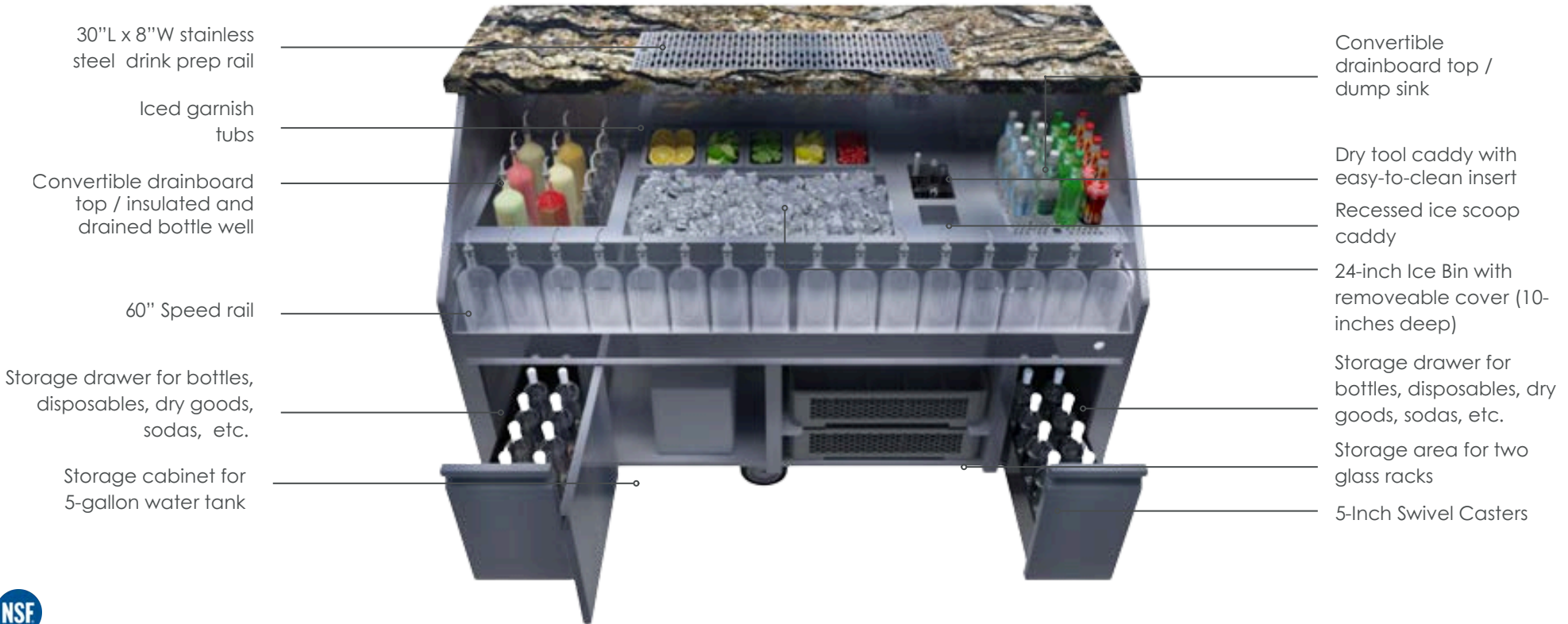

30"L x 8"W stainless steel drink prep rail

Iced garnish tubs

Convertible drainboard top / insulated and drained bottle well

60" Speed rail

Storage drawer for bottles, disposables, dry goods, sodas, etc.

Storage cabinet for 5-gallon water tank

Convertible drainboard top / dump sink

Dry tool caddy with easy-to-clean insert

Recessed ice scoop caddy

24-inch Ice Bin with removeable cover (10-inches deep)

Storage drawer for bottles, disposables, dry goods, sodas, etc.

Storage area for two glass racks

5-Inch Swivel Casters



ADDED STORAGE

Cabinet base and drawers on all modules for added storage.



OUTDOOR READY

Corrosion-resistant 304-grade stainless steel throughout



QUALITY CONSTRUCTION

14-gauge top and 18-gauge base

EuroBar®



New
EUROBAR | CAFE
ALL DAY BAR



FEATURES

Dedicated Espresso Machine & Coffee Grinder Zone

Designed for stability with power access

Craft Dump Sink with sloped pitcher rinser located inside for easy dumping and rinsing

Efficient Prep Area with Ice on the Side
Dedicated space for fast, organized drink assembly.

Trash Unit with Knock Box
Clean, contained, and ready for rushes

Cabinet Base
Conceals plumbing and stores extra bottles and smallware.

The EuroBar Coffee & Cocktails Bar is an all-day, every-day bar comprised of our EuroBar Cafe Station paired with our other units of your choice. This combination would allow you to seamlessly transition from morning espresso service to evening cocktails.

EuroBar

EUROBAR | CAFE

ALL DAY BAR



EuroBar | Cafe

EuroBar Coffee & Cocktail Bar Sample Layout



ADDED STORAGE

Cabinet base and drawers on all modules add storage and hide plumbing.



MODULAR COMPONENTS

keeps your bar efficient, clean, and guest-ready.



EASY TRANSITION

Easy converts from morning espresso to evening cocktails



QUALITY CONSTRUCTION

14-gauge top and 18-gauge base



EUROBAR MODULES

MAIN WORKSTATIONS



EUROBAR CLASSICO™ MAIN STATION
MODEL: EBMWS36



EUROBAR SPORTIVO™ MAIN STATION
MODEL: EBMSSP48 & EBMSSP36



EUROBAR ALTO™ MAIN STATION
MODEL: EBMSA36

MODULES



**ICE BIN
MODEL SIZE**

EBIB12 12" X 24"
EBIB15 15" X 24"
EBIB18 18" X 24"
EBIB24 24" X 24"



**BOTTLE WELL
MODEL SIZE**

EBIBW12 12" X 24"
EBIBW15 15" X 24"
EBIBW18 18" X 24"
EBIBW24 24" X 24"



**DUMP SINK
MODEL SIZE**

EBDS12 12" X 24"
EBCDS12 12" X 24"



**BLENDER STATION
MODEL SIZE**

EBDSBS12 12" X 24"
EBDSBS15 15" X 24"
EBDSBS18 18" X 24"
EBDSBS24 24" X 24"



**LIQUOR TREE
MODEL SIZE**

EBULD12 12" X 24"
EBULD15 15" X 24"
EBULD18 18" X 24"
EBULD24 24" X 24"



**FREE SPACE
MODEL SIZE**

EBFSU12 12" X 24"
EBFSU15 15" X 24"
EBFSU18 18" X 24"
EBFSU24 24" X 24"



**HAND SINK
MODEL SIZE**

EBHS12 12" X 24"



**DRAIN BOARD
MODEL SIZE**

EBDB12 12" X 24"
EBDB15 15" X 24"
EBDB18 18" X 24"
EBDB24 24" X 24"



**TRASH BIN
MODEL SIZE**

EBTB12 12" X 24"
EBTB16 16" X 24"



**TRASH UNIT FOR
SLIM JIM
MODEL SIZE**

EBTBC12 12" X 24"

EUROBAR MODULES

MODULES



PRECONFIGURED UNITS MODEL SIZE

EBPCU75 75" X 24"
EBPCU78 78" X 24"
EBPCU84 84" X 24"



3-COMP SINK MODEL SIZE

EB3CS19 60" X 19"
EB3CS24 60" X 24"



DRAFT TOWER UNIT

EBBC24
24"D X 24"W X 32"H



MARCO COFFEE CABINET

EBABDSC24
24"D X 24"W X 32"H

UNDERBAR REFRIGERATION



UNDERBAR 2-DRAWER REFRIGERATION

EBFBR24D 24"D X 24"W X 32"H

EUROBAR MODULES

DIE WALL



DIE WALL
4 FT SECTIONS

ACCESSORIES



**RETRACTABLE SODA GUN
MODEL**
EBSGF4R (PATENT PENDING)



CUP DISPENSOR
HOLDS 2, 3 OR
4 CUPS



DRAINBOARD TOP
MODEL SIZE
EBDBT28 28" X 24"

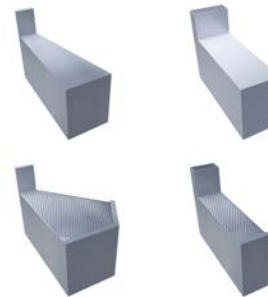

CUSTOM FILLER PIECES



**BOTTLE HOLDER FOR
CONDIMENT TRAY**



SPICE CADDY
MODEL
EBSC12

EUROBAR MODULES

BACKBAR REFRIGERATION



Single Door Cooler
EBBBR32SR
EBBBR32SL



Double Door Cooler
EBBBR52SR
EBBBR52SL



Three Door Cooler
EBBBR72SR
EBBBR72SL



Four Door Cooler
EBBBR92SR
EBBBR92SL



Single Door Cooler
EBBBR32GR
EBBBR32GL



Double Door Cooler
EBBBR52GR
EBBBR52GL



Three Door Cooler
EBBBR72GR
EBBBR72GL



Four Door Cooler
EBBBR92GR
EBBBR92GL

DRAFT COOLERS



Double Door Cooler
EBBBD52SR
EBBBD52SL



Three Door Cooler
EBBBD72SR
EBBBD72SL



Four Door Cooler
EBBBD92SR
EBBBD92SL



Scan to learn more about EuroBar
and how it can elevate your venue.

www.eurobarstation.com
[\(855\) 789-3876](tel:8557893876)



CONTACT

Bobby Devan VP of Global Operations
Tracy Beyer VP of Global Sales & Marketing

Bobby@Eurobarstation.com
Tracy@Eurobarstation.com

