

APPLICATION:

PRODUCT NAME:

**SS CTL VLV SDDLH SVL**

JOB NAME:

MODEL:

- 63592 SS CTL VLV SDDLH SVL SV
- 19070 SS CTL VLV SDDLH SVL CK

QUANTITY:

ITEM NO.:

OPTIONS OR MODIFICATIONS:

OTHER \_\_\_\_\_

**FEATURES**

**CONTROL VALVE**

- \* SWIVEL OUTLET
- \* HOT SIDE STEM - RIGHT HAND
- \* COLD SIDE STEM - LEFT HAND
- \* SWIVELLING SEAT DISKS
- \* STAINLESS STEEL SEATS
- \* STAINLESS STEEL SEAT SCREWS
- \* STAINLESS STEEL HANDLE SCREWS
- \* FLEXIBLE INLET HOSES

**SYSTEM LIMITS**

- \* TEMP: 40°F MIN. TO 160°F MAX.
- \* PRESSURE: 200 PSI MAX. STATIC

**SHIPPING WEIGHT**

- \* 5.0 LBS

**PRODUCT COMPLIANCE:**

- \* ASME A112.18.1 / CSA B125.1
- \* NSF 61 - Section 9
- \* NSF 372 (Low Lead Content)

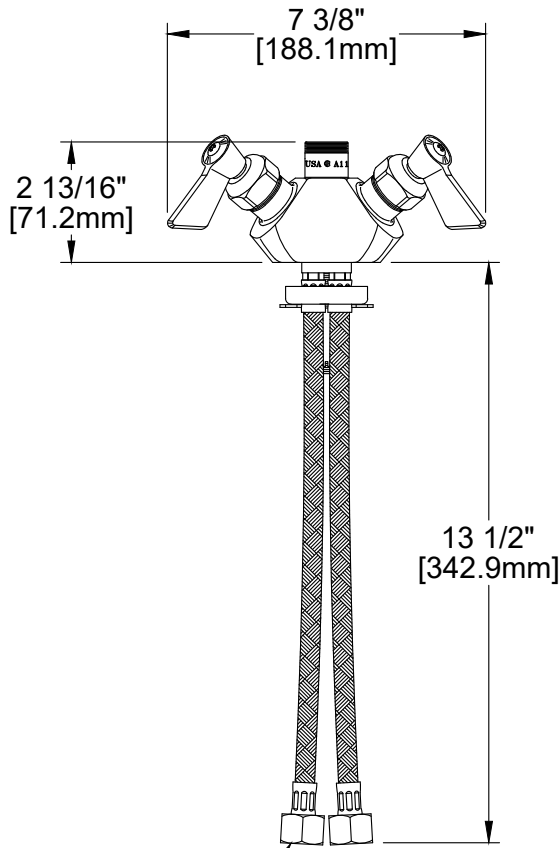

1/2" NPT FEMALE

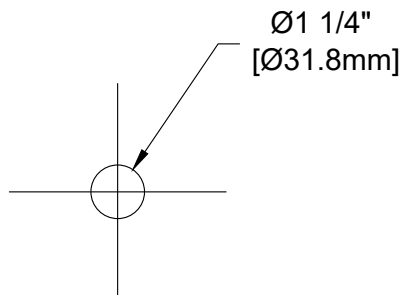

FISHER MANUFACTURING COMPANY  
 TOLL FREE: 800-421-6162 - FAX: 800-832-8238  
 information@fisher-mfg.com - www.fisher-mfg.com