



FISHER MANUFACTURING COMPANY TOLL FREE: 800-421-6162 - FAX: 800-832-8238
customer@fisherfaucets.com - www.fisherfaucets.com

PRODUCT NAME:

PRERINSE SPG 4BSCDLH SS

SPEC. PRCB-SPA-4BSLL

Customer/Wholesaler:	Date:	Job Name:	Model Specified:	Quantity:
Contractor:		Architect/Engineer:		

MODEL	DESCRIPTION	DIM A	DIM B	DIM C
34490	PRERINSE SPG 4BSCDLH 06SS	6" [152mm]	7 3/8" [188mm]	11 1/8" [282mm]
34500	PRERINSE SPG 4BSCDLH 08SS	8" [203mm]	8 5/16" [212mm]	12" [305mm]
34510	PRERINSE SPG 4BSCDLH 10SS	10" [254mm]	8 3/8" [212mm]	12 1/16" [306mm]
34520	PRERINSE SPG 4BSCDLH 12SS	12" [305mm]	9" [229mm]	12 11/16" [322mm]
34530	PRERINSE SPG 4BSCDLH 14SS	14" [356mm]	9 11/16" [245mm]	13 3/8" [339mm]
34540	PRERINSE SPG 4BSCDLH 16SS	16" [406mm]	10 5/16" [262mm]	14" [356mm]

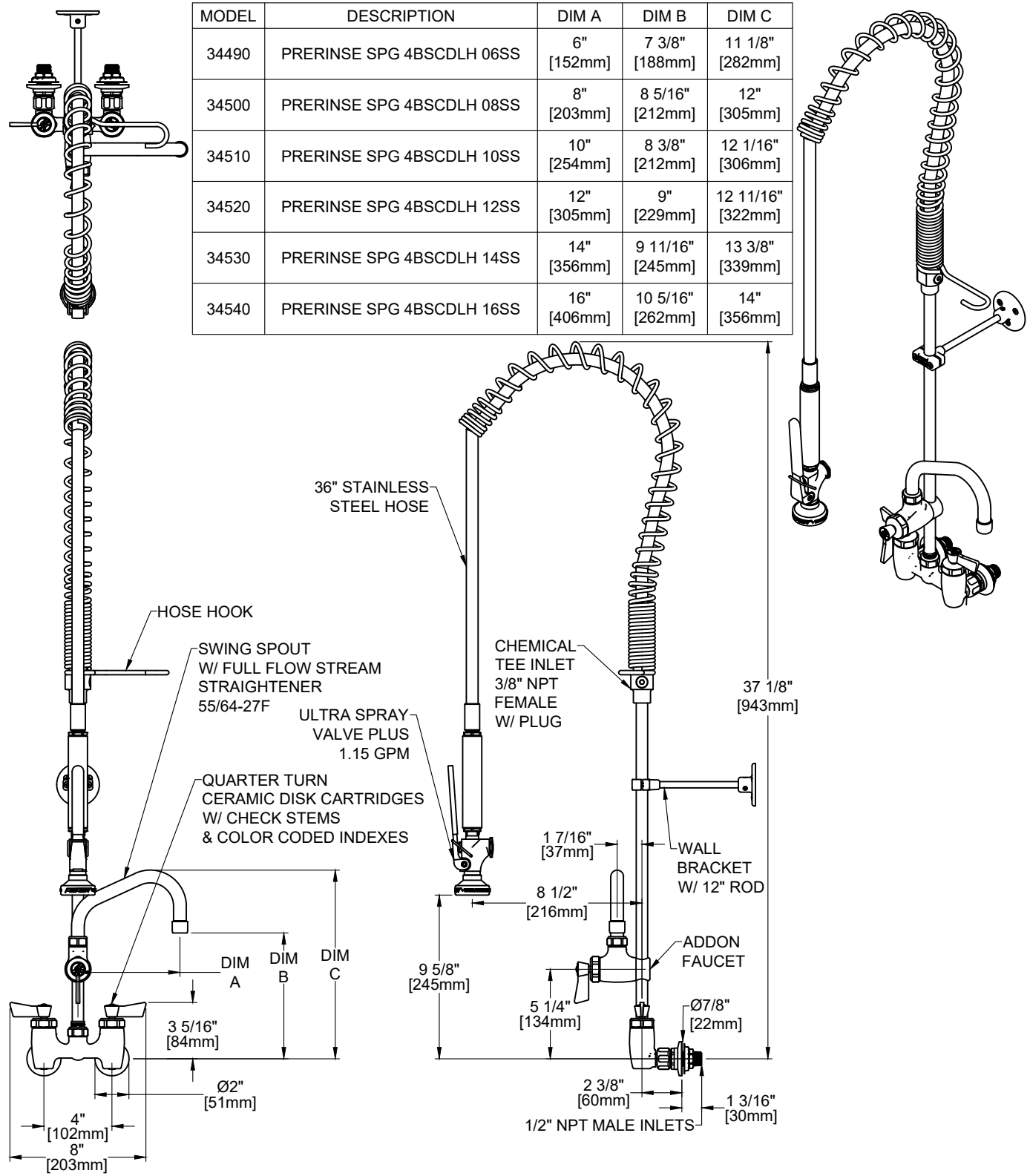

PRODUCT SPECIFICATIONS: 4" BACKSPASH SPRING PRERINSE UNIT 1.15 GPM @ 60 PSI, WITH CERAMIC CARTRIDGES, LEVER HANDLES, ADDON FAUCET, SWING SPOUT 12.5 GPM @ 60 PSI

PRODUCT COMPLIANCE:
ASME A112.18.1 / CSA B125.1
NSF 61 - Section 9
NSF 372 (Low Lead Content)
2019 DOE PRSV - Class II

Drawn: LC	Checked: EM	Approved: LC	Date: 11/14/25	Sheet: 1 of 2
-----------	-------------	--------------	----------------	---------------

Customer/Wholesaler:	Date:	Job Name:	Model Specified:	Quantity:
Contractor:		Architect/Engineer:		

REPLACEMENT PARTS

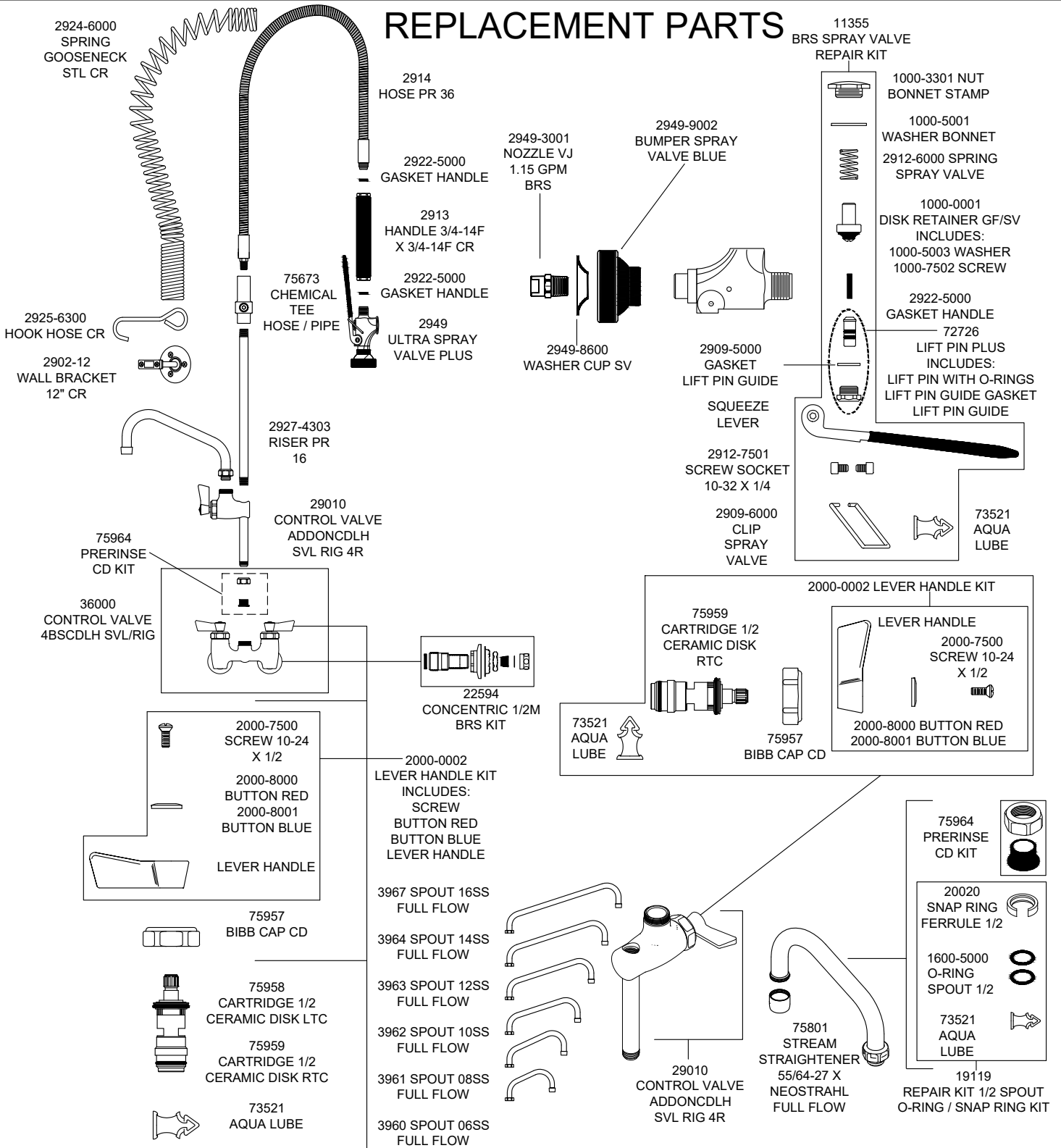

PRODUCT SPECIFICATIONS: 4" BACKSPASH SPRING PRERINSE UNIT 1.15 GPM @ 60 PSI, WITH CERAMIC CARTRIDGES, LEVER HANDLES, ADDON FAUCET, SWING SPOUT 12.5 GPM @ 60 PSI

PRODUCT COMPLIANCE: ASME A112.18.1 / CSA B125.1 NSF 61 - Section 9 NSF 372 (Low Lead Content) 2019 DOE PRSV - Class II