

Item No: _____

Model No: _____

Qty: _____

Project: _____

Sneeze Guards - Single Overshelf Style

- All stainless steel frame with tempered glass panels for durability
- Single Overshelf (SOSG) style has stainless steel top for product placement

| Model No. | Model No. with lights | Size D" x L" x H" | Weight lbs. |
|-----------|-----------------------|-------------------|-------------|
| SOSG-24 | SOSG-24L | 13(12) x 24 x 16 | 20 |
| SOSG-36 | SOSG-36L | 13(12) x 36 x 16 | 25 |
| SOSG-48 | SOSG-48L | 13(12) x 48 x 16 | 30 |
| SOSG-60 | SOSG-60L | 13(12) x 60 x 16 | 35 |
| SOSG-72 | SOSG-72L | 13(12) x 72 x 16 | 40 |
| SOSG-84 | SOSG-84L | 13(12) x 84 x 16 | 45 |
| SOSG-96 | SOSG-96L | 13(12) x 96 x 16 | 50 |

Sizes nominal, detailed specifications available upon request. Specifications subject to change without notice.

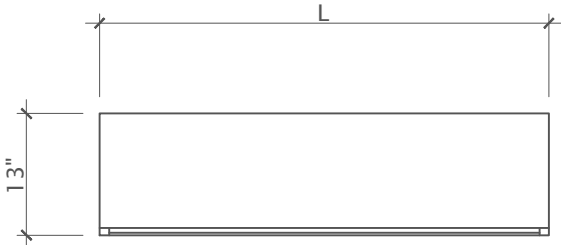

Extra support in the middle

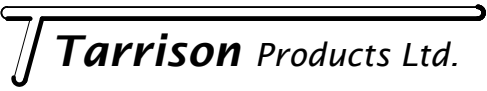
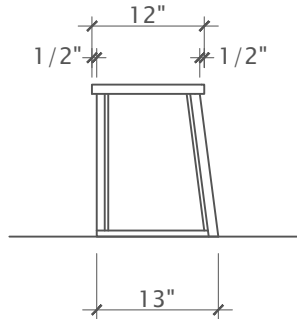
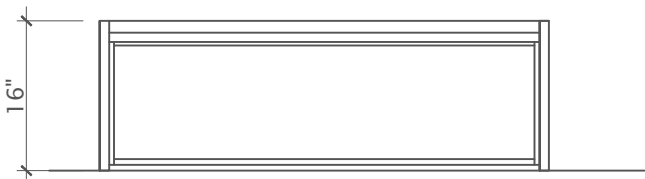

Corporate Head Office
 2780 Coventry Road,
 Oakville, Ontario, L6H 6R1
 Phone: 905-825-9665
 Fax: 905-825-0965
 info@tarrison.com
 www.tarrison.com

US Distribution Center
 150 Gratiot Blvd,
 Marysville, MI 48040
 www.tarrison.com

US Sales Office
 29 Craftsbury Crest,
 Essex Junction, VT. 05452
 Phone: 802-872-9292
 info@tarrison.com
 www.tarrison.com