

# Fusion

GHPF 52"H Dry Self-Service Case

Structural Concepts®

(Lengths do not include 1-1/8" end panels)

- GHPF452LB 48-3/4"L x 44-3/4"D x 51-1/4"H
- GHPF552LB 60-1/2"L x 44-3/4"D x 51-1/4"H
- GHPF652LB 73-1/8"L x 44-3/4"D x 51-1/4"H
- GHPF852LB 97-1/2"L x 44-3/4"D x 51-1/4"H

## Included

- Flat swing-out front glass
- LED top & shelf lights
- Non-refrigerated for ambient display
- One year parts & labor warranty
- Stainless steel rear exterior

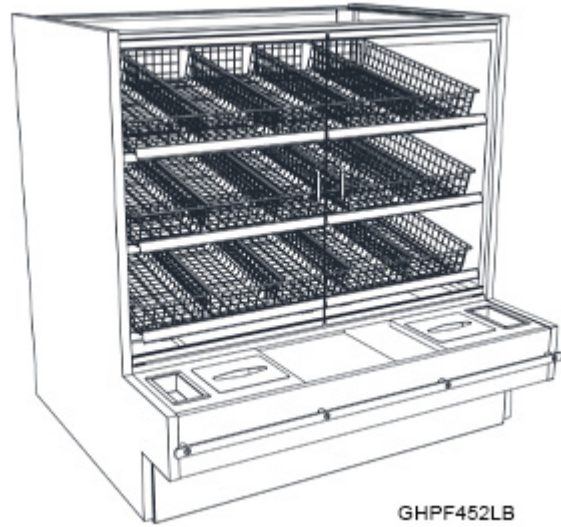

Specify	Standard Features	Additional Options
EXTERIOR COLOR	• Laminated (non-premium) Confirm pattern/grain direction	
INTERIOR COLOR	• Black	
LOWER FRONT PANEL COLOR	• Black powder coated	• Stainless steel
TRIM COLOR	• Black	
BASE	• Rail system for shims	
BUMPER FRONT	• 1" Boston bumper (specify color)	• 1" Stainless steel plate rail bumper
END PANELS	• None (specify per line-up)	• End bumper (LH / RH) • Full w/stainless steel interior (LH / RH)
UPPER REAR	• Solid back panel	• Reflective glass rear sliding doors
PRICE TAG MOLDING	• None	• 1" Price tag molding (black or silver) • Universal price tag molding (clear w/ open top)
SHELVING	• Wire rack shelves (3)	• Wire rack shelves (4)
LIGHTS	• LED 3500K w/ frosted lens	• LED 4000K w/ frosted lens
ELECTRICAL CONNECT	• Electrical leads	
MISCELLANEOUS		• 2"H Black wire baskets • 4"H Black wire baskets • 9"X 26" Trays • Front glass lock • Rear door lock

<b>Intended Environment:</b> Type I - Designed to operate in ambient conditions of 75°F with 55% relative humidity unless noted otherwise in system information below.		
<b>Zone</b>	<b>Intended Product To Be Displayed</b>	<b>Warmest Avg Prod Temp ° F</b>
1	Packaged / unpackaged non-refrigerated products	Ambient

### PLAN VIEW

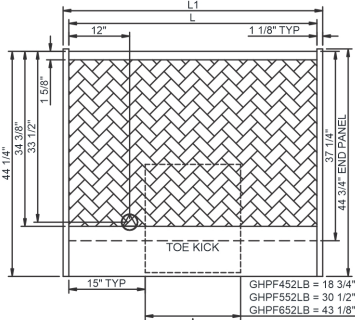

GHPF452LB, GHPF552LB, GHPF652LB CASE FRONT

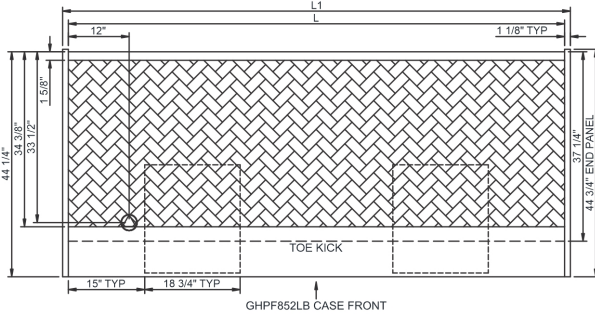

GHPF852LB CASE FRONT

### SIDE VIEW

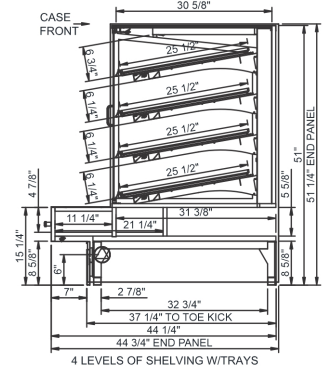
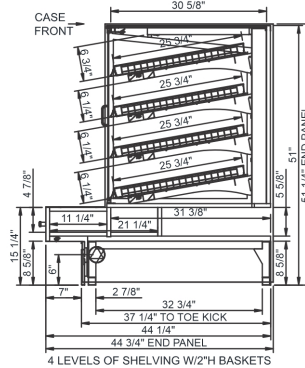
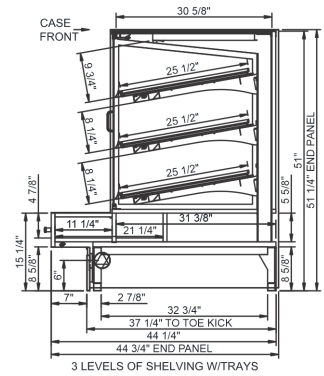
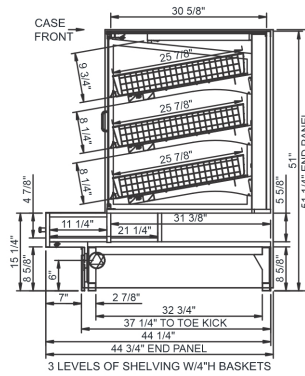

NOTE: ALL DIMENSIONS APPROXIMATE

- ELECTRICAL JUNCTION BOX (SUPPLIED WITH 6" LEADS OR POWER CORD).
- LOCATION OF DRAIN TUBE FOR REMOTE REF. ONLY (SUPPLIED WITH 3/4" OR 1 1/2" PVC TUBE).

- REFRIGERATION LINE CONNECTION.
- REMOTE FLOOR SINK & UTILITIES ACCESS AREA.

- SELF-CONTAINED CASE SERVICE ACCESS AREA.
- DRY CASE SERVICE ACCESS AREA.

### Model Technical Specifications

Model	L"	L1"	L2"	System Circuit Volts	Phs	Freq	Amps ***	Watts	Wires	NEMA Plug	SST	Conv. Rack RTUH	Para. Rack RTI/H	Est Wt		
GHPF452LB	48.75	51.00	.00	Ambient/Lights (N/A)	Circuit #1	110-120	1	60	0.70	25	2+G	Leads Single	N/A	N/A	N/A	N/A
GHPF552LB	60.50	62.75	.00	Ambient/Lights (N/A)	Circuit #1	110-120	1	60	0.70	40	2+G	Leads Single	N/A	N/A	N/A	N/A
GHPF652LB	73.13	75.38	.00	Ambient/Lights (N/A)	Circuit #1	110-120	1	60	0.70	38	2+G	Leads Single	N/A	N/A	N/A	N/A
GHPF852LB	97.50	99.75	.00	Ambient/Lights (N/A)	Circuit #1	110-120	1	60	1.40	88	2+G	Leads Multiple	N/A	N/A	N/A	N/A

\*\*\* Does not include electric defrost on freezer models.

#### Regulatory Approvals:

All Models ETL Listed to UL 65  
ETL Sanitation to NSF/ANSI 2



#### Important Notes:

- ELECTRICAL NOTE: If GFCI is required, a GFCI breaker MUST be used in lieu of a GFCI receptacle.
- 47" minimum door entry clearance required (without shipping skid).
- Units must be shimmed during installation to ensure the unit is level and plumb.

**⚠ WARNING:** This product can expose you to chemicals, including Urethane (Ethyl Carbamate), which are known to the State of California to cause cancer and birth defects or other reproductive harm. For more information go to [www.P65Warnings.ca.gov](http://www.P65Warnings.ca.gov).