

Backbar Bottle Cooler

Item # _____
Project : _____
Qty : _____

Model No.

BB3-24-HC



BB3-24-HC

Features:

- CFC free refrigerant and foam
- Electronic thermostat and digital led temperature display for accurate control and easy reading
- Self-closing door
- Magnetic gasket can be replaced without any tools
- Stainless steel top
- INTERIOR: powder-coated steel white, bottom S/S 304
- EXTERIOR: powder-coated steel black
- Unit ships with 5" casters, not installed

Warranty Info:

Two Year

- Parts & Labor on entire unit.
- Valid in United States.
- Valid for commercial use only.

Three Year

- Additional Compressor, Part Only.

Revised 02/22/2022

BB3-24-HC



Intertek



Intertek



www.servware.com

Phone:(800).768.5953

Fax:(800).976.1299

BB3-24-HC Backbar Bottle Cooler



Item #
Project :
Qty :

Front View

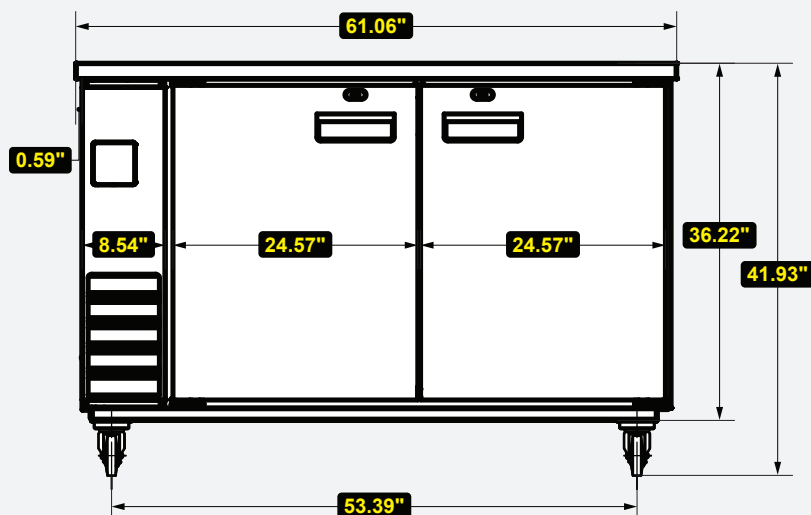

Side View

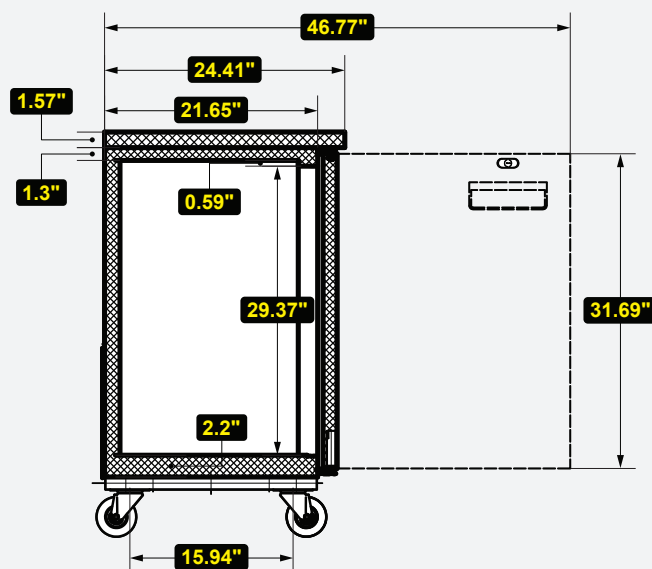

Top View

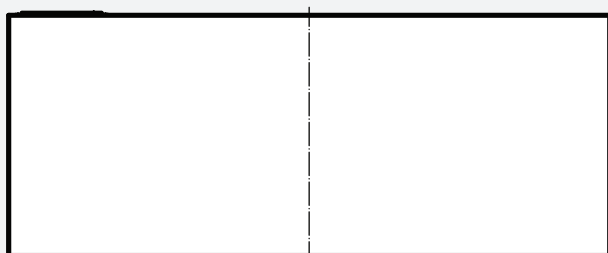

NEMA 5-15P

Technical Information:

MODEL #	DESCRIPTION	DIMENSIONS (W x D x H)	WEIGHT/LBS. (Shipping)
BB3-24-HC	61 in. Unit	61.1" W x 24.4" D x 36.2" H	300 lbs.

CONSTRUCTION

Exterior Material	Painted Steel
Interior Material	Painted Steel
Insulation Material	CFC Free Foam
Shelf Material	PVC Coated Wire
Number of Shelves	1 per Door

COOLING

Temperature Range	33°F – 41°F
Refrigerant+Charge oz.	R290 / 0.00 oz.
BTU/H	1155
Defrosting	Every 6 Hours
Horse Power	2/5
Storage Capacity	13.5 cu. ft.

ELECTRICAL

Voltage	115
Amps	3.0
Hz	60
Phase	1

ADDITIONAL INFORMATION

Installation by certified commercial restaurant equipment installer recommended. Inspection before and after installation by licensed electrician for safe operation. Product designed for interior usage in a climate controlled location with adequate air circulation and not adjacent to a high temperature source.

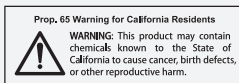

Copyright © 2022 Serv-Ware Products LLC

Phone:(800).768.5953
Fax:(800).976.1299

www.servware.com