

ITALIA 1-2-3 CHOCOLATE SHOWCASE

STANDARD FEATURES

- Available in 3 heights: 45"H, 47"H, 53"H
- Humidity control
- Maxi display volume perfectly refrigerated
- Diffused LED lighting 3000°K
- Sliding double pane doors closure on operator side
- Full volume temperature control
- Double glazed walls
- Electronic temperature control
- Perfect visibility on all 4 sides
- Front, top, sides double glasses
- Glass frame gray
- Cases ship standard unfinished front and stainless steel skin sides



Photos shown with optional RAL color finish. Standard cases are unfinished front with stainless steel skin sides.

OPTIONS

- Italia 4
- Italia 1-2-3 Narrow - 25" deep
- Glass frame colors: black, white, and gold
- Front access double doors
- Lift up hydraulic double pane front glass
- Remote condensing unit
- Matches with Muro H11
- Cold storage
- RAL color finish/wood laminate front and side panels
- Heated pan for evaporator
- Casters



Visit our website for more finishing options and RAL colors
www.oscartek.com

ITALIA 1 CHOCOLATE					
TECHNICAL FEATURES		MODELS			
		ITALIA 1 C900	ITALIA 1 C1200	ITALIA 1 C1500	ITALIA 1 C2000
External Dimensions (L-D-H)	Inches	*35 3/8" - 31 5/8" - 45 1/4"	*47 1/4" - 31 5/8" - 45 1/4"	*59" - 31 5/8" - 45 1/4"	*78 3/4" - 31 5/8" - 45 1/4"
	Inches-MM	*900 - 803 - 1150	*1200 - 803 - 1150	*1500 - 803 - 1150	*2000 - 803 - 1150
Crated Dimensions (L-D-H)	Inches	42" - 38" - 52"	54" - 38" - 52"	67" - 38" - 52"	85" - 38" - 52"
	Inches-MM	1066 - 965 - 1320	1371 - 965 - 1320	1701 - 965 - 1320	2159 - 965 - 1320
Refrigeration	Type	Ventilated	Ventilated	Ventilated	Ventilated
Refrigeration Display Area	Type	Deck + Shelf	Deck + Shelf	Deck + Shelf	Deck + Shelf
Operating Temperature	°F	57.2°F	57.2°F	57.2°F	57.2°F
Compressor	Nr./Type	1 / Hermetic	1 / Hermetic	1 / Hermetic	1 / Hermetic
BTU'S @ +35°F Expansion Temperature	BTU's	1750	2300	2950	3750
Electric Supply	V/Ph/Hz	208-220/1/60	208-220/1/60	208-220/1/60	208-220/1/60
Power Consumption	W/A	580/5.5	650/6.2	850/8.0	1200/11.4
Defrost	Mode/Type	Automatic	Automatic	Automatic	Automatic
Climatic Class	°F/H.R.	75°F-55%RH	75°F-55%RH	75°F-55%RH	75°F-55%RH
Refrigerant Gas	Type	R404A / R452A	R404A / R452A	R404A / R452A	R404A / R452A
Pipe Size (Inches)	Suction, Liquid	3/8" Suction, 1/4" Liquid	3/8" Suction, 1/4" Liquid	1/2" Suction, 1/4" Liquid	5/8" Suction, 5/16" Liquid
Net Weights	Lb	310	365	465	540
Crated Weights	Lb	360	415	540	615

* DIMENSIONS ARE WITHOUT SIDE PANELS

*Factory in its effort to upgrade and improve our products, has the right to change, modify, discontinue or change any feature, size or capacity on any model without prior notice.



512 South Airport Blvd., South San Francisco, CA 94080
 Tel: 855.885.2400 | 650.342.2400 | Fax: 650.342.7400
sales@oscartek.com | www.oscartek.com



ITALIA 1-2-3 CHOCOLATE SHOWCASE

ITALIA 1 CHOCOLATE			
TECHNICAL FEATURES		MODELS	
		ITALIA 1 CA90LT	ITALIA 1 CA90RT
External Dimensions (L-D-H)	Inches	** 59" - 31 5/8" - 45 1/4"	** 59" - 31 5/8" - 45 1/4"
Inches-MM	MM	**1500 - 803 - 1150	**1500 - 803 - 1150
Crated Dimensions (L-D-H)	Inches	67" - 38" - 52"	67" - 38" - 52"
Inches-MM	MM	1701 - 965 - 1320	1701 - 965 - 1320
Refrigeration	Type	Ventilated	Ventilated
Refrigeration Display Area	Type	Deck + Shelf	Deck + Shelf
Operating Temperature	°F	57.2°F	57.2°F
Compressor	Nr./Type	1 / Hermetic	1 / Hermetic
BTU'S @ +35°F Expansion Temperature	BTU's	5600	5600
Electric Supply	V/Ph/Hz	208-220/1/60	208-220/1/60
Power Consumption	W/A	1600/8.5	1600/8.5
Defrost	Mode/Type	Automatic	Automatic
Climatic Class	°F/H.R.	75°F-55%RH	75°F-55%RH
Refrigerant Gas	Type	R404A / R452A	R404A / R452A
Pipe Size (Inches)	Suction, Liquid	5/8" Suction, 5/16" Liquid	5/8" Suction, 5/16" Liquid
Net Weights	Lb	705	705
Crated Weights	Lb	780	780

****DIMENSIONS ARE WITHOUT SIDE PANELS. SEE PLAN VIEWS FOR ADDITIONAL EXTERIOR DIMENSIONS**

ITALIA 2 CHOCOLATE					
TECHNICAL FEATURES		MODELS			
		ITALIA 2 C900	ITALIA 2 C1200	ITALIA 2 C1500	ITALIA 2 C2000
External Dimensions (L-D-H)	Inches	*35 3/8" - 31 5/8" - 47 1/4"	*47 1/4" - 31 5/8" - 47 1/4"	*59" - 31 5/8" - 47 1/4"	*78 3/4" - 31 5/8" - 47 1/4"
Inches-MM	MM	*900 - 803 - 1200	*1200 - 803 - 1200	*1500 - 803 - 1200	*2000 - 803 - 1200
Crated Dimensions (L-D-H)	Inches	42" - 38" - 54"	54" - 38" - 54"	67" - 38" - 54"	85" - 38" - 54"
Inches-MM	MM	1066 - 965 - 1371	1371 - 965 - 1371	1701 - 965 - 1371	2159 - 965 - 1371
Refrigeration	Type	Ventilated	Ventilated	Ventilated	Ventilated
Refrigeration Display Area	Type	Deck + Shelves	Deck + Shelves	Deck + Shelves	Deck + Shelves
Operating Temperature	°F	57.2°F	57.2°F	57.2°F	57.2°F
Compressor	Nr./Type	1 / Hermetic	1 / Hermetic	1 / Hermetic	1 / Hermetic
BTU'S @ +35°F Expansion Temperature	BTU's	1980	2660	3380	4090
Electric Supply	V/Ph/Hz	208-220/1/60	208-220/1/60	208-220/1/60	208-220/1/60
Power Consumption	W/A	580/5.5	650/6.2	850/8.0	1200/11.4
Defrost	Mode/Type	Automatic	Automatic	Automatic	Automatic
Climatic Class	°F/H.R.	75°F-55%RH	75°F-55%RH	75°F-55%RH	75°F-55%RH
Refrigerant Gas	Type	R404A / R452A	R404A / R452A	R404A / R452A	R404A / R452A
Pipe Size (Inches)	Suction, Liquid	3/8" Suction, 1/4" Liquid	3/8" Suction, 1/4" Liquid	1/2" Suction, 1/4" Liquid	5/8" Suction, 5/16" Liquid
Net Weights	Lb	330	400	510	595
Crated Weights	Lb	380	450	585	670

*** DIMENSIONS ARE WITHOUT SIDE PANELS**

**Factory in its effort to upgrade and improve our products, has the right to change, modify, discontinue or change any feature, size or capacity on any model without prior notice.*



512 South Airport Blvd., South San Francisco, CA 94080
 Tel: 855.885.2400 | 650.342.2400 | Fax: 650.342.7400
 sales@oscartek.com | www.oscartek.com



ITALIA 1-2-3 CHOCOLATE SHOWCASE

ITALIA 2 CHOCOLATE			
TECHNICAL FEATURES		MODELS	
		ITALIA 2 CA90LT	ITALIA 2 CA90RT
External Dimensions (L-D-H)	Inches	** 59" - 31 5/8" - 47 1/4"	** 59" - 31 5/8" - 47 1/4"
	MM	**1500 - 803 - 1200	**1500 - 803 - 1200
Crated Dimensions (L-D-H)	Inches	67" - 38" - 54"	67" - 38" - 54"
	MM	1701 - 965 - 1371	1701 - 965 - 1371
Refrigeration	Type	Ventilated	Ventilated
Refrigeration Display Area	Type	Deck + Shelves	Deck + Shelves
Operating Temperature	°F	57.2°F	57.2°F
Compressor	Nr./Type	1 / Hermetic	1 / Hermetic
BTU'S @ +35°F Expansion Temperature	BTU's	6150	6150
Electric Supply	V/Ph/Hz	208-220/1/60	208-220/1/60
Power Consumption	W/A	1600/8.5	1600/8.5
Defrost	Mode/Type	Automatic	Automatic
Climatic Class	°F/H.R.	75°F-55%RH	75°F-55%RH
Refrigerant Gas	Type	R404A / R452A	R404A / R452A
Pipe Size (Inches)	Suction, Liquid	5/8" Suction, 5/16" Liquid	5/8" Suction, 5/16" Liquid
Net Weights	Lb	770	770
Crated Weights	Lb	850	850

****DIMENSIONS ARE WITHOUT SIDE PANELS. SEE PLAN VIEWS FOR ADDITIONAL EXTERIOR DIMENSIONS**

ITALIA 3 CHOCOLATE					
TECHNICAL FEATURES		MODELS			
		ITALIA 3 C900	ITALIA 3 C1200	ITALIA 3 C1500	ITALIA 3 C2000
External Dimensions (L-D-H)	Inches	*35 3/8" - 31 5/8" - 53 1/8"	*47 1/4" - 31 5/8" - 53 1/8"	*59" - 31 5/8" - 53 1/8"	*78 3/4" - 31 5/8" - 53 1/8"
	MM	*900 - 803 - 1350	*1200 - 803 - 1350	*1500 - 803 - 1350	*2000 - 803 - 1350
Crated Dimensions (L-D-H)	Inches	42" - 38" - 60"	54" - 38" - 60"	67" - 38" - 60"	85" - 38" - 60"
	MM	1066 - 965 - 1524	1371 - 965 - 1524	1701 - 965 - 1524	2159 - 965 - 1524
Refrigeration	Type	Ventilated	Ventilated	Ventilated	Ventilated
Refrigeration Display Area	Type	Deck + Shelves	Deck + Shelves	Deck + Shelves	Deck + Shelves
Operating Temperature	°F	57.2°F	57.2°F	57.2°F	57.2°F
Compressor	Nr./Type	1 / Hermetic	1 / Hermetic	1 / Hermetic	1 / Hermetic
BTU'S @ +35°F Expansion Temperature	BTU's	2300	3200	3850	4900
Electric Supply	V/Ph/Hz	208-220/1/60	208-220/1/60	208-220/1/60	208-220/1/60
Power Consumption	W/A	750/6.9	950/8.5	1350/13.0	1500/14.4
Defrost	Mode/Type	Automatic	Automatic	Automatic	Automatic
Climatic Class	°F/H.R.	75°F-55%RH	75°F-55%RH	75°F-55%RH	75°F-55%RH
Refrigerant Gas	Type	R404A / R452A	R404A / R452A	R404A / R452A	R404A / R452A
Pipe Size (Inches)	Suction, Liquid	3/8" Suction, 1/4" Liquid	1/2" Suction, 1/4" Liquid	5/8" Suction, 5/16" Liquid	5/8" Suction, 5/16" Liquid
Net Weights	Lb	355	430	550	650
Crated Weights	Lb	405	480	625	725

*** DIMENSIONS ARE WITHOUT SIDE PANELS**

**Factory in its effort to upgrade and improve our products, has the right to change, modify, discontinue or change any feature, size or capacity on any model without prior notice.*



512 South Airport Blvd., South San Francisco, CA 94080
 Tel: 855.885.2400 | 650.342.2400 | Fax: 650.342.7400
 sales@oscartek.com | www.oscartek.com



ITALIA 1-2-3 CHOCOLATE SHOWCASE

ITALIA 3 CHOCOLATE			
TECHNICAL FEATURES		MODELS	
		ITALIA 3 CA90LT	ITALIA 3 CA90RT
External Dimensions (L-D-H)	Inches	** 59" - 31 5/8" - 53 1/8"	** 59" - 31 5/8" - 53 1/8"
Inches-MM	MM	**1500 - 803 - 1350	**1500 - 803 - 1350
Crated Dimensions (L-D-H)	Inches	67" - 38" - 60"	67" - 38" - 60"
Inches-MM	MM	1701 - 965 - 1524	1701 - 965 - 1524
Refrigeration	Type	Ventilated	Ventilated
Refrigeration Display Area	Type	Deck + Shelves	Deck + Shelves
Operating Temperature	°F	57.2°F	57.2°F
Compressor	Nr./Type	1 / Hermetic	1 / Hermetic
BTU'S @ +35°F Expansion Temperature	BTU's	7000	7000
Electric Supply	V/Ph/Hz	208-220/1/60	208-220/1/60
Power Consumption	W/A	1850/9.2	1850/9.2
Defrost	Mode/Type	Automatic	Automatic
Climatic Class	°F/H.R.	75°F-55%RH	75°F-55%RH
Refrigerant Gas	Type	R404A / R452A	R404A / R452A
Pipe Size (Inches)	Suction, Liquid	5/8" Suction, 3/8" Liquid	5/8" Suction, 3/8" Liquid
Net Weights	Lb	840	840
Crated Weights	Lb	915	915

**DIMENSIONS ARE WITHOUT SIDE PANELS. SEE PLAN VIEWS FOR ADDITIONAL EXTERIOR DIMENSIONS

SECTION VIEWS: ITALIA 1-2-3 C900, C1200, C1500, C2000, CA90LT, CA90RT

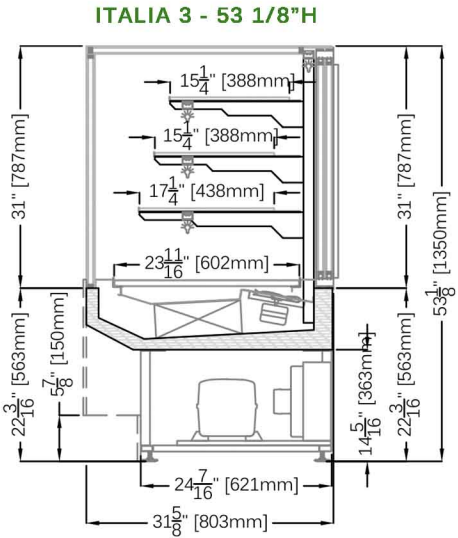
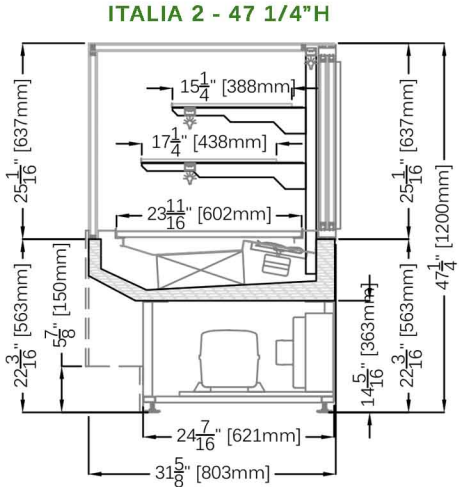
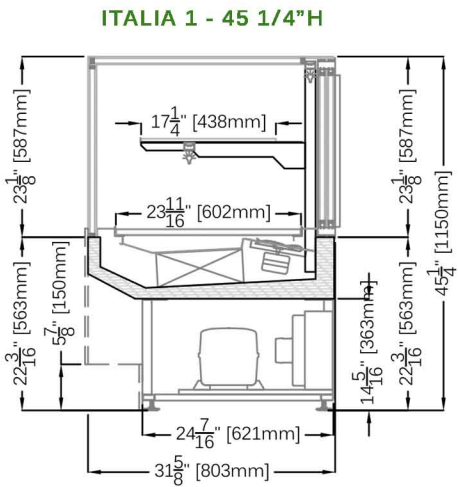

*Factory in its effort to upgrade and improve our products, has the right to change, modify, discontinue or change any feature, size or capacity on any model without prior notice.



512 South Airport Blvd., South San Francisco, CA 94080
 Tel: 855.885.2400 | 650.342.2400 | Fax: 650.342.7400
 sales@oscartek.com | www.oscartek.com



ITALIA 1-2-3 CHOCOLATE SHOWCASE

OPTIONAL:

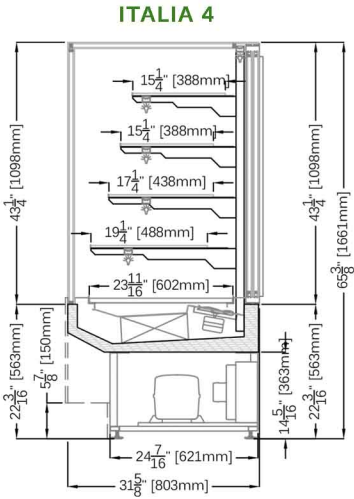

ITALIA 1-2-3 NARROW

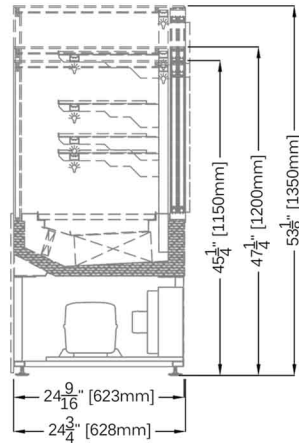

ITALIA 1-2-3 PLAN VIEWS: ITALIA 1-2-3 C900, C1200, C1500, C2000, CA90LT, CA90RT

ITALIA 1-2-3 LINEAR MODELS

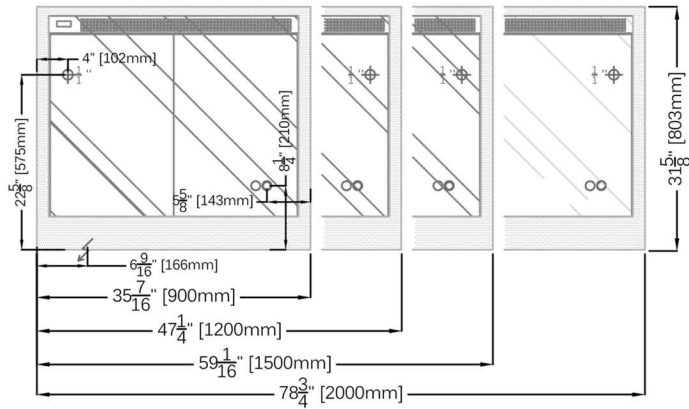

ELECTRICAL LEGEND	
	REFRIGERATED LINES
	DRAIN
	POWER

ITALIA 1-2-3 CA90LT

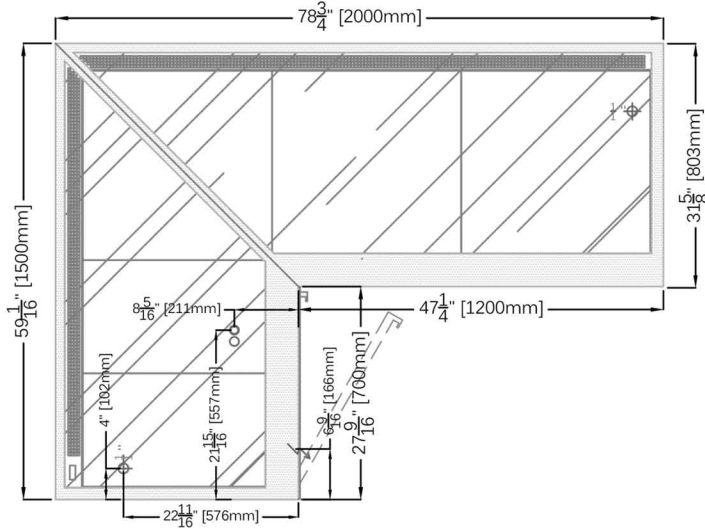

ITALIA 1-2-3 CA90RT

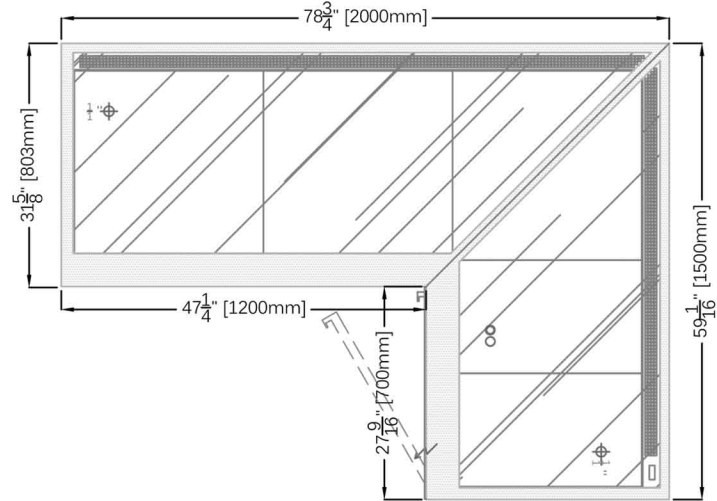

*Factory in its effort to upgrade and improve our products, has the right to change, modify, discontinue or change any feature, size or capacity on any model without prior notice.



512 South Airport Blvd., South San Francisco, CA 94080
 Tel: 855.885.2400 | 650.342.2400 | Fax: 650.342.7400
 sales@oscartek.com | www.oscartek.com



ITALIA 1-2-3 CHOCOLATE SHOWCASE

ITALIA 1-2-3 REAR ELEVATIONS (OPERATOR SIDE): SHOWN WITH REAR VENTILATION

ITALIA 1-2-3 C900, C1200, C1500, C2000, CA90LT, CA90RT

ITALIA 1-2-3 LINEAR MODELS

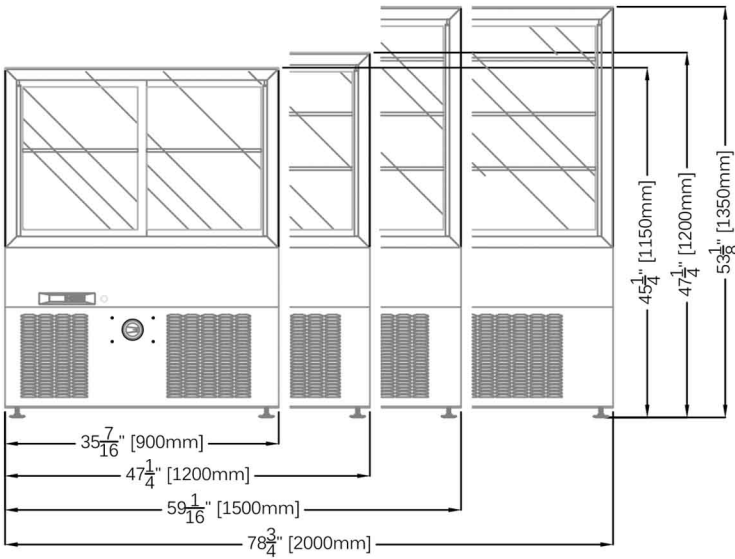

ITALIA 1-2-3 CA90LT

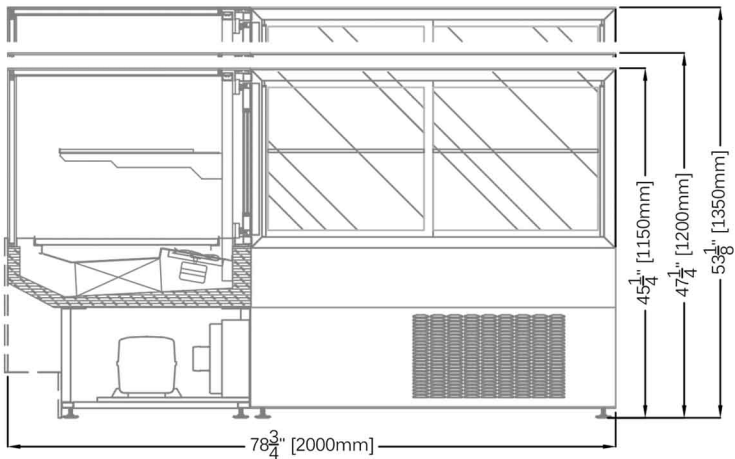

ITALIA 1-2-3 CA90RT

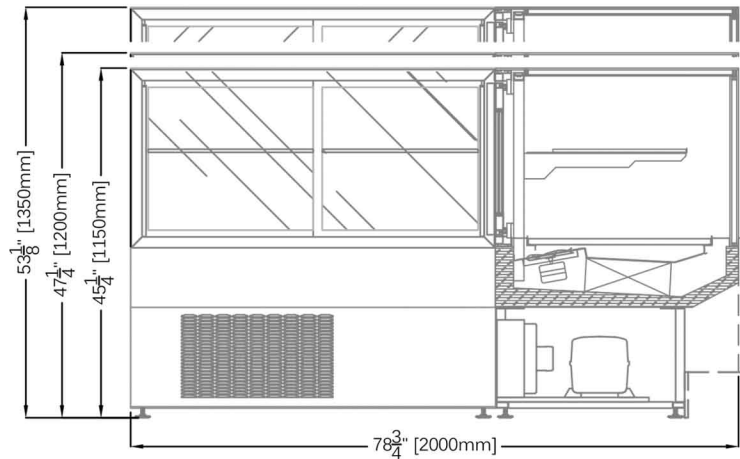

*Factory in its effort to upgrade and improve our products, has the right to change, modify, discontinue or change any feature, size or capacity on any model without prior notice.



512 South Airport Blvd., South San Francisco, CA 94080
 Tel: 855.885.2400 | 650.342.2400 | Fax: 650.342.7400
 sales@oscartek.com | www.oscartek.com

