



POWER SOAK SYSTEM

INTRO CONTINUOUS POT, PAN & SHEET PAN WASHING SYSTEM MODELS PSI6-L/R

The Power Soak Intro System is a pre-configured three-bay continuous pot, pan and sheet washing system. The patented Parallel Wash System's washing wave action, with wash jets located every 6 inches along the back wall of the wash tank, continuously rotates wares from the back of the wash tank up to the operator in hot soapy water that removes baked-on food soils, providing unparalleled results with an excellent ROI.

PROJECT NAME:

LOCATION:

ITEM NO:

QTY:

MODEL NO:

AIA NO:

SIS NO:

CSI SECTION: 11400

AVAILABLE MODELS:

- PSI6-84L-30
- PSI6-84R-30
- PSI6-96L-36
- PSI6-96R-36
- PSI6-108L-42
- PSI6-108R-42
- PSI6-120L-48
- PSI6-120R-48

STANDARD SPECIFICATIONS:

- One-piece construction made of 14-gauge, 304 stainless steel
- Conforms to ANSI/NSF Standard 2 with Heliarc (TIG) welds
- 30" front to back depth
- 1-½" front-channel rim with back splash to be 8" over all height with hemmed end splashes
- Pre-configured system includes 12" Scrap Sink
- Wash Tank includes a self-draining, 2 HP, 115 volt / single-phase wash motor with patented Parallel Wash System
- Incorporates low-profile wash jets every 6" along the back wash tank wall and above the stainless steel wash pump intake manifold (which run the full length of the rear of the tank below wash jets) (sheet pan racks not available)
- System includes Rinse and Sanitizer Tanks with clean drain board
- Bottom of tanks are manufactured to facilitate ease of draining
- System includes ½" pre-rinse assembly
- System does not include faucets or drains, but is pre-cut with holes to accommodate faucet hardware, see drawing
- Wash tank heat not available

CONTROLS:

PS-50: Simple on/off control

INSTALLATION REQUIREMENTS:

- Unit requires hot and cold water, and drain connections
- Single point with 208 or 230 volt / single-phase electrical connection
- Direction of operation may be configured left-to-right or right-to-left

ELECTRICAL CONNECTION OPTIONS:

- 208V/60/1, 8.8 Amps
- 230V/60/1, 8.3 Amps

WARRANTY:

- 1 years for parts and labor

ORIGIN OF MANUFACTURE:

Designed and manufactured in the United States.



OPTIONAL ACCESSORIES:

- Faucets and drains
- Advanced Wash Insert (AWI)
- Power utensil basket
- Drying racks

Power Soak System

44931 RevC

Revised 09/10/18



Part No.	Length	Flow	CONFIGURATIONS OF UNIT FROM LEFT TO RIGHT						
			End Splash	Scrap Sink	Wash Tank	Rinse Tank	Sanitizer Tank	Clean Drain Board	End Splash
PSI6-84L-30	84"	Left to Right	Hemmed	12"	30" x 21"	14" x 16"	14" x 16"	14"	Hemmed
PSI6-96L-36	96"		Hemmed	12"	36" x 21"	14" x 16"	14" x 16"	20"	Hemmed
PSI6-108L-42	108"		Hemmed	12"	42" x 21"	20" x 16"	20" x 16"	14"	Hemmed
PSI6-120L-48	120"		Hemmed	12"	48" x 21"	20" x 16"	20" x 16"	20"	Hemmed

Part No.	Length	Flow	CONFIGURATIONS OF UNIT FROM LEFT TO RIGHT						
			End Splash	Clean Drain Board	Sanitizer Tank	Rinse Tank	Wash Tank	Scrap Sink	End Splash
PSI6-84R-30	84"	Right to Left	Hemmed	14"	14" x 16"	14" x 16"	30" x 21"	12"	Hemmed
PSI6-96R-36	96"		Hemmed	20"	14" x 16"	14" x 16"	36" x 21"	12"	Hemmed
PSI6-108R-42	108"		Hemmed	14"	20" x 16"	20" x 16"	42" x 21"	12"	Hemmed
PSI6-120R-48	120"		Hemmed	20"	20" x 16"	20" x 16"	48" x 21"	12"	Hemmed



SAMPLE CONFIGURATION:

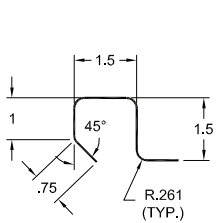
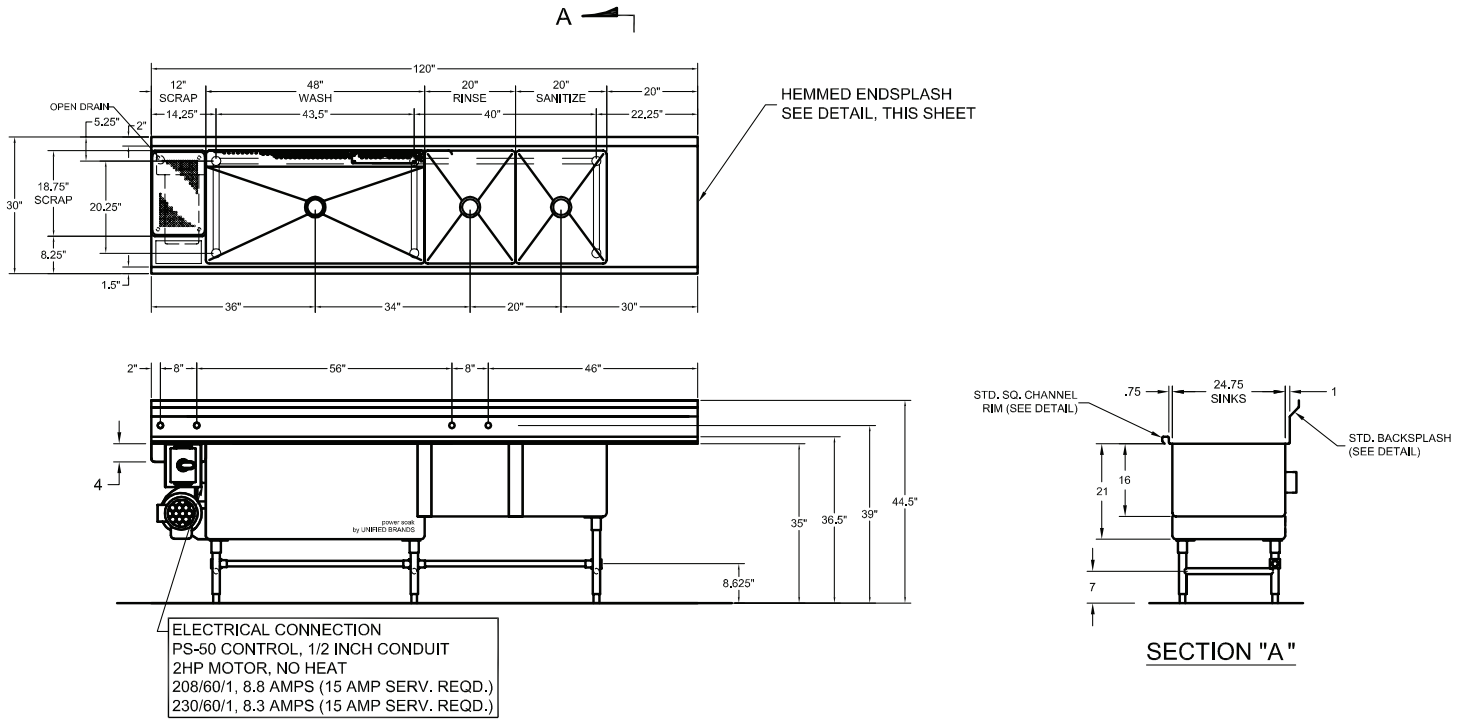

SQ. CHANNEL RIM DETAIL

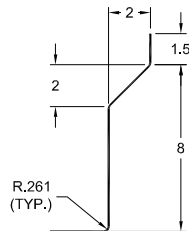

BACKSPLASH DETAIL

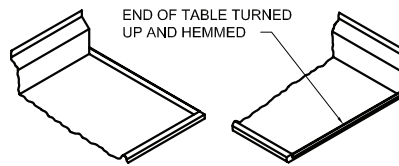

HEMMED ENDSPLASH DETAIL

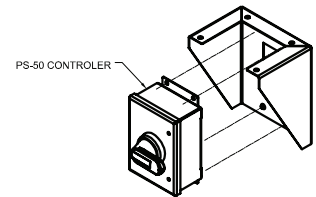

PS-50 CONTROLLER AND BRACKET DETAIL