

NEW!

VCM PARTS For Hobart, Stephan and Berkel Vertical Cutter/Mixers

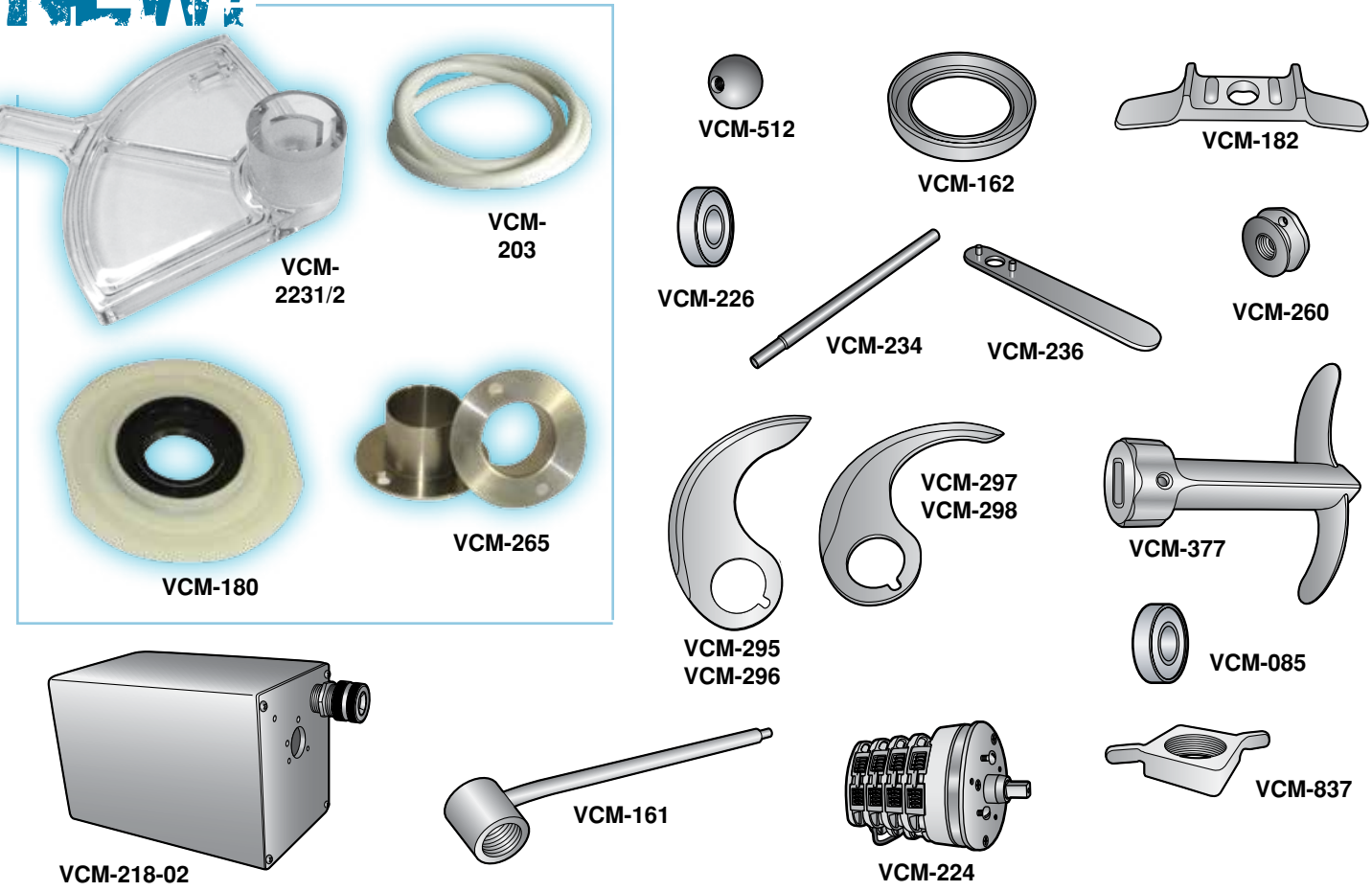

FITS MODELS

ALFA #	STEPHAN #	HOBART #	BERKEL #	DESCRIPTION	25	40	44	44A
VCM-085	6085	M-82999	88217-24	Lower Bearing	X	X		
VCM-161	0161	M-82840	88015-24	Tilt Handle	X	X		
VCM-162	0162	M-83002	88211-24	Oil Seal	X	X		
NEW VCM-180	0180	A-106978+ A-106980	88028-B24+ 88028-C24	Bowl Seal Assembly with O-Ring		X	X	X
VCM-182	0182	A-106985	88028-24	Wrench for Bowl Seal Assembly	X	X	X	X
VCM-218-02	3M2218-02	N/A	N/A	New Style Switch Housing with Fitting and Screws	X	X		
NEW VCM-203	0203	N/A	N/A	Lid Gasket O-Ring		X	X	X
VCM-224	0224	M-82869	88058-24	Rotary Drum Switch - N/S	X	X		
VCM-226	6226	M-3003	88210-24	Upper Bearing	X	X		
VCM-234	0234	M-82876	88064-24	Holding Pin	X	X		
VCM-236	0236	M-82777	88065-24	Spanner with Pivots	X	X		
VCM-260	0260	M-82880	88212-24	Knurled Nut - Now S/S	X	X		
NEW VCM-265	0265	M-82885	88201-24	Shaft Sleeve	X	X	X	X
VCM-295	0295	M-883004-1	88996-2	Wide S/S Knife (Sold 1x each)	X			
VCM-296	0296	M-83004-2	88996-4	Wide S/S Knife (Sold 1x each)		X	X	
VCM-297	0297	M-83006-1	88993-2	Narrow S/S Knife (Sold 1x each)	X			
VCM-298	0298	M-83006-2	88993-4	Narrow S/S Knife (Sold 1x each)		X	X	
VCM-377	0377	M-88258-2	88999-4	Aluminum Knead Shaft-VCM 40		X		
VCM-512	1512	M-84037	88026-24	Bakelite Knob	X	X		
VCM-837	6837	M-82984	88029-24	Lock Nut for the Knife Shaft	X	X		
NEW VCM-2231/2	2231 2232	N/A	3-M4023-03 3-I011202	Glass Inspection Kit with Silicone Gasket			X	X

The above parts are sold by Alfa International as replacement parts for Hobart, Stephan and Berkel. Alfa is not affiliated with these firms.