



# Sleek Shields™

## CAFETERIA GLASS FOOD SHIELDS

### For Advance Tabco Hot/Cold Tables

Protected By: Patent No. US 9,010,883 B2

Item #: \_\_\_\_\_ Qty #: \_\_\_\_\_  
 Model #: \_\_\_\_\_  
 Project #: \_\_\_\_\_



FEATURING ADVANCE TABCO'S REVOLUTIONARY  
 CHAMBER LOCK™ ROTATION SYSTEM

Front Glass Locks Into Place At 15° Intervals

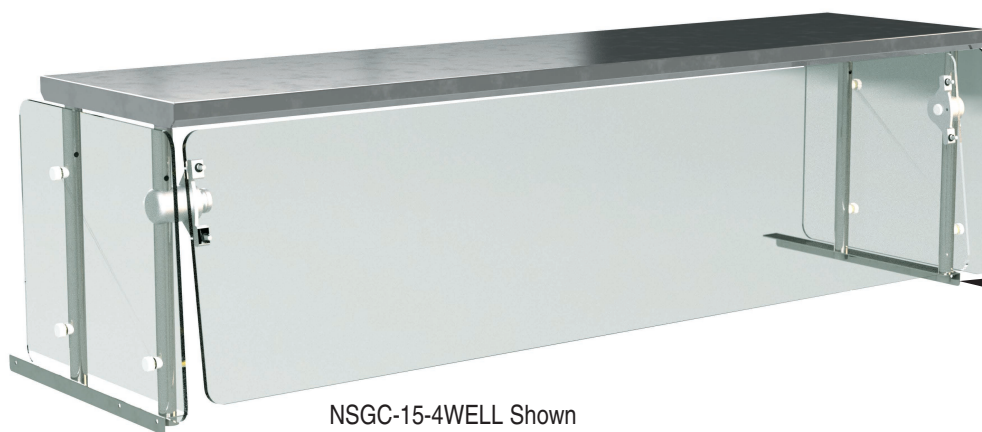

NSGC-15-4WELL Shown

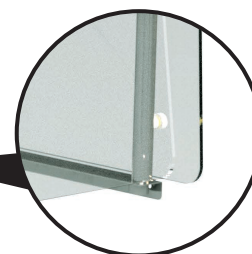

Includes TA-47  
 Mounting Brackets  
 For In-Field Installation

#### FEATURES:

Front glass locks in place at 15° intervals.  
 Attractive, low profile design & easy to clean.  
 1" Stainless steel posts.  
 Chamber lock™ is mounted to post in a fixed position.  
 Includes two 16-3/8" high side panels.  
 1/4" Thick heat-tempered front & side glass.  
 (3/8" Thick heat-tempered front glass for 4 well unit).  
 Includes 15" wide stainless steel shelving.  
 Shelf has square edges on all four sides.  
 Ships KD.

#### MATERIAL:

1/4" Thick Heat-Tempered Front & Side Glass.  
 (3/8" Thick Heat-Tempered Front Glass For 4 Well Unit).  
 Shelf - 18 Ga., Type 430 Stainless Steel with  
 1" Post - Stainless Steel.  
 Chamber Lock™ - Anodized Aluminum.  
 TA-47 Mounting Brackets  
 Finish - Aluminum components manufactured with a standard Satin  
 Clear Finish. Other colors available for Aluminum Components  
 Only. Please consult factory for additional colors.

15" Wide Stainless Steel Shelf					
Model #	O.A. Size L x W x H	(A) Length	Description	Approx. Wt.	Approx. Cubes
NSGC-15-2WELL	33 11/16" x 18" x 18 3/4"	31 13/16"	Fits 2-Well Unit	135 lbs.	15
NSGC-15-3WELL	49" x 18" x 18 3/4"	47 1/8"	Fits 3-Well Unit	176 lbs.	22
NSGC-15-4WELL*	64 5/16" x 18" x 18 3/4"	62 7/16"	Fits 4-Well Unit	232 lbs.	29
NSGC-15-5WELL**	79 5/8" x 18" x 18 3/4"	77 3/4"	Fits 5-Well Unit	265 lbs.	38
NSGC-15-6WELL**	94 15/16" x 18" x 18 3/4"	93 1/16"	Fits 6-Well Unit	300 lbs.	47

\*3/8" Thick Heat-Tempered Glass Required For Front Glass \*\*Requires a Single Center Post (Factory Print Included)

**NOTE: Due to mounting requirements, food shields extend 15/16" beyond the end of the hot or cold food table on each end. Units set side by side must allow for this additional space.**



Meets Latest  
 NSF Standards



Customer Service Available To Assist You **1-800-645-3166** 8:30 am - 7:00 pm E.S.T.

For Orders & Customer Service:

Email: customer@advancetabco.com or Fax: 631-242-6900

For Smart Fabrication™ Quotes:

Email: smartfab@advancetabco.com or Fax: 631-586-2933

# DIMENSIONS and SPECIFICATIONS

TOL  $\pm .125"$

ALL DIMENSIONS ARE TYPICAL

Maximum Front Glass Opening is 1 1/2" From Table To Bottom Of Glass. NSF Requires Side Glass To Be 18" Wide Minimum.

**NOTE:** Due to mounting requirements, food shields extend 15/16" beyond the end of the hot or cold food table on each end.  
Units set side by side must allow for this additional space.

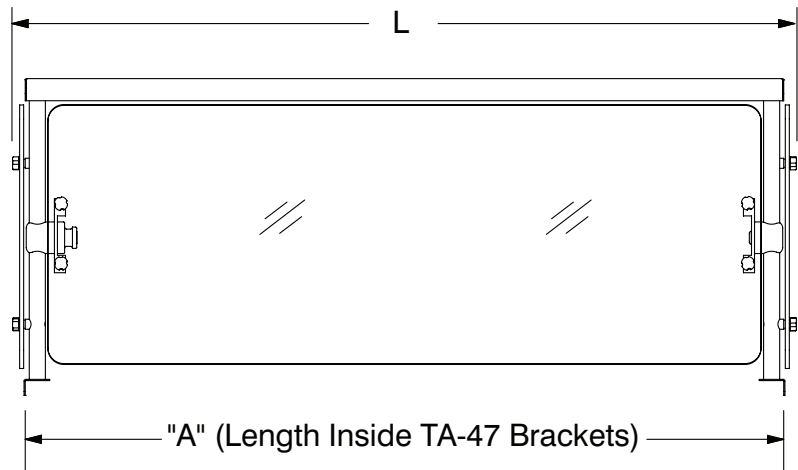
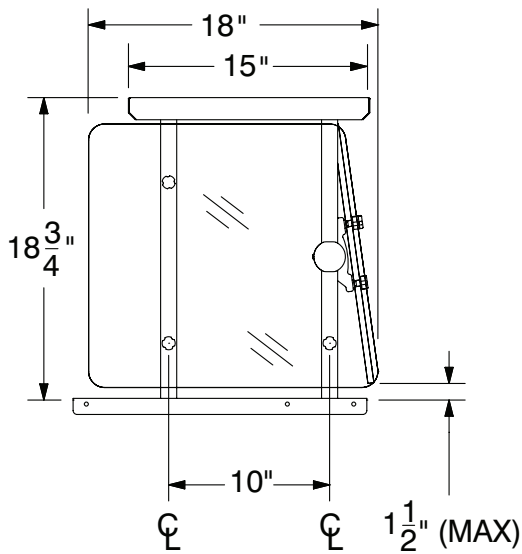

## Single Post w/ Cantilever Bracket Available

- Can not replace standard end posts/brackets
- May be used to eliminate a post located in the middle of the unit

### SG-C

