

norpole

2 Door Direct Draw Beer Cooler ♦ NPBT-60



Standard Features

- ♦ Two separate beer taps
- ♦ Interior LED lighting
- ♦ Accommodates two 1/2 barrel kegs
- ♦ Replaceable draw handles
- ♦ Stainless steel top
- ♦ Black vinyl coated back, sides, and doors
- ♦ Approved to NSF standards

Technical Specifications

Product Classification	Refrigerator
Climate Class	N
Number of Doors	2
External Cabinet Material	Wear Resistant Vinyl
Internal Cabinet Material	Epoxy Coated Aluminum
Type of Refrigeration Agent	R-290
Type of Temperature Control	Digital
Temperature Range °C	0°C to 3.3°C
Temperature Range °F	32°F to 38°F
Voltage / Frequency	115V / 60Hz
Amp	3.0
Compressor HP	1/5
Type of Insulation	1.6-Inch Polyurethane Foam
Door Handle	Recessed

Certified Safety Standard

- ♦ ETL Listed
- ♦ ETL Sanitation Listed



Warranty Information

- ♦ 5 Years Compressor
- ♦ 3 Year Parts & Labor





2 Door Direct Draw Beer Cooler ♦ NPBT-60

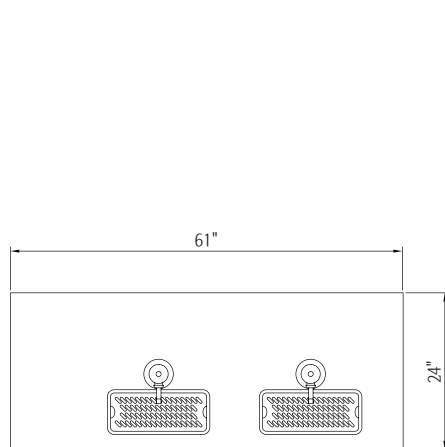

Top View

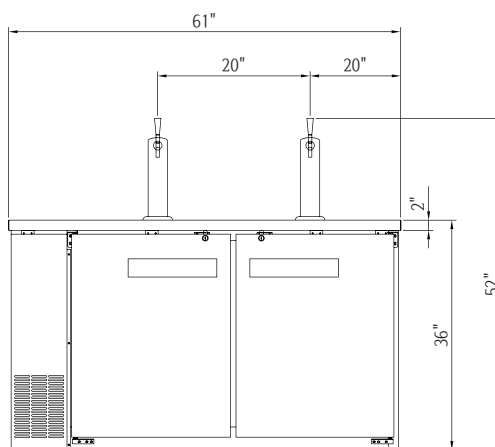

Front View

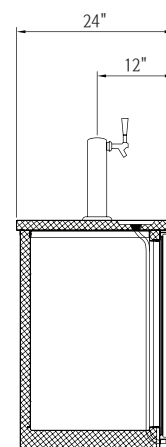

Side Section



Plug Type: (NEMA) 5-15P

Capacity

Gross Capacity	16 cu. ft.
Storage Capacity	(2) 1/2 Barrel

Dimensions

External Width	61 in
External Depth	24 in
External Height	36 in
Shipping Dimensions (W x D x H)	63 x 27 x 42 in

Weight

Gross Weight	290 lbs.
--------------	----------

Accessories

Castor Wheels	Optional
Frost Free	Yes
Epoxy Coated Divider	Yes
Adjustable Thermostat	Yes