

**Code****AC961I****Model****MEAT PANORAMA 1500 BLACK 115/60****cETLus certification: PENDING****Building characteristics**

INSIDE covering			Mirror-polished S/S /
OUTSIDE covering			Black plastic-coated S/S /
Internal temp range			[ +32°F ÷ +50°F ]
Thickness of insulation: High density polyurethane foam (42 kg/m <sup>3</sup> ) without HCFC	in.	2.95	
Voltage V-Ph-Hz	115/1N/60		
Absorbed Power / Current	Kw 1.56 / Amps 15.8		
Includes:	n° 6 pairs of S/S shelf brackets - n° 6 S/S wire shelves 25.59"x20.87" - hook rail with 4 hooks rod (110.23 lbs)		
Electronic controller	TOUCHSCREEN		
HACCP Loggin Function	✓		
USB	✗		
WiFi/Bluetooth Connection	✓		
Key lock	✓		
Internal light	✓		
U.V. Lamps	✓		
Water condensing unit	Optional		
Net Weight	lbs.		712
		Packed	773.8
Cooling Capacity	ASHRAE	Watt	T. evap. +14°F / +131°F T.cond
			1131
Capillary / Thermostatic Valve			Cap.
Evaporator fan	Ø - Watt-Volt	2x9.84Ø-12W-115V	
Defrosting/heating	Watt	375W x 2/200W x 4	
Relative humidity	40% - 90%		
Internal storage capacity	lbs.	661.39	
Compressor	NT6220UV		
Condenser fan	Ø - Watt-Volt	1x7.87Ø-12W-115V	
Refrigerant	oz.	R290 GWP: 3 4.59	
Noise	Db(A)	58.6	

Code	AC9611
Model	MEAT PANORAMA 1500 BLACK 115/60
External dimensions packed	60.63"x34.65"x87.99"

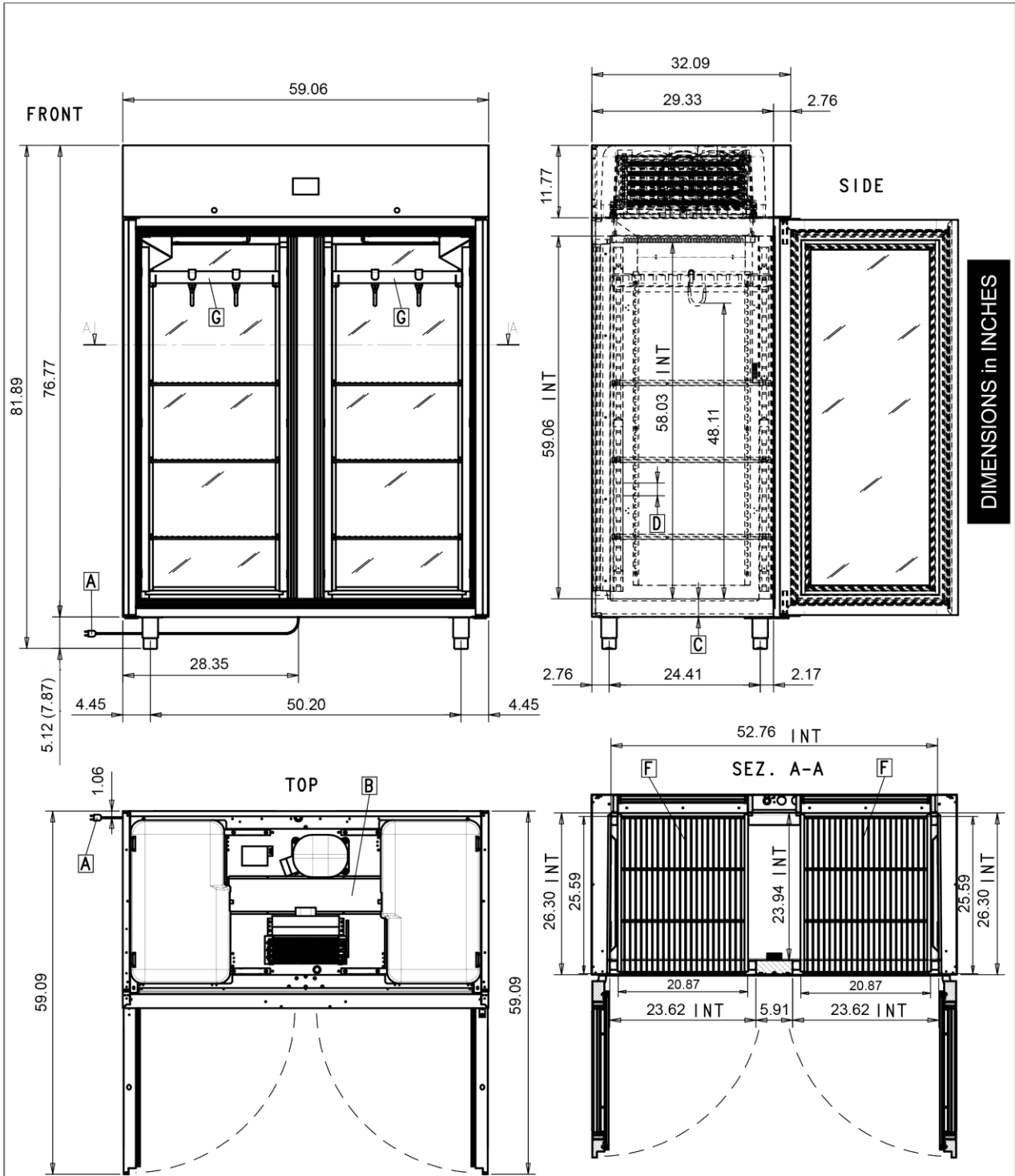

DIMENSIONS in INCHES

- A = Electrical connection L. 6.9 ft
- B = Condensate drain pan
- C = 2.95 inches thick insulation
- D = Rack pitch 2.09 inches
- E = Right hinged door. left hinged option available
- F = N°6 stainless steel wire shelves 20.87x25.59 inches included
- G = Hook rail for meat with 4 hooks rod

La ditta Everlasting s.r.l si riserva il diritto di apportare ai propri prodotti quelle modifiche tecniche e stilistiche che riterrà necessarie o utili senza pregiudicare le caratteristiche essenziali. Everlasting reserves the right to modify technical and stylistic features of its products without any prior notice, should such modifications be necessary or useful and not affecting any essential features of the product itself.