



## 36-Inch Gas Charbroiler ♦ MCCCCB36A



### Standard Features

- ♦ 120,000 BTU output
- ♦ Easy to clean grease trap
- ♦ Heavy duty cast iron 24.3" x 5.6" x 0.83" (616 x 149 x 21 mm) grill grates
- ♦ Cast iron burners with built-in deflectors
- ♦ Bullnose edge
- ♦ Adjustable Incline Grate, reversible for increased versatility
- ♦ Heavy Duty Chrome Plated comfort grip knobs

### Exterior Features

- ♦ Stainless steel body and legs
- ♦ 6" Adjustable legs

### Certified Safety Standard

- ♦ ETL Certified
- ♦ ETL Sanitation Listed



### Warranty Information

- ♦ One year on-site Parts and Labor





## 36-Inch Gas Charbroiler ♦ MCCC36A

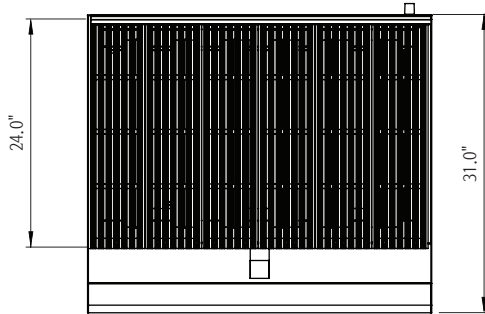

Top View

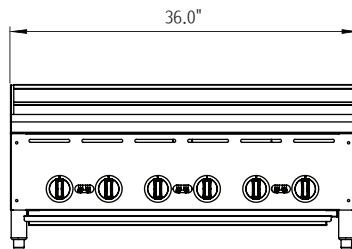

Front View

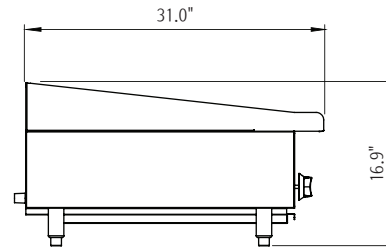

Side View

Model		MCCC36A	MCCC36A-P (Propane)
Gas Output	BTU	120,000	120,000
	(KW)	35.1	35.1
Number of Burners		6	6
Shipping Weight (Lbs)		308.7	308.7
Manifold Pressure	Natural Gas	4" W.C.	-
	Propane Gas	-	10" W.C.
Manifold Size		3/4"	3/4"
Burner Orifice Size		44/2.18mm	54/1.38mm
Cooking Area (Sq. In.)		816.5	816.5
Dimensions (W x D x H)		36.0" x 31.0" x 17.0"	36.0" x 31.0" x 17.0"
Crated Dimensions (W x D x H)		40.9" x 35.8" x 20.5"	40.9" x 35.8" x 20.5"

### Clearance requirements:

- For use only on non-combustible floors.
- Legs or casters are required for non-combustible floors.

Clearance requirements	Combustible Surfaces	Non-combustible Surfaces
Rear	6" ~ 8"	0"
Left	6" ~ 8"	0"
Right	6" ~ 8"	0"

### Options and accessories