



Project _____
 AIA # _____ SIS # _____
 Item # _____ Quantity _____ C.S.I. Section 114000



TU SERIES

TU SERIES

Full Size Undercounter Quick Chiller

Self-Contained



(Shown with optional casters, hinging and bullnose top)

STANDARD PRODUCT FEATURES

- Stainless Steel Exterior & Interior
- Reliable Microprocessor Control With LED Temperature Display
- High Performance Refrigeration System, Rapidly Circulates 31-34°F Cold Air For Enhanced Storage and/or Maximum Product Cooling
- Front-Breathing Design for "Zero-Clearance" Installation
- Non-Electric Automatic Condensate Evaporator
- Condenser Filter Facilitates Condenser Coil Cleaning
- Controllable Anti-Condensate Door Perimeter Heaters
- Metal Door Handle with Gasket Guard
- Self-Closing Door with Stay-Open Feature
- Standard Door Hinging: Right Hinging (field reversible)
- Two (2) Wire Shelves (factory installed)
- Magnetic Snap-In EZ-Clean Door Gasket(s)
- Gasket-Protecting Stainless Steel Door Liner
- Hot Gas Evaporator Defrost
- Thermostatic Expansion Valve Metering Device
- Side, Front & Rear Access Panels for Ease of Service and Maintenance
- Left-Hand Refrigeration System Location
- 9' Cord & Plug Attached
- 6" High Legs on Adjustable Channel System
- 3-Year Parts & Labor Warranty
- 2-Years Additional Compressor Parts Warranty



Intertek

This unit is listed to UL 471, CSA 120 and NSF 7 by an approved NRTL. Consult the factory or unit data plate for approval information.

ACCESSORIES & OPTIONS (*field installed)

- Stainless Steel Bullnose Top
- Stainless Steel Bullnose Top with 4" High Backsplash
- Additional Wire Shelves
- Five (5) Pairs Universal Type Tray Slides (each pair of slides accommodates either one 18" x 26", two 12" x 20", or two 14" x 18" pans)
- Set of 4" or 6" High (installed height) Casters In Lieu of Legs
- Refrigeration System Relocated To The Right Side
- Door Lock

AVAILABLE CONFIGURATIONS

| Model | Model Type |
|---------|------------------|
| TU048QC | 48" 1-Door Model |

Approved by _____ Date _____ Approved by _____ Date _____



MODEL

TU048QC

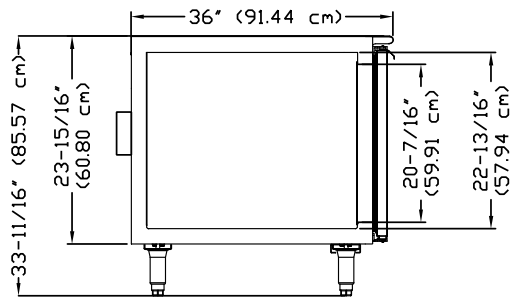
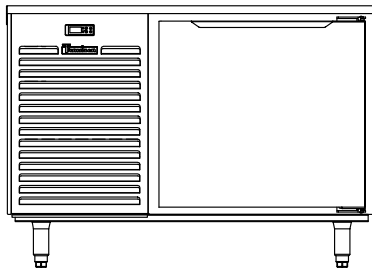
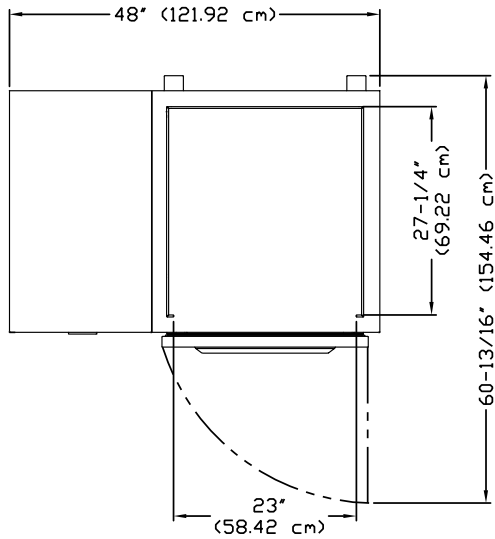



TU SERIES

Full Size Undercounter Quick Chiller

Self-Contained

MODEL

TU048QC

| MODEL | TU048QC |
|--|-------------------------------|
| DIMENSIONAL DATA | |
| Net Capacity cu. ft. | 9.2 (260.5 cu l) |
| Length - Overall in. | 48 (121.9 cm) |
| Depth - Cabinet Only in. | 31 $\frac{1}{4}$ (79.4 cm) |
| Depth - Overall in. | 36 (91.4 cm) |
| Depth - Door Open 90° in. | 60 $\frac{13}{16}$ (154.5 cm) |
| Clear Door Width in. | 23 (58.4 cm) |
| Clear Door Height in. | 24 $\frac{1}{8}$ (60.9 cm) |
| Height - overall on 6" legs ¹ | 33 $\frac{3}{4}$ (85.6 cm) |
| Height - overall on 6" legs ² | 34 (86.4 cm) |
| No. Standard Shelves | 2 |
| Shelf area sq. ft. ³ | 8.2 (.8 sq m) |
| ELECTRICAL DATA | |
| Voltage | 115/60/1 |
| NEMA Plug Type | 5-15P |
| Full Load Amps | 12.0 |
| REFRIGERATION DATA | |
| Refrigerant | R-448A |
| Refrigerant Charge Amt. oz. | 22 (623.69) |
| BTU/HR H.P. ⁴ | 6310 $\frac{3}{4}$ HP |
| SHIPPING DATA | |
| Length - Crated in. | 66 (167.6 cm) |
| Width - Crated in. | 42 (106.6 cm) |
| Height - Crated in. | 35 (88.9 cm) |
| Volume - Crated cu. ft. | 56 (1585.7 l) |
| Weight lbs. - Crated | 430 (195.5 kg) |

NOTES: Figures in parentheses reflect metric equivalents.

1. Height shown without optional top.
2. Height shown with optional top.
3. Area of standard shelf compliment only, does not include storage area of additional shelves or available on cabinet bottom.
4. Based on a 90°F ambient and 15°F evaporator.
 - Full load amps and plug style may vary depending on electrical options chosen and condensing unit employed.
 - An optional stainless steel worktop is required on full size undercounter models being used to support equipment weighing in excess of 100 lbs. or producing heat in excess of 140°F to the top surface.
 - When ordering please specify: Voltage, Hinging, Options and any additional warranties.

EQUIPMENT SPECIFICATIONS

CONSTRUCTION, HARDWARE, INSULATION

Cabinet exterior and interior are constructed of stainless steel. The exterior cabinet back and bottom are constructed of heavy gauge galvanized steel. A set of 6" high stainless steel legs are included standard.

Door is equipped with a gasket protecting metal door pan and gasket guard, and includes both a self-closing and stay open feature. Gasket profile and durable material simplify cleaning and increase overall gasket life. Anti-condensate heaters surround the door opening. Both cabinet and door are insulated with an average of 2" thick high density, non-CFC, foamed in place polyurethane.

INTERIOR

Standard interior arrangements include two (2) wire shelves per section, mounted on shelf pins. Recommended load limit per shelf should not exceed 225 lbs.

REFRIGERATION SYSTEM

The self-contained, balanced refrigeration system using environmentally friendly, non-flammable R-448A refrigerant features a hot gas evaporator defrost, thermostatic expansion valve, air-cooled hermetic compressor, large high-humidity evaporator coil and an automatic condensate evaporator. A 9' cord and plug is provided. Standard operating temperature is 31-35°F.

CONTROLLER

The easy to use water resistant microprocessor control system is supplied standard. It includes a 3-Digit LED Display, Fahrenheit or Celsius Temperature Scale Display Capability.

DOMESTIC WARRANTY

Both a three year parts and labor warranty and an additional two year compressor parts warranty (self-contained models only) are provided standard.

CONTINUED PRODUCT DEVELOPMENT MAY NECESSITATE SPECIFICATION CHANGES WITHOUT NOTICE.