

Insulated Direct Steam Kettle

**Full Jacketed
Insulated for Safety™
Deep Drawn Construction
Stationary, Leg Mounted
Made in USA**

**LOW-RIM™ Model
LSI**

STANDARD FEATURES



Model LSI-40

- ◆ The Legion 316 Kettle System
 - ◇ 316L stainless liner
 - ◇ 316 stainless draw-off tube and welds
 - ◇ 316 stainless 1½" compression draw-off valve
- ◆ 304L stainless kettle jacket
- ◆ 304 stainless leg socket supports, seam welded to jacket
- ◆ 304 stainless legs provided with reinforcing bracing
 - ◇ 4 legs for 20 - 30 gallon, 1 5/8" diameter
 - ◇ 4 legs for 40 - 100 gallon, 2" diameter
- ◆ Adjustable flanged feet
- ◆ 304 stainless, one piece, domed cover, actuator-assisted on 40 - 100 gallon
- ◆ Full body insulation (3" - 14") between kettle jacket and outer casing
- ◆ 304 stainless outer casing seam welded to the 3" reinforced radius lip
- ◆ Condensate drain and steam supply provided with rear connections
- ◆ Front mounted steam control valve
- ◆ 30 psi operating pressure
- ◆ Perforated disk strainer, 1/4" holes

Legion equipment is built to comply with applicable standards for manufacturers. Approval agencies may include ASME, NSF, UL, ETL, AGA, CSA, CGA, and others. Legion reserves the right of design improvement or modification as warranted.

Models and Capacities

LSI-20	20 gal.	76 l.
LSI-25	25 gal.	95 l.
LSI-30	30 gal.	114 l.
LSI-40	40 gal.	151 l.
LSI-60	60 gal.	227 l.
LSI-80	80 gal.	303 l.
LSI-100	100 gal.	379 l.

Optional Features and Accessories

See price list for supplemental information regarding options

Faucet Options:

- Single or double fill faucet with bracket & 12" or 18" swing nozzle
- 48" flexible spray hose assembly (vinyl or stainless) for use with dual or single fill faucet
- Faucet bracket
- Automatic water filling meter

(Call for information regarding additional faucet options)

Prison/Security Options:

- Fastener (nut for draw-off)
- Draw-off nut driver tool
- Lockable lid
- Draw-off protection
- Steam control valve protection

Other Options:

- Air eliminator valve
- Pressure reducing valve
- Connection plumbing parts kit
- Mixer/Agitator, 2 speed
- Lift-off cover
- 1 piece actuator-assisted cover, 20 - 40 gallon
- 2 piece hinged cover
- Higher operating pressure

Accessories:

- Single basket insert, 20 - 40 gallon
- Tri-basket insert
- Nylon bag insert with spreader ring
- Draw-off drain hose
- Measuring strip
- Perforated disk strainer 1/8" holes
- Kettle care kit

Select draw-off valve: 1.5" 2" 3"

With: compression ball type fitting

See price list for other draw-off options.

Revision 402



LEGION Legion Industries, Inc. ♦ P.O. Box F ♦ Dallas, PA ♦ 18612 ♦ (800) 833-9803
(570) 675-1595 ♦ Fax: (570) 675-7551 ♦ www.legionindustries.com ♦ sales@legionindustries.com

LOW-RIM™ Model LSI

Full Jacketed
Insulated for Safety™
Deep Drawn Construction
Stationary, Leg Mounted
Made in USA

Insulated Direct Steam Kettle

DRAWING REPRESENTS MODEL LSI-40

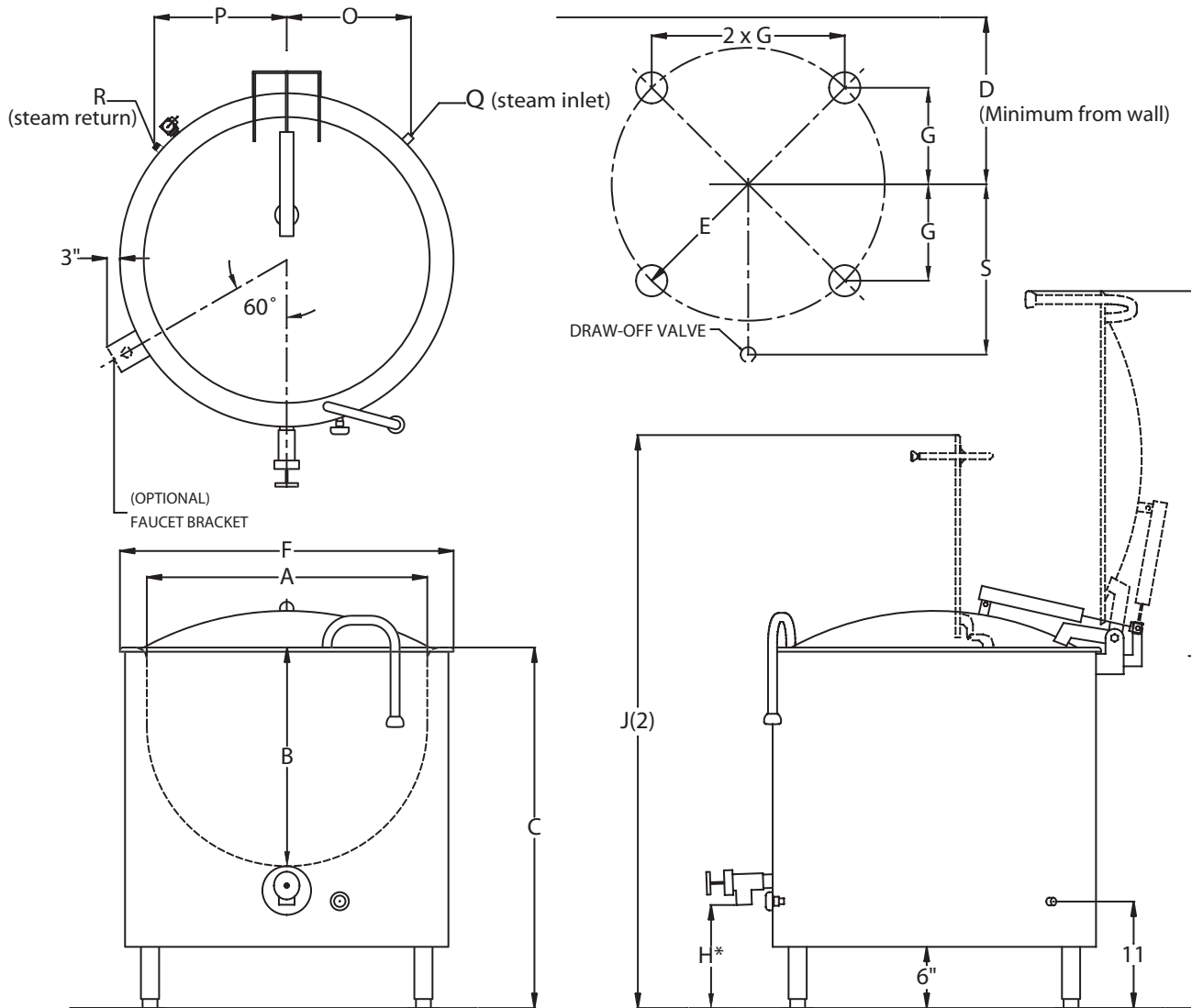

MODEL LSI DIMENSIONS

Gal.	A	B	C	D	E	F	G	H*(1.5")	H*(2")	H*(3")	J1	J2	O&P	Q	R	S
20	23.0	15.0	30.4	23.6	13.8	29.6	7.2	12.0	11.5	10.5	63.0	51.7	10.3	.75	.50	17.1
25	25.5	15.5	30.1	24.8	15.0	32.4	7.9	12.0	11.5	10.5	65.4	53.2	11.2	.75	.50	18.3
30	25.5	17.8	32.4	24.8	15.0	32.4	7.9	12.0	11.5	10.5	67.7	55.6	11.2	.75	.50	18.3
40	29.5	18.6	33.3	26.8	16.8	36.4	8.8	12.0	11.5	10.5	72.6	58.5	12.6	.75	.50	20.3
60	32.5	22.3	37.6	28.3	18.3	39.6	9.6	12.0	11.5	10.5	80.3	65.8	13.7	1.0	.75	21.8
80	39.0	21.9	36.8	31.6	21.6	45.7	11.3	12.0	11.5	10.5	85.5	68.4	16.0	1.0	.75	25.1
100	44.0	22.5	37.6	34.1	24.1	50.4	12.6	12.0	11.5	10.5	91.0	71.5	17.7	1.25	.75	27.6

*"H" dimension varies with draw-off size selection.

Revised 402



LEGION Legion Industries, Inc. ♦ P.O. Box F ♦ Dallas, PA ♦ 18612 ♦ (800) 833-9803
(570) 675-1595 ♦ Fax: (570) 675-7551 ♦ www.legionindustries.com ♦ sales@legionindustries.com

MIXER HEADS

**TWIN SHAFT AGITATOR
FIXED MOUNT, TILT OUT
MADE IN USA**

MODEL MV MIXER

STANDARD FEATURES



Model TWT-80 with mixer and optional bottom mounted butterfly valve



Model LGB-40



Model TWU-40

- ◆ Enclosed, balanced, aluminum, mixer bridge
- ◆ Totally enclosed gear motor
 - ◇ Aluminum cast housing
 - ◇ Right angle output shaft
 - ◇ Single speed type (5 - 10 gallon)
 - ◇ Two speed type (20 - 100 gallon)
- ◆ 304 stainless steel anchor type main agitator shaped to contour of kettle
- ◆ Removable nylon blades scrape entire kettle surface
- ◆ 304 stainless steel secondary counter-rotating beater located between center shaft and outside arm of main agitator
- ◆ Main agitator and secondary beater are bayonet mounted for easy, quick removal for cleaning or when kettle is to be used as a stationary or tilt kettle without the mixing mechanism
- ◆ Actuator-assisted agitator, scraper and bridge lift
- ◆ Positive quick acting rim lock and latch mechanism
- ◆ Safety device prevents high speed starts
- ◆ Mixing device stops when bridge is lifted
- ◆ Two speed agitator switch
- ◆ 15 : 1 gear head reduction ratio
- ◆ 2.6 : 1 secondary beater / main agitator ratio

Legion equipment is built to comply with applicable standards for manufacturers. Approval agencies may include ASME, NSF, UL, ETL, AGA, CSA, CGA, and others. Legion reserves the right of design improvement or modification as warranted.

DESIGN FEATURES

Call for supplemental information regarding options

- Alternate rim lock mechanism location
- Single or twin design
- Customized frame design
- 10 : 1 gear head reduction ratio
- 25 : 1 gear head reduction ratio
- 1.57 : 1 beater / scraper ratio
- 1.47 : 1 beater / scraper ratio

Select mixer voltage: 115V* 208V 230V 460V

Select mixer phase: 1 3

Select mixer hertz: 50 60

*1/3 HP motor only.

Note: Not all kettle options are available on kettles with mixers.

AGITATOR MOTOR HORSEPOWER AND R.P.M.

Standard gear head ratio is 15 : 1
Standard main agitator / secondary beater ratio 2.6 : 1

GAL.	HORSEPOWER		R.P.M. MAIN AGITATOR*	R.P.M. SECONDARY BEATER*
5 - 10	Single speed	1/3	17	43
	High	1	46	120
20 - 30	Low	1/2	23	60
	High	1 1/2	46	120
40 - 60	Low	3/4	23	60
	High	2	46	120
80 - 100	Low	1	23	60

*Based on standard gear head ratio and standard main agitator and secondary beater ratio. Contact Legion for applicable information on optional gear head ratio and main agitator and secondary beater ratios.

Revision 999



LEGION The Finest American Quality Since 1897

LEGION INDUSTRIES, INC. ♦ 69 MAIN ST. ♦ DALLAS, PA 18612 ♦ (800) 833-9803 ♦ (570) 675-1575 ♦ FAX: (570) 675-7551

MODEL LM MIXER

SINGLE SHAFT PORTABLE MIXER
CLAMP OR FIXED MOUNT
MADE IN USA

MIXER HEADS

STANDARD FEATURES



- ◆ Easy-positioning handle facilitates proper in-tank placement
- ◆ Standard Dura-Mix motor is specifically designed for mixer service
- ◆ Motor and shaft are coupled directly with pilot and keyway for accurate alignment and positive connection
- ◆ One piece aluminum housing provides exact alignment and superior mechanical strength
- ◆ Positive chuck grips the tapered flat on the mixer shaft to prevent unintentional shaft release. For added stability, rigid coupling is standard for longer shafts. Coupling is welded to the shaft.
- ◆ Built-in dampener pad between housing ball and clamp socket minimizes vibration.
- ◆ Clamp mount or fixed mount
- ◆ Mixer adjusts 90° vertically, 360° horizontally for optimal in-tank positioning.
- ◆ High-performance impellers to meet specific mixing requirements

Model LGB-60 with custom clamp mount portable mixer
and custom cut-out lid

DESIGN FEATURES

Call for supplemental information regarding options

- Custom fixed mount position
- Custom clamp mount position

Select voltage: 208V 240V 380V 415V 440V 480V

Select phase: 1 3

Select hertz: 50 60

Mixer selection

To determine your mixer selection, identify the following:

- √ Product to be mixed
- √ Viscosity value of product to be mixed
- √ Temperature of product to be mixed
- √ Specific gravity of product to be mixed
- √ Kettle capacity in gallons

Note: Not all kettle options are available on kettles with mixers.



LEGION The Finest American Quality Since 1897

LEGION INDUSTRIES, INC. ♦ 69 MAIN ST. ♦ DALLAS, PA 18612 ♦ (800) 833-9803 ♦ (570) 675-1575 ♦ FAX: (570) 675-7551