

# INSTALLATION INSTRUCTIONS BUILT-IN NARROW DRAWER WARMERS MODELS RWN-16 (T)

## ELECTRICAL

MODEL	VOLTS	WATTS	AMPS	PHASE	FIELD WIRING GAUGE	TEMP. RATING
RWN-16	120	450	3.8	SINGLE	14	90°C
RWN-16	208	338	1.6	SINGLE	14	90°C
RWN-16	240	450	1.9	SINGLE	14	90°C

INCHES  
(MM)

ALL MODELS WITH A 'T' SUFFIX HAVE THE SAME ELECTRICAL SPECIFICATIONS AS THE STANDARD VERSIONS.

## CUTOUT DETAILS

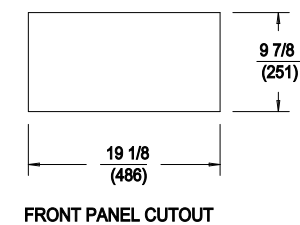

## PRODUCT DIMENSIONS

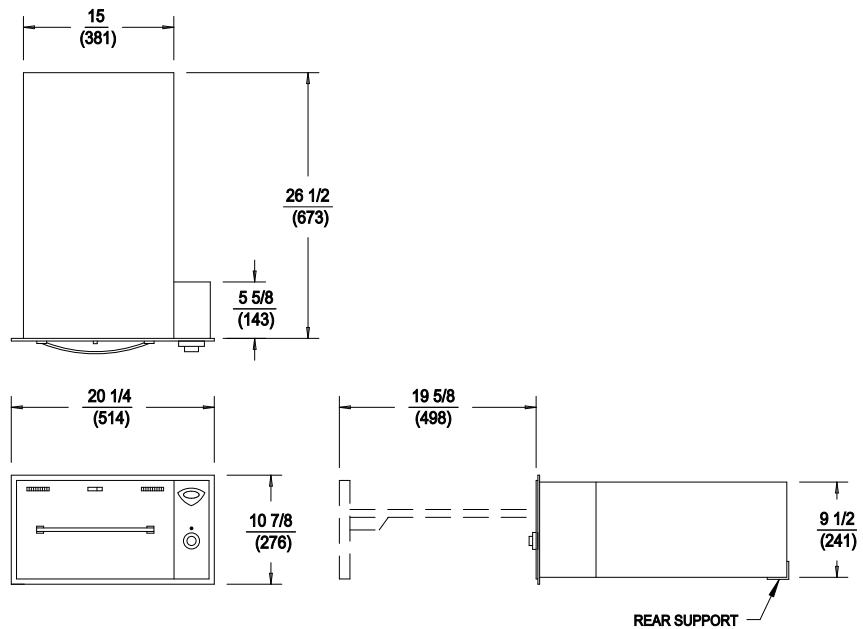

## CLEARANCES

THERE ARE NO CLEARANCE REQUIREMENTS FOR THIS UNIT.

## INSTALLATION INSTRUCTIONS

INSTALLER MUST MEET CONDITIONS OF ACCEPTABILITY OUTLINED BELOW UPON INSTALLATION:

### TO FABRICATE:

1. Layout front panel cutout dimensions and cutout hole in counter front panel.
2. Position attaching flange (supplied) in hole cutout to determine screw hole location. Drill holes using #34 drill.
3. Attach flange to front panel using #6 screws provided.
4. Fabricate rails and rear support in locations shown.

### TO INSTALL:

1. For ease of installation, remove drawer from unit.
2. Slide unit through front panel opening until rear of unit engages rear support.
3. Remove control knob and control panel.
4. Install #8-32 speednuts on attaching flange, secure attaching flange to front panel, then secure unit to attaching flange using #8-32 flathead screws provided.
5. Connect service leads to the unit including ground wire.
6. Replace control panel and control knob.
7. Replace drawer.

