



## Back Bar - Solid Doors



### MR-15-US

Height ..... 36.50"  
 Length ..... 56.25"  
 Depth ..... 25.00"



### MR-25-US

Height ..... 36.50"  
 Length ..... 69.13"  
 Depth ..... 25.00"



### MR-30-US

Height ..... 36.50"  
 Length ..... 90.13"  
 Depth ..... 25.00"

## Features

- 24" deep stainless steel top
- Pre painted black steel exterior
- Pre painted white galvanized steel interior
- Self closing doors with safety stop at 120 degrees and recessed handles
- Door locks
- Heavy duty lift off chrome plated hinges
- Adjustable epoxy coated wire shelves
- Foamed in place high density CFC free polyurethane foam insulation provides a solid structure and low energy consumption
- Forced air evaporator for rapid temperature "Pull Down"
- Self contained heavy duty 134a condensing unit
- Incandescent interior light
- UL Classified to ANSI/NSF 7

Model No.	Description	Voltage	Amps	Temp	HP	Est. Ship Weight
MR-15-US	2 Door/4 Shelves	115	6.5	33°F - 41°F	1/4	335#
MR-25-US	2 Door/5 Shelves	115	8.7	33°F - 41°F	1/4	452#
MR-30-US	3 Door/ 7 Shelves	115	10.6	33°F - 41°F	1/3	530#



## Technical Data / Back Bar - Solid Doors

MODEL #	MR-15-US	MR-25-US	MR-30-US
<b>OUTSIDE DIMENSIONS</b>			
Depth w/bumper	25.00"	25.00"	25.00"
Length	56.25"	69.13"	90.13"
Height	36.50"	36.50"	36.50"
Door Size	31.38" x 19.25"	31.63" x 22.50"	31.63" x 22.50"
Door Type	2 swing	2 swing	3 swing
<b>INSIDE DIMENSIONS</b>			
Depth	19.88"	19.88"	19.88"
Length	52.25"	65.13"	86.13"
Height	31.69"	31.69"	31.69"
Shelf Size	(1) 32" x 17.25" (3) 18.125" x 17.25"	(3) 24" x 17.25" (1) 26.19" x 17.25" (1) 12.69" x 17.25"	(3) 21.75" x 17.25" (3) 24" x 17.25" (1) 12.69" x 17.25"
# of Shelves	4	5	7
Capacity: Cubic Foot	14.5	19	26
<b>SPECIFICATIONS</b>			
Operating Temperature	33°F-41°F	33°F-41°F	33°F-41°F
Refrigerant	134a	134a	134a
Compressor Size HP	1/4	1/4	1/3
Voltage	115	115	115
Amperage	6.5	8.7	10.6
Cord and Plug	yes	yes	yes
<b>SHIPPING DIMENSIONS</b>			
Depth	30.00"	30.00"	30.00"
Length	65.00"	75.00"	95.00"
Height	42.00"	42.00"	42.00"
Gross Weight lbs.	335	452	530
Cubic feet	40	54	70

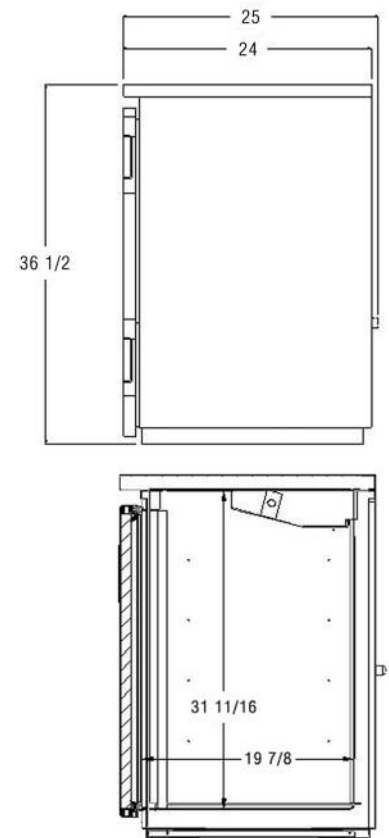

- Cases are designed to operate at 75°F and 55% relative humidity.
- Specification subject to change without notice.

