

# F18PDP

Self-Contained Refrigerated Dual Rail Prep Table with Flush Mount LiquiTec® Raised Rails

Project \_\_\_\_\_  
Item \_\_\_\_\_  
Quantity \_\_\_\_\_  
CSI Section 11400  
Approved \_\_\_\_\_  
Date \_\_\_\_\_

## Models

- F18PD48P 48" Dual Rail Prep Table with (4) 12"X20" pan openings
- F18PD72P 72" Dual Rail Prep Table with (6) 12"X20" pan openings



F18PD48P

## Standard Features

- Upper and lower rails are mechanically cooled utilizing LiquiTec® technology with die stamped 12"X20" openings
- Top is constructed of 16-gauge stainless steel
- Pans and adapter bars by others
- Flush mount NSF-7 certified pans
- High density environmentally friendly, Kyoto Protocol Compliant, Non ODP (Ozone Depletion Potential), Non GWP (Global Warming Potential) polyurethane foam throughout unit
- Dart style quick change gaskets
- Stainless steel removable hinged covers
- On/off switch is located behind the louver
- 1.50" diameter hole in louver for easy access to rail on/off switch
- 8' long electrical cord
- Environmentally friendly R290 refrigerant
- Electronic Controls
- One year parts and labor standard warranty

## Options & Accessories

- Stainless steel back
- Stainless steel ends
- Laminate facing (full front), end and/or back
- Tray racks
- Variable cutting board types and sizes
- Fixed and adjustable height casters
- Cheese grates with removable catch pans
- 27" wide refrigerated drawers (2) high, holds 6" deep pans
- Door/drawer locks
- Celsius readout for electronic control
- Adapter bars and pans
- 220V/50 cycle electrical available in 404a custom sku# version
- Inclusion of these options will alter the electrical specifications of unit
- Remote refrigeration (contact factory)
- Celsius readout for electronic control

## Specifications

**Exterior Top:** Constructed of one-piece 16-gauge stainless steel, with integral 2.12" (5.4cm) high square nosing at the front. Top has two mechanically cooled LiquiTec® refrigerated raised rails at the rear with openings to accommodate pans (provided by others). Rail interiors are 22-gauge stainless steel. Raised rail openings have 18-gauge stainless steel hinged removable lids. Unit is equipped with separate expansion valve and on/off switch for refrigerated rails. Temperature in top openings maintains 33°F (1°C) to 41°F (5°C) with pans flush mounted at 86°F (29.7°C) ambient room temperature, meeting NSF 7 requirements.

**Exterior Back, Bottom and Ends:** Unfinished galvanized steel back, bottom and exterior ends.

**Base Interior:** Stainless steel back and bottom. Base interior sides and door frames are thermoformed ABS plastic. Each interior door section has (1) 25" (63.5cm) deep removable epoxy coated wire shelf. Base is insulated with 2" (5.1cm) high density environmentally friendly, Kyoto Protocol Compliant, Non ODP (Ozone

Depletion Potential), Non GWP (Global Warming Potential) foamed in place polyurethane. End of base has a machine compartment with condensing units installed.

**Door(s):** 22-gauge stainless steel exterior front, with a thermoformed ABS plastic interior liner.

**Refrigeration System:** R290 refrigerant. Cabinet has (1) blower coil assembly with expansion valve on 48" and 72" models. Refrigerated base maintains temperature of 36°F (2°C) to 40°F (4°C). On/off switches for rail and base are located behind the louvered panel. A 1.50" diameter hole is on the louver for easy access to rail on/off switch. Electronic control for base reads air temperature. Electronic control for rail displays temperature for set point purposes only. Display does not reflect air or product temps in unit.

**Electrical Connections:** 115 volt, 60 Hertz, single phase. Unit is wired with 3-wire, grounded, maximum 8' (2.4m) cord and plug.

**Legs:** Equipment is mounted on 6" (15cm) legs.



## F18PDP

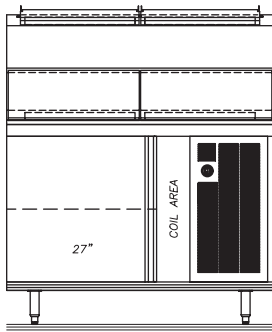
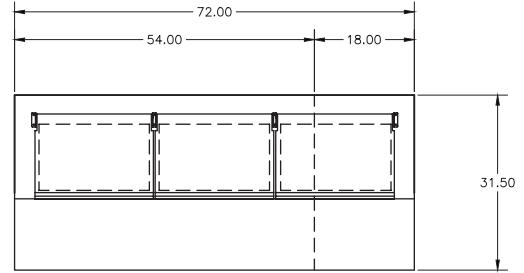
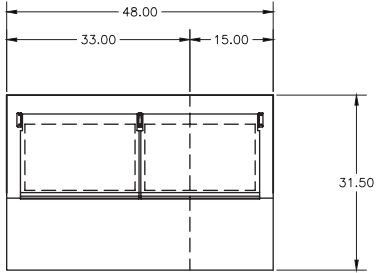

F1848PDP

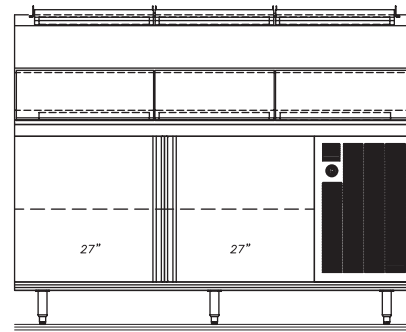

F1872PDP

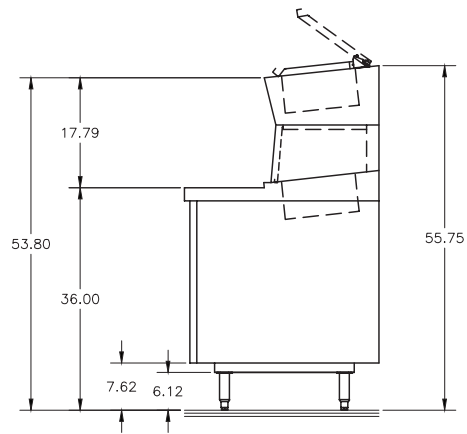

TYPICAL END

## Mechanical Data

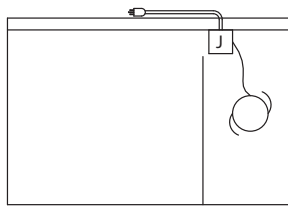

SELF CONTAINED

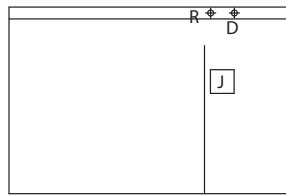

REMOTE

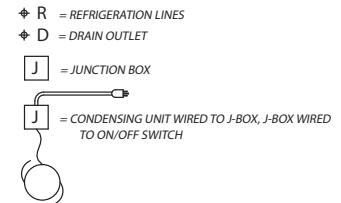

## Door Swing

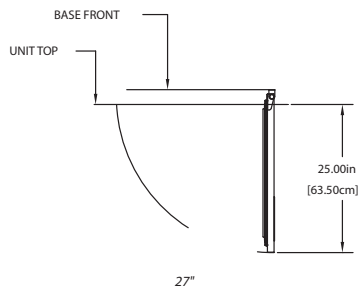

## Remote Appearance

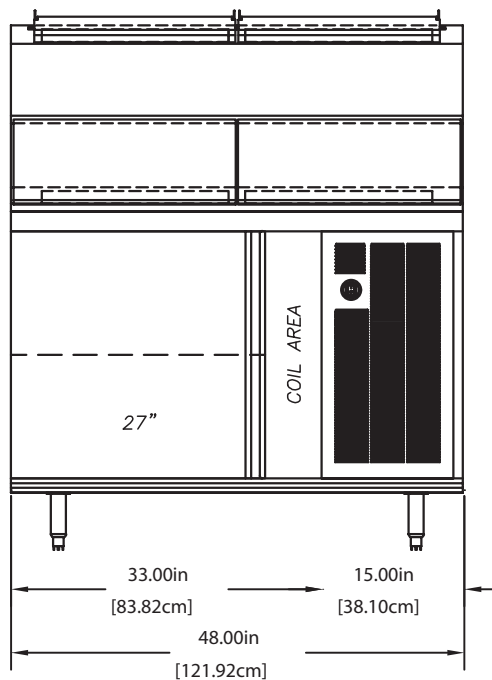

# F18PDP

## Specifications

Model	12" x 20" Pan Cap.	# of Shelves	Shelf Area	Volume	BTU Load @ 86F Base / Lower Rail / Upper Rai	BTU System Capacity @ 86F Base / Lower Rail / Upper Rail	H.P.	V/Hz/Ph	Amps	Nema Plug	Ship Weight
F18PD48P	4	1	3.95	8.41	270/152/253	2610/1127/829	1/3, 1/5	115/60/1	9.1	5-15P	691lbs/313kg
F18PD72P	6	2	7.9	15.42	488/273/456	2610/1669/1154	1/3, 1/5	115/60/1	9.1	5-15P	873lbs/396kg

Welbilt reserves the right to make changes to the design or specifications without prior notice.