

ITEM #: _____ QTY: _____

MODEL #: _____

PROJECT NAME: _____

103020

3601 S. Banker St. Effingham, IL 62401 • P.O. BOX 609 • Ph: (888) 431-2667 • Fax: (800) 433-2667

"PBHS-1410-KVMB" PRO-BOWL HAND SINKS - HANDS FREE



FEATURES:

- ONE PIECE DEEP DRAWN BOWL
- ALL SINK BOWLS HAVE LARGE LIBERAL RADII CORNERS
- INCLUDES BASKET DRAIN
- SPLASH MOUNT - ONCE FAUCET HOLE ON CENTER
- 1-1/2" DRAIN PLUMBING CONNECTION
- INCLUDES GOOSENECK SPOUT AND SINGLE OR DOUBLE PEDAL KNEE VALVE

CONSTRUCTION:

- BOWL: STAINLESS STEEL TOPS ARE TIG WELDED, EXPOSED WELDS ARE POLISHED TO MATCH ADJACENT SURFACE.

MATERIAL:

- BOWL: TYPE 300 STIANLESS STEEL POLISHED, SATIN FINISH
- BRACKET: TYPE 300 STIANLESS STEEL POLISHED, SATIN FINISH



PBHS-W-1410-KV1MB



PBHS-W-1410-KV1MB-SS

PRO-BOWL HAND SINKS - HANDS FREE

MODEL #	QTY
PBHS-W-1410-KV1MB	
PBHS-W-1410-KV1MB-SS	
PBHS-W-1410-KV2MB	
PBHS-W-1410-KV2MB-SS	

DETAILED SPECIFICATIONS

PBHS-W-1410-KV1MB

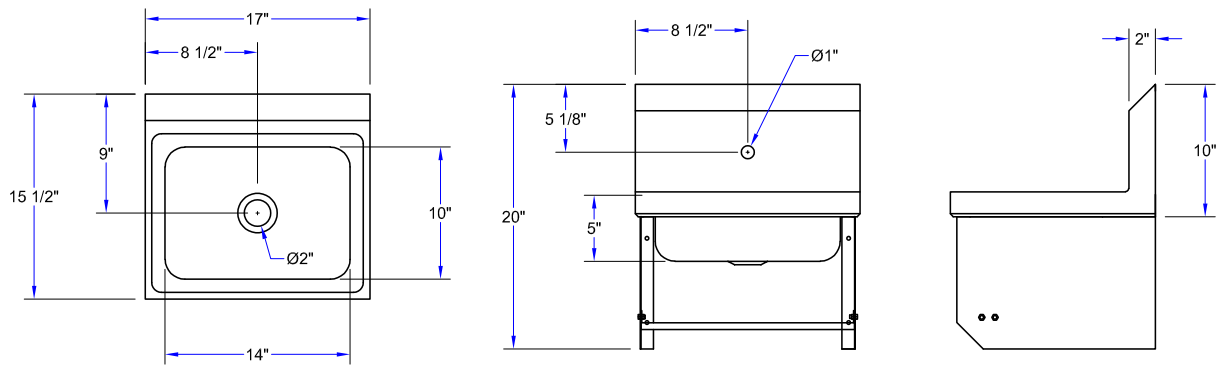

PBHS-W-1410-KV1MB-SS

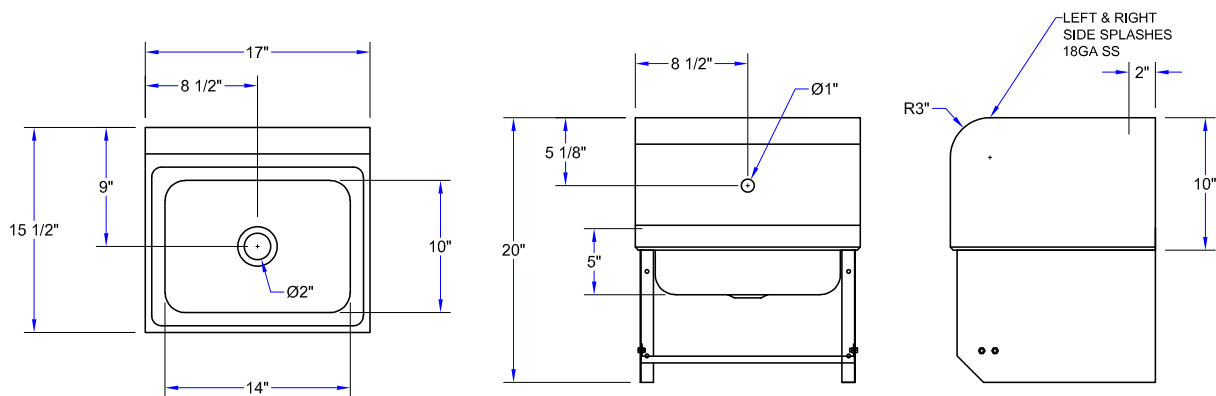

PRO-BOWL HAND SINKS - HANDS FREE

MODEL #	BOWL SIZE (LxWxD)	DRAIN SIZE	FAUCET LOCATION	SIDE SPLASH	KNEE VALVES
PBHS-W-1410-KV1MB	14" X 10" X 5"	1-7/8"	1 HOLE CENTERED (GOOSE NECK SPOUT & KNEE VALVE INCLUDED.)	N/A	SINGLE
PBHS-W-1410-KV1MB-SS	14" X 10" X 5"	1-7/8"	1 HOLE CENTERED (GOOSE NECK SPOUT & KNEE VALVE INCLUDED.)	LH & RH	SINGLE
PBHS-W-1410-KV2MB	14" X 10" X 5"	1-7/8"	1 HOLE CENTERED (GOOSE NECK SPOUT & KNEE VALVES INCLUDED.)	N/A	DOUBLE
PBHS-W-1410-KV2MB-SS	14" X 10" X 5"	1-7/8"	1 HOLE CENTERED (GOOSE NECK SPOUT & KNEE VALVES INCLUDED.)	LH & RH	DOUBLE

SOME UNITS SHIP UNASSEMBLED FOR REDUCED SHIPPING COST. ALL DIMENSIONS ARE TYPICAL. TOLERANCE +/- .500"

John Boos & Co. is constantly engaged in a program of improving products and therefore reserves the right to change specifications without prior notice.



Boos
lock

AQ AutoQuotes

3601 S. Banker St. • Effingham, IL 62401 • PO BOX 609 • quotes@johnboos.com

www.johnboos.com

103020

753