



**John
BOOS**
Since 1887

ITEM #: _____ QTY: _____

MODEL #: _____

PROJECT NAME: _____

110618

3601 S. Banker St. Effingham, IL 62401 • P.O. BOX 609 • Ph: (888) 431-2667 • Fax: (800) 433-2667

"CUT6" WELD-IN / UNDERMOUNT SINKS 16GA

ONE COMPARTMENT

FEATURES:

- STANDARD 16 GAUGE TYPE 300 STAINLESS STEEL WITH #4 POLISH, SATIN FINISH
- 8", 10", 12", OR 14" BOWLS
- ALL CORNERS, BOTH VERTICAL AND HORIZONTAL COVED AT 3/4" RADIUS
- BOTTOMS OF BOWLS FORMED FOR DRAINAGE TO 3-1/2" DIAMETER DIE STAMPED OPENING
- UNIFORM SINK BOWL THICKNESS

CONSTRUCTION:

- ALL TIG WELDED, EXPOSED WELDS ARE POLISHED TO MATCH ADJACENT SURFACE

MATERIAL:

- 16 GAUGE TYPE 300 STAINLESS STEEL WITH #4 POLISH, SATIN FINISH



WELD-IN / UNDERMOUNT SINKS 16GA

MODEL #	QTY
CUT2424146	
CUT1014086	
CUT1014106	
CUT1618126	
CUT1618146	
CUT1620126	
CUT1620146	
CUT1818126	
CUT1818146	
CUT1824126	
CUT1824146	
CUT2020086	
CUT2020126	
CUT2020146	
CUT2424126	

DETAILED SPECIFICATIONS

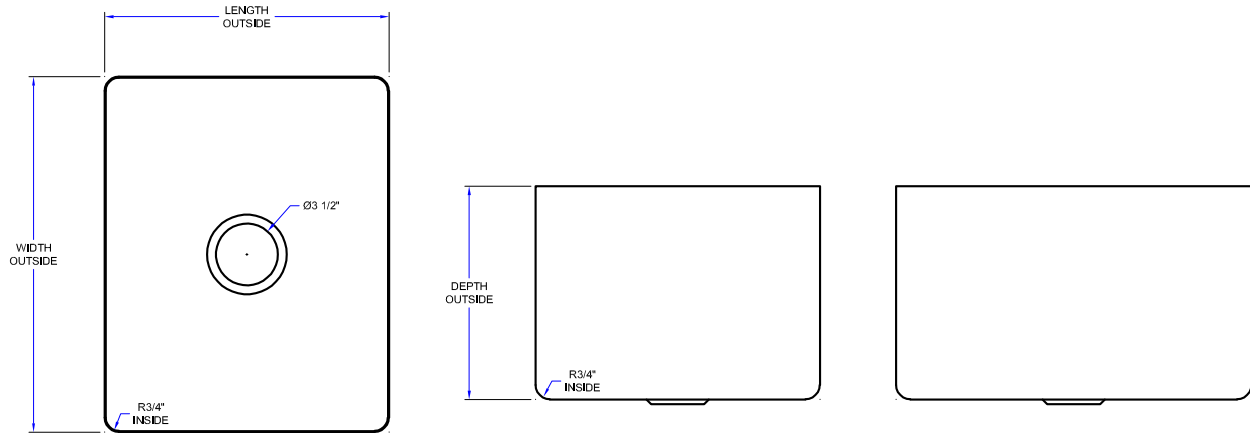

WELD-IN / UNDERMOUNT SINKS 16GA

MODEL #	INCLUDES	DIMENSIONS (W X L X D)	WEIGHT (LBS)
CUT1014086	CUTOUT, BOWL, FAUCET HOLES & WELDING/POLISHING (NOT AVAILABLE FOR FBLG & UFBLG)	10" X 14" X 8"	16
CUT1014106	CUTOUT, BOWL, FAUCET HOLES & WELDING/POLISHING (NOT AVAILABLE FOR FBLG & UFBLG)	10" X 14" X 10"	17
CUT1618126	CUTOUT, BOWL, FAUCET HOLES & WELDING/POLISHING (NOT AVAILABLE FOR FBLG & UFBLG)	16" X 18" X 12"	29
CUT1618146	CUTOUT, BOWL, FAUCET HOLES & WELDING/POLISHING (NOT AVAILABLE FOR FBLG & UFBLG)	16" X 18" X 14"	35
CUT1620126	CUTOUT, BOWL, FAUCET HOLES & WELDING/POLISHING (NOT AVAILABLE FOR FBLG & UFBLG)	16" X 20" X 12"	30
CUT1620146	CUTOUT, BOWL, FAUCET HOLES & WELDING/POLISHING (NOT AVAILABLE FOR FBLG & UFBLG)	16" X 20" X 14"	36
CUT1818126	CUTOUT, BOWL, FAUCET HOLES & WELDING/POLISHING (NOT AVAILABLE FOR FBLG & UFBLG)	18" X 18" X 12"	30
CUT1818146	CUTOUT, BOWL, FAUCET HOLES & WELDING/POLISHING (NOT AVAILABLE FOR FBLG & UFBLG)	18" X 18" X 14"	36
CUT1824126	CUTOUT, BOWL, FAUCET HOLES & WELDING/POLISHING (NOT AVAILABLE FOR FBLG & UFBLG)	18" X 24" X 12"	34
CUT1824146	CUTOUT, BOWL, FAUCET HOLES & WELDING/POLISHING (NOT AVAILABLE FOR FBLG & UFBLG)	18" X 24" X 14"	41
CUT2020086	CUTOUT, BOWL, FAUCET HOLES & WELDING/POLISHING (NOT AVAILABLE FOR FBLG & UFBLG)	20" X 20" X 8"	22
CUT2020126	CUTOUT, BOWL, FAUCET HOLES & WELDING/POLISHING (NOT AVAILABLE FOR FBLG & UFBLG)	20" X 20" X 12"	35
CUT2020146	CUTOUT, BOWL, FAUCET HOLES & WELDING/POLISHING (NOT AVAILABLE FOR FBLG & UFBLG)	20" X 20" X 14"	38
CUT2424126	CUTOUT, BOWL, FAUCET HOLES & WELDING/POLISHING (NOT AVAILABLE FOR FBLG & UFBLG)	24" X 24" X 12"	42
CUT2424146	CUTOUT, BOWL, FAUCET HOLES & WELDING/POLISHING (NOT AVAILABLE FOR FBLG & UFBLG)	24" X 24" X 14"	46

SOME UNITS SHIP UNASSEMBLED FOR REDUCED SHIPPING COST. ALL DIMENSIONS ARE TYPICAL. TOLERANCE +/- .500"

John Boos & Co. is constantly engaged in a program of improving products and therefore reserves the right to change specifications without prior notice.



Boos
locks

AQ AutoQuotes

3601 S. Banker St. • Effingham, IL 62401 • PO BOX 609 • quotes@johnboos.com

www.johnboos.com

020419

869