



**Redefining Healthcare Food Service**

With Alluserv you are not just buying a product. You are receiving our team's service commitment to get the most value from your investment in our products. We will provide you with:

- A team of knowledgeable experts with over 100 years of combined experience to help you understand and receive the most from your product throughout its service life
- Detailed instructions and specification on cleaning and application to best maintain your equipment
- A national service network and service manuals for our extensive product offering.

## CHOICE TRAY CART

### APPLICATION

The Alluserv tray delivery cart is designed for transportation of patient meals to decentralized locations. The all stainless construction cart features fixed tray sides, 5-1/4" tray spacing that accommodates two each 14"x18", 15"x20" or room service trays per side.

### CONSTRUCTION

The Alluserv tray cart has a 1" thick 18-gauge stainless steel tubular frame with welded, 18-gauge, pre-formed side panels/tray slides. Top, bottom and single panel door are 18-gauge stainless steel. Door has recessed door pull with a top mounted heavy-duty drop door latch. The door has a 270° swing.

Casters are 6" in diameter, with 2 fixed and 2 swivel with brakes, and are 2" rounded with soft tread to ensure a smooth and quiet ride for carpet or tile.

## Choice Tray Cart

### Model Numbers:

**TDC10, TDC12, TDC16, TDC20,  
TDC24, TDCPT10, TDCPT12,  
TDCPT16, TDCPT20, TDCPT24**



### Standard Features

- All stainless steel construction
- 6" casters, 2 with brakes
- 14"x18", 15"x20" trays & room service trays, 2 trays per slide
- Pull-type door with magnets & transport latch
- Small footprint

### Options

- Push handle (non pass thru only)
- Corner bumpers
- Wrap around bumpers
- Drains
- Top rails (for 16 capacity size and under)
- Tow hitch Package

### Warranty

- Two years parts and one year labor

# Choice Tray Cart

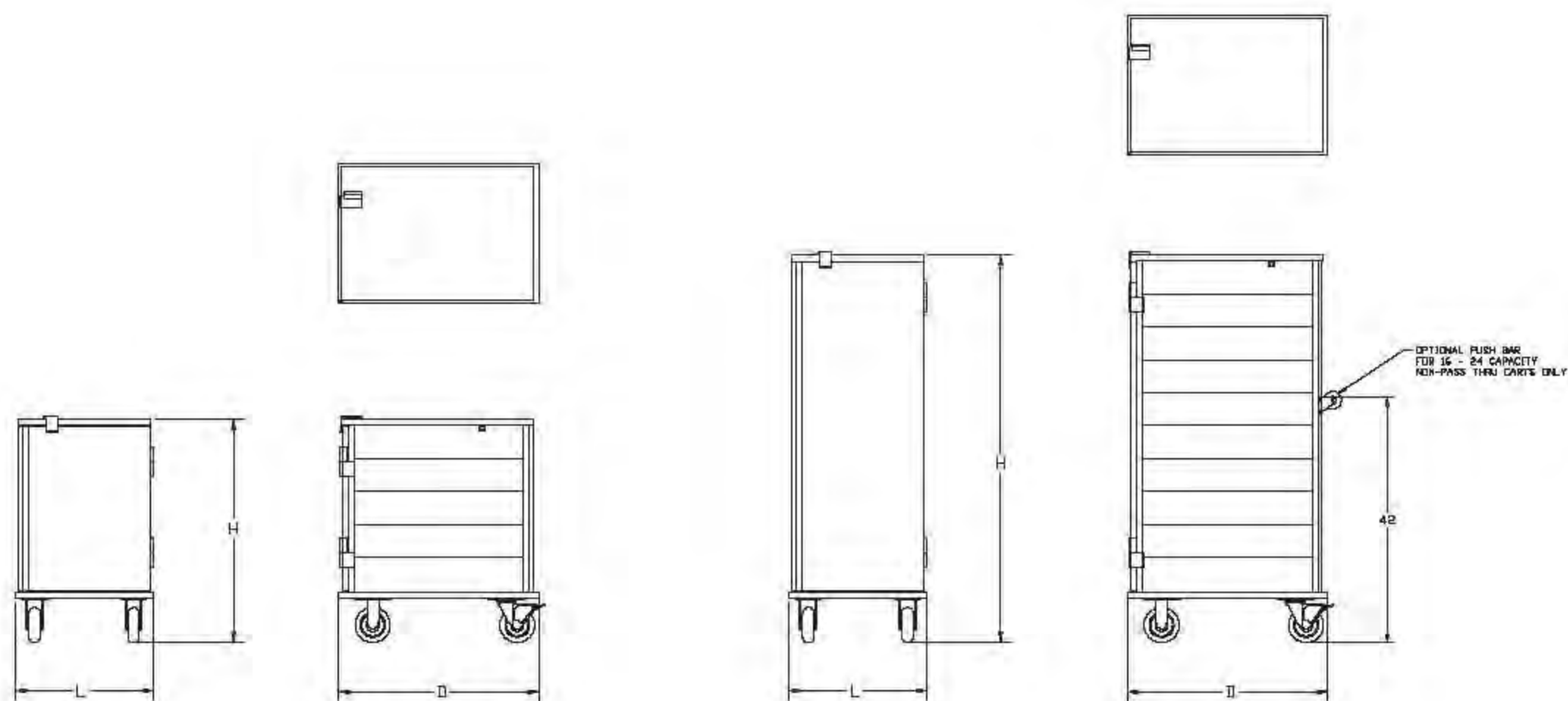

## DIMENSIONS

MODEL	CASE WEIGHT	PASS THRU MODEL	CASE WEIGHT	OVERALL SIZE			TRAY CAPACITY
				D	L	H	
TDC10	215	TDCPT10	220	34-7/32"	23-3/4"	37-1/8"	10
TDC12	235	TDCPT12	240	34-7/32"	23-3/4"	42-3/4"	12
TDC16	275	TDCPT16	285	34-1/4"	23-3/4"	54"	16
TDC20	295	TDCPT20	305	34-1/4"	23-3/4"	65-1/4"	20
TDC24	315	TDCPT24	325	34-1/4"	23-3/4"	76-1/2"	24



901 West 14th Street | Suite 200 | Washington, MO | 63090 | toll free 888-892-2213 | fax 636-239-8435 | alluserv.com